

FITTING INSTRUCTIONS

KIT AND DOOR SPECIFICATION					
Kit Short Code	Door Configuration	Max. Door Height	Max. Door Width	Max. Door Thickness	 kg
HRP2/1	2+1	3000mm	838mm	35-44mm	40kg

2+1 KIT CONTENTS

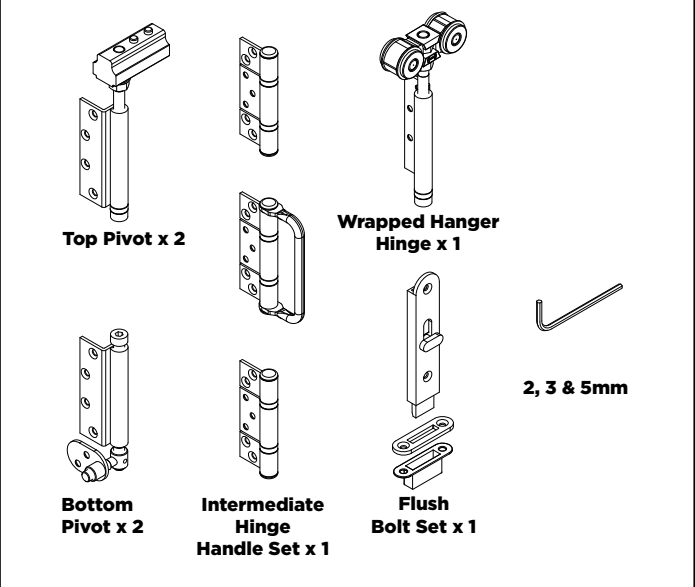

Top Pivot x 2

Bottom Pivot x 2

Intermediate Hinge Handle Set x 1

Wrapped Hanger Hinge x 1

Flush Bolt Set x 1
2, 3 & 5mm

TOOLS REQUIRED

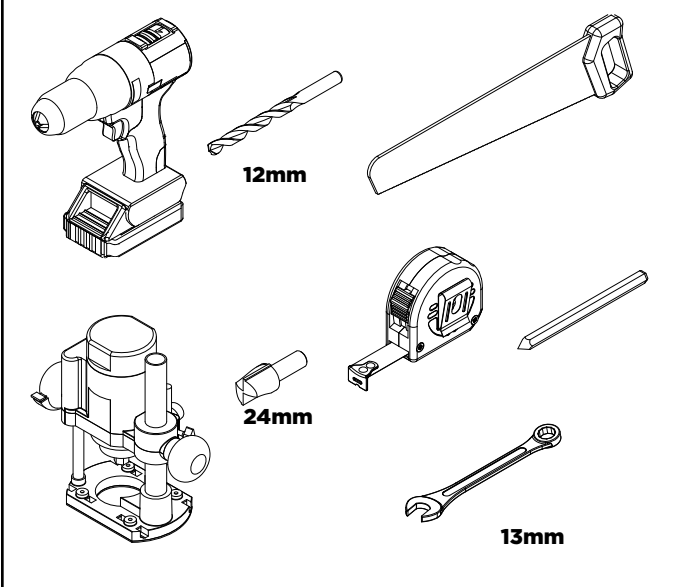

12mm

24mm

13mm

It is recommended that a light smear of general purpose grease is applied to all bolts prior to assembly.

SYSTEM OVERVIEW AND DOOR CONFIGURATIONS

Folding Direction



■ = Flush bolt

DIAGRAM 1

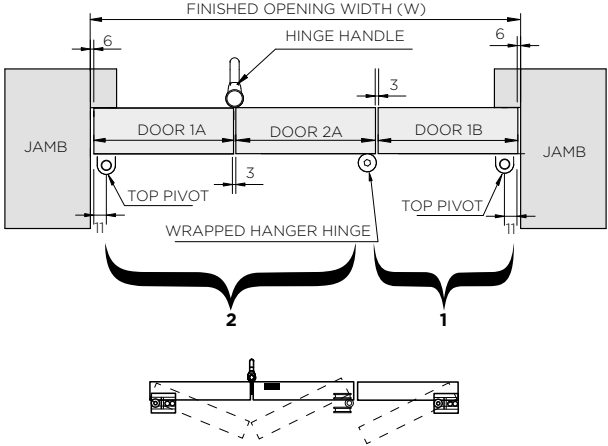

1

Figure 10 is a detailed sectional view of a shaft-hub assembly. The drawing shows a shaft with a keyway inserted into a hub. Key dimensions are labeled: a top flange with a width of 20 and a height of 37; a central shaft section with a diameter of 10; a bottom flange with a width of 20 and a height of 57; and a base with a thickness of 10. The distance from the top flange to the center of the shaft is 7, and from the center of the shaft to the bottom flange is 4. The total length of the assembly is indicated as DT+11. Two datum lines are shown: a green dashed line labeled 'CENTRE LINE' and a blue dashed line labeled 'DATUM LINE'. The distance from the center line to the datum line is labeled 'DT'. A dimension of 9 is shown for the distance from the datum line to the bottom flange, and a dimension of 6 is shown for the distance from the datum line to the base. The label 'DT-6' is at the top right, and 'DT+11' is at the bottom.

Diagram illustrating the components and dimensions of a window opening:

- Timber Upright:** The vertical structural member on the left side of the opening.
- Opening Width:** The horizontal dimension of the opening.
- Opening Height:** The vertical dimension of the opening.

OPENING WIDTH	OPENING HEIGHT
(DW x 3) + 18	DH+52

KEY	
DW	Door Width
DH	Door Height
DT	Door Thickness

2

3

4

5

2

6

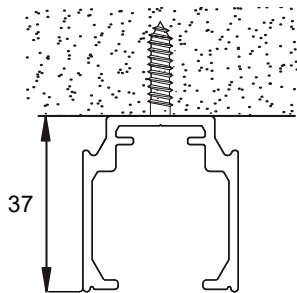
SECURE TRACK INTO PLACE.

Note: Fixings not provided. Ensure fixings can support system weight.

7

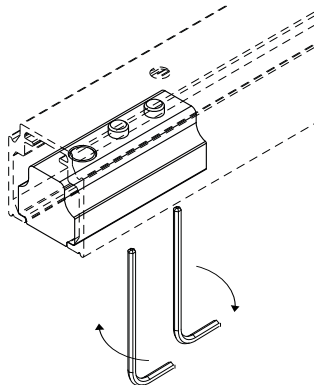
SLIDE PIVOT BLOCKS FLUSH TO FRAME. SECURE IN PLACE.

8

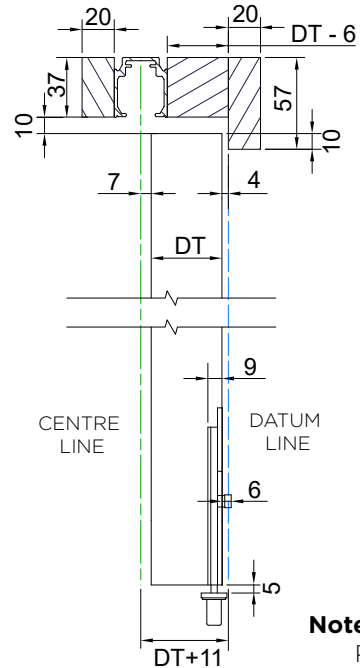
POSITION TIMBER HEADERS AS PER THE BELOW.

Note: Timber not Provided.

9

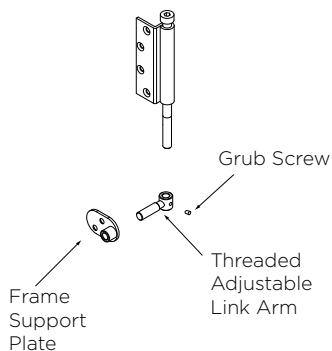
DISASSEMBLE BOTTOM PIVOT.

10

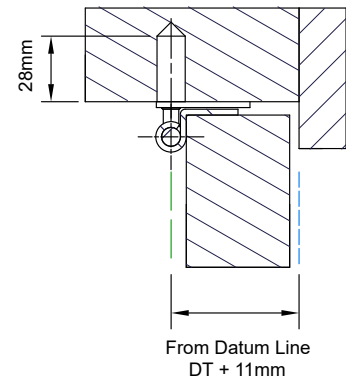
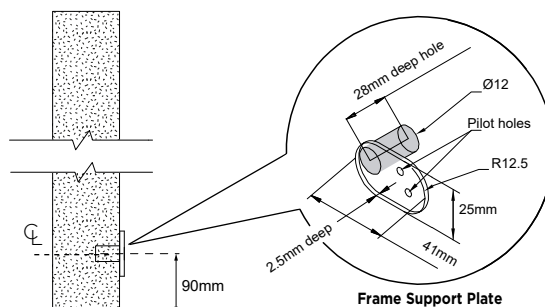
FIX FRAME SUPPORT PLATE TO FRAME ON PIVOT DOOR SIDE. MIRROR THIS STEP ON OTHER SIDE OF FRAME.

Note: Ensure 12mm diameter hole is inline with centre of

11

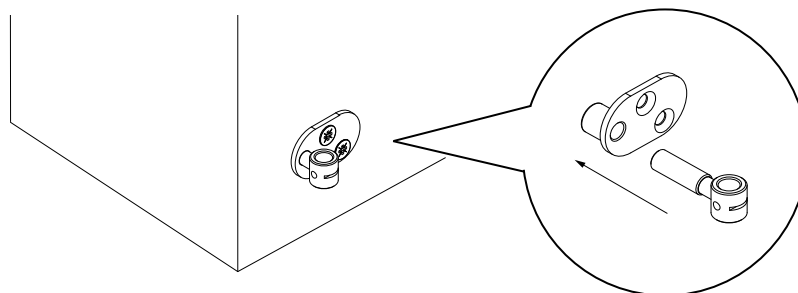
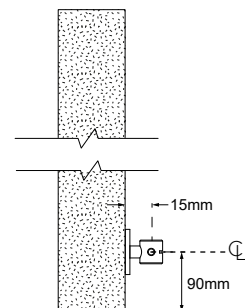
SCREW LINK ARMS INTO FRAME SUPPORT PLATES.**SIDE VIEW**

FLUSH PULL ROUTING DETAIL

12

ROUTE FLUSH BOLTS (SEE DIAGRAM 1 FOR LOCATION). SECURE FLUSH BOLTS USING 30MM SCREWS PROVIDED.

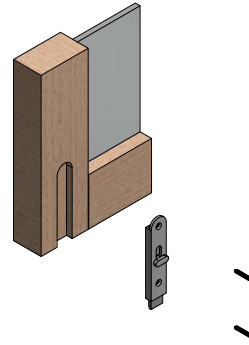
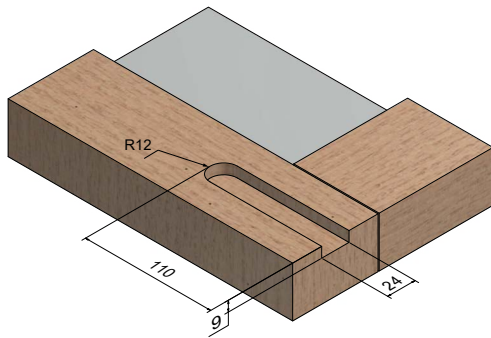

DOOR HINGES & OVERVIEW

13

DIAGRAM 4

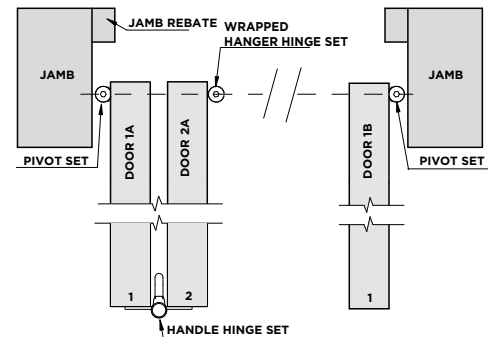
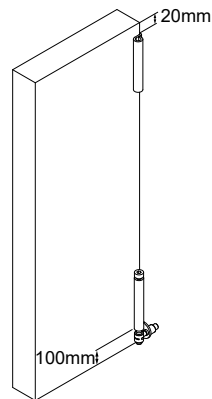
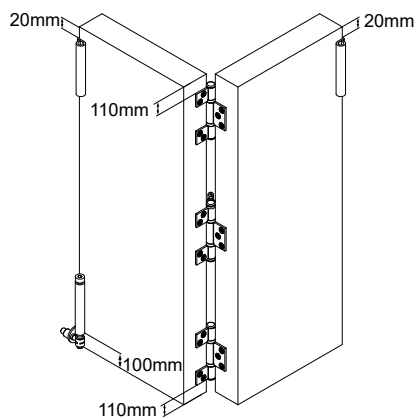

HANGING DOOR 1A & 1B

14

FIX TOP AND BOTTOM PIVOT HINGE TO DOOR 1A & 1B (SEE DIAGRAM 4 FOR LOCATION).

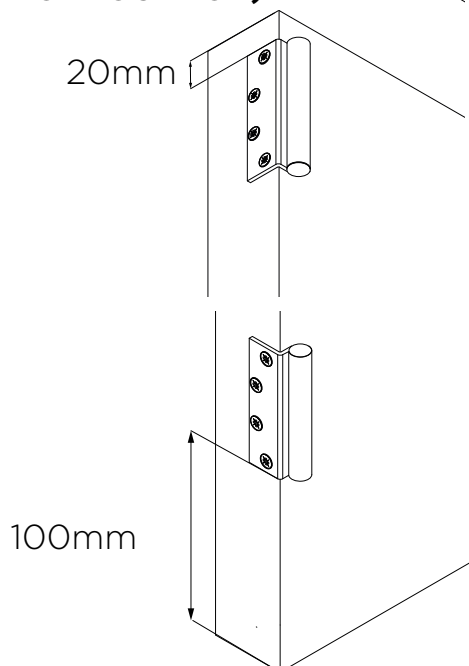

15

FIX HINGE TO DOOR 1A (SEE DIAGRAM 4 FOR LOCATION).

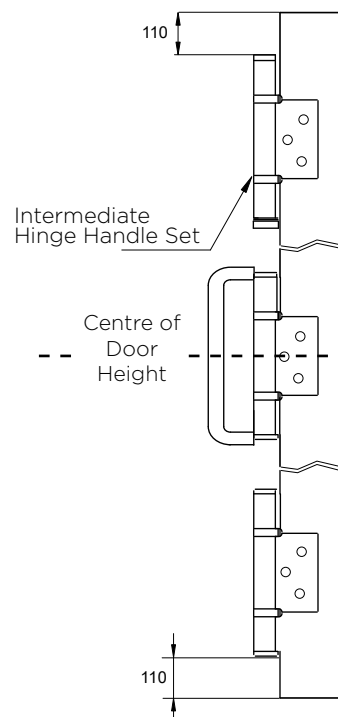

16

RAISE DOOR 1A & 1B 5MM FROM FLOOR. UNSCREW NUT, SLIDE STRAP BOLT THROUGH HINGE AND REATTACH NUT. TIGHTEN WITH 5MM ALLEN KEY.

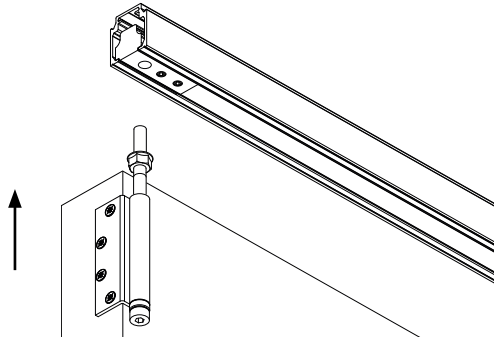
**17**

SLIDE STRAP BOLT THROUGH BOTTOM HINGE AND INTO LINK ARM. TIGHTEN WITH 5MM ALLEN KEY.

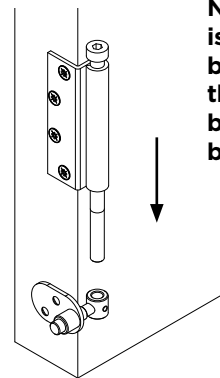

Note: Ensure there is a 2mm gap between the top of the hinge and the bottom of the strap bolt head.

HANGING DOOR 2A

18

RAISE DOOR 2A 5MM FROM FLOOR. CONNECT DOORS 1A AND 2A USING REMAINING HINGE LEAF.

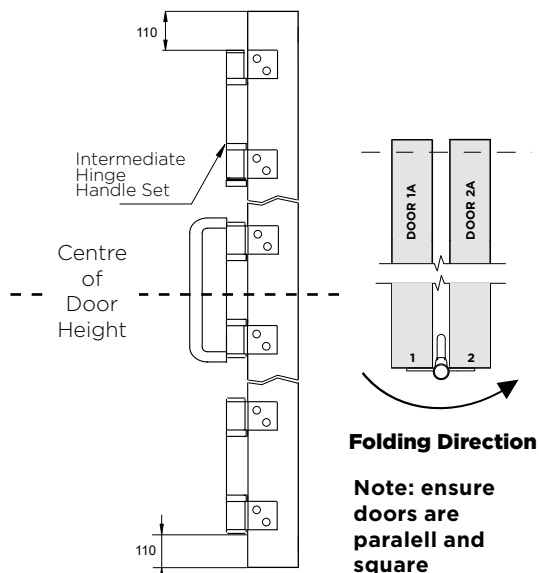
**19**

FIX END HANGER HINGE TO DOOR 2A (SEE DIAGRAM 4 FOR LOCATION).

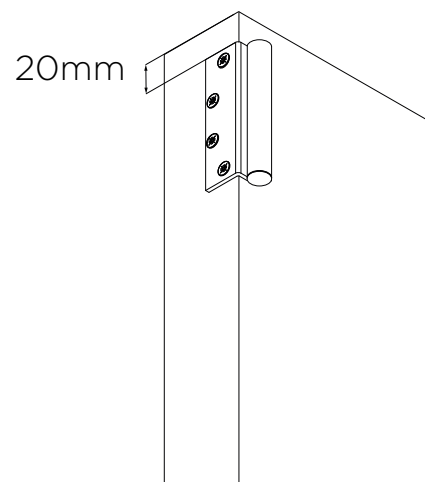
**20**

CONNECT HANGER BODY TO END HINGE ON DOOR 2A USING STRAP BOLT. TIGHTEN WITH 5MM ALLEN KEY.

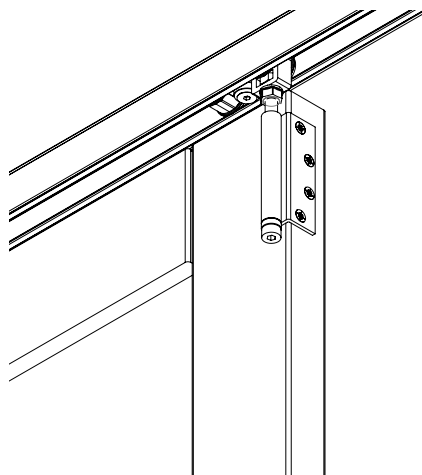

FITTING THE FLUSH BOLTS

21

CLOSE DOORS FLUSH. MARK POSITION OF FLUSH BOLT PIN ON FLOOR. OPEN DOORS. ROUTE FLOOR AREA. FIX FLUSH BOLT KEEP AND PLATE.

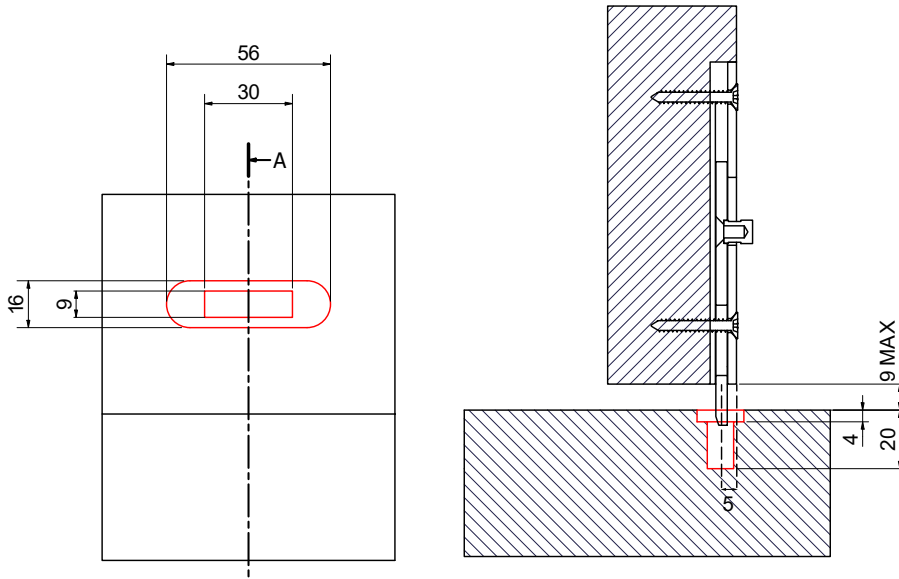

22

HEIGHT ADJUSTMENT. (+/-3MM)

Close all doors and adjust door height for an equal gap between top of door and bottom of track (9mm gap is recommended).

Use 13mm spanner to tighten.

23

INSERT AND TIGHTEN GRUB SCREW.

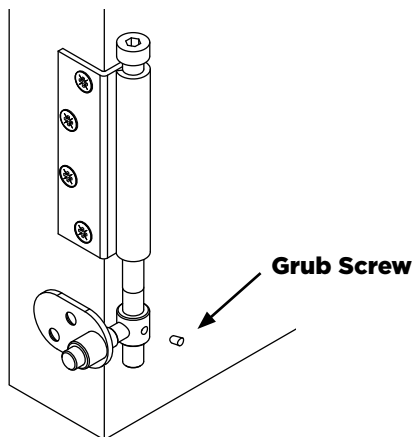

Ensure clearance between pivot door and frame is uniform.

24

CARE AND MAINTENANCE.

Keep track free from dirt and debris.

Periodically replace general purpose grease on bolts.

To prolong the appearance of exposed hinge parts, they can be periodically washed with soap and water.

Maintenance is required on all components including stainless steel to validate manufacturers

OPERATION INSTRUCTIONS

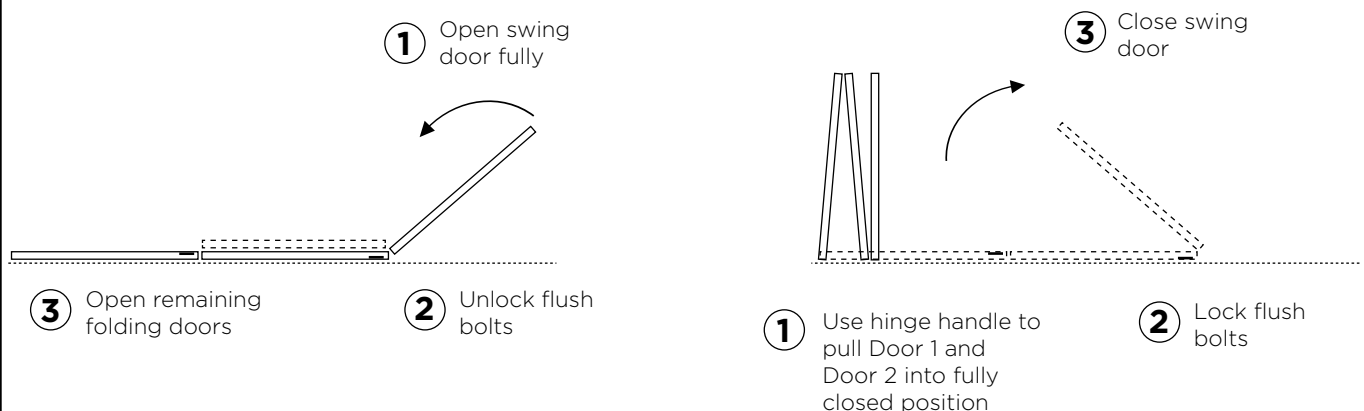

P C HENDERSON LTD
Durham Road, Bowburn,
Co. Durham,
DH6 5NG

UK SALES
t: +44 (0) 191 377 7345
e: sales@pchenderson.com
w: www.pchenderson.com

IRELAND SALES
t: +353 (0)1 643 6816
e: sales@pchenderson.ie
w: www.pchenderson.ie

INTERNATIONAL SALES
t: +44 (0) 191 377 7346
e: international@pchenderson.com
w: export.pchenderson.com

370970
REV 1
Aug-24