

FITTING INSTRUCTIONS

KIT AND DOOR SPECIFICATION

Product Code	Door Configuration	Max. Door Height	Max. Door Width	Max. Door Thickness	 kg
HRP2/2	2+2	3000mm	838mm	35-44mm	40kg

2+2 KIT CONTENTS

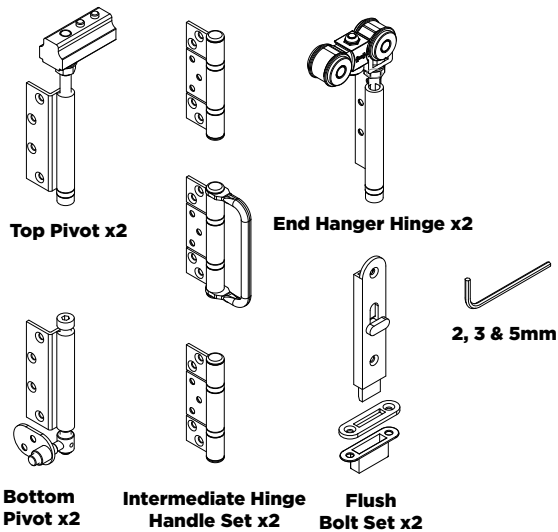

TOOLS REQUIRED

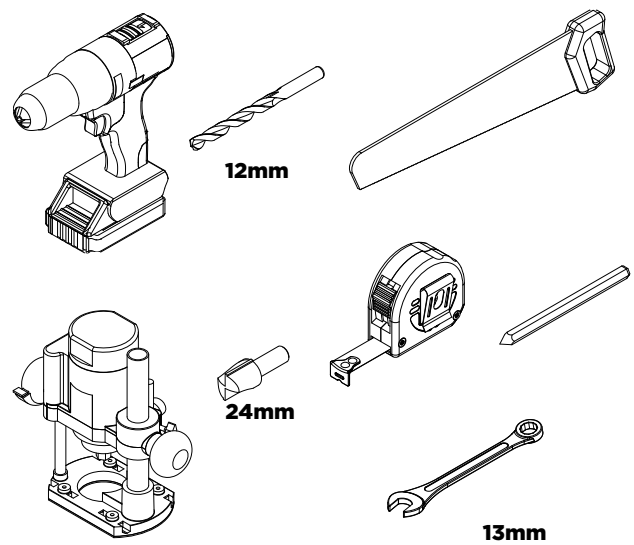

It is recommended that a light smear of general purpose grease is applied to all bolts prior to assembly.

SYSTEM OVERVIEW AND DOOR CONFIGURATIONS

DIAGRAM 1

Folding Direction



 = Flush bolt

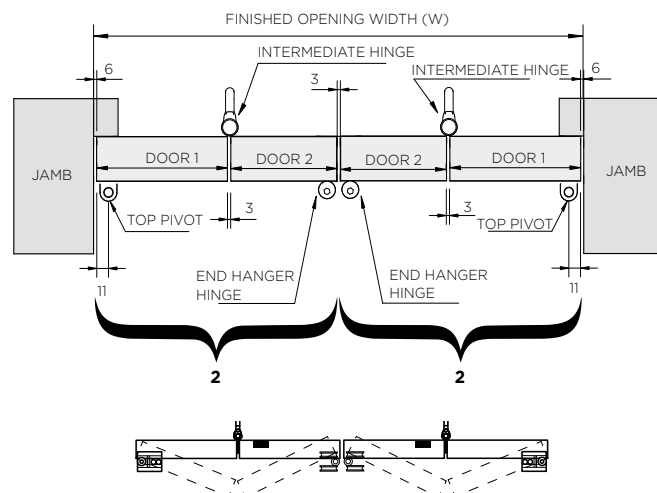

FRAME DIMENSIONS

1

Diagram 2 - Section View

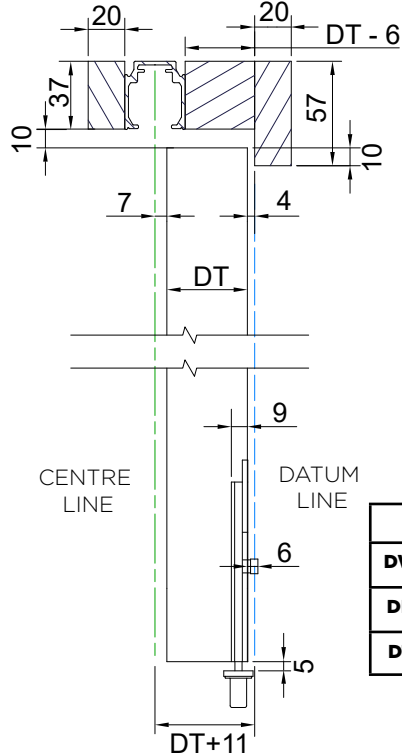

KEY	
DW	Door Width
DH	Door Height
DT	Door Thickness

Diagram 3 - Elevation View

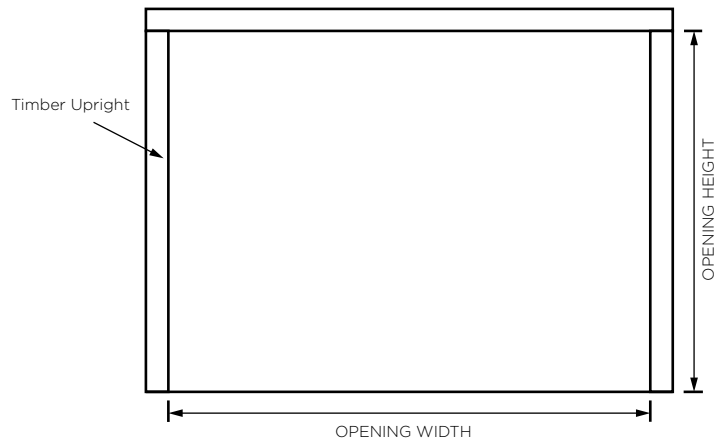

Table A - Opening Size Formula

OPENING WIDTH	OPENING HEIGHT
$(DW \times 4) + 21$	$DH + 52$

Note: Ensure opening is square, level and all load bearing areas are suitable for weight of system. Ensure there is sufficient strength in structure above the opening to take concentrated weight of doors when open. Roomflex 40 provides +/- 5mm of horizontal adjustment. Ensure doors are measured accurately prior to installation.

2

USING OPENING WIDTH SHOWN IN TABLE A, CUT TRACK TO REQUIRED LENGTH. ENSURE 5MM HOLE 50MM FROM END OF THE TRACK.

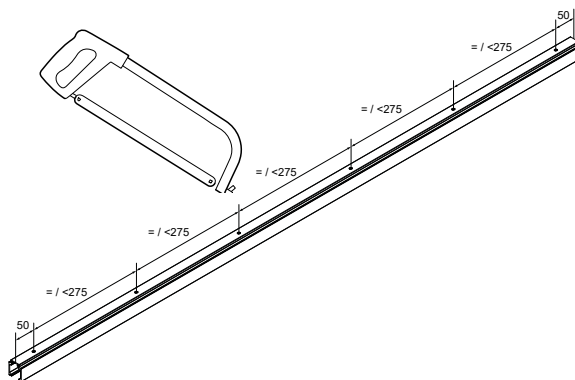

3

UNSCREW TOP PIVOT BLOCKS FROM TOP PIVOT.

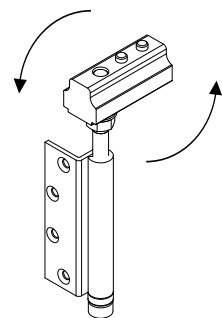

4

UNSCREW HANGER BODY FROM HANGER HINGE.

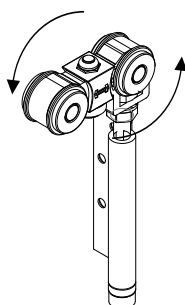

5

SLIDE PIVOT BLOCKS AND HANGERS INTO TRACK.

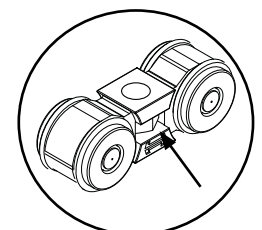
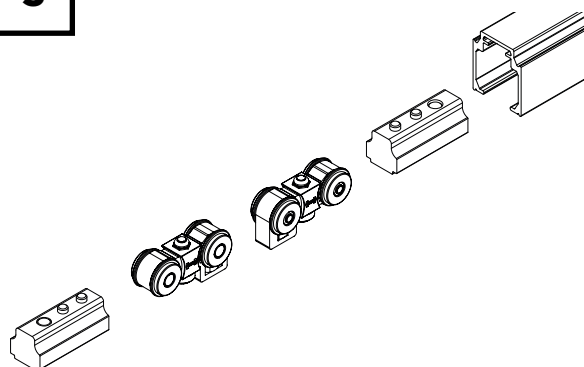

Note: Ensure M8 Nut in Place

6 SECURE TRACK INTO PLACE.

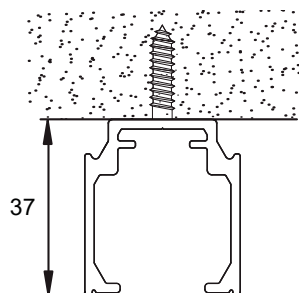

Note: Fixings not provided. Ensure fixings can support system weight.

7 SLIDE PIVOT BLOCKS FLUSH TO FRAME. SECURE IN PLACE.

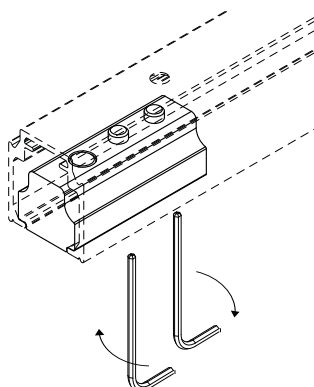

8 POSITION TIMBER HEADERS AS PER THE BELOW.

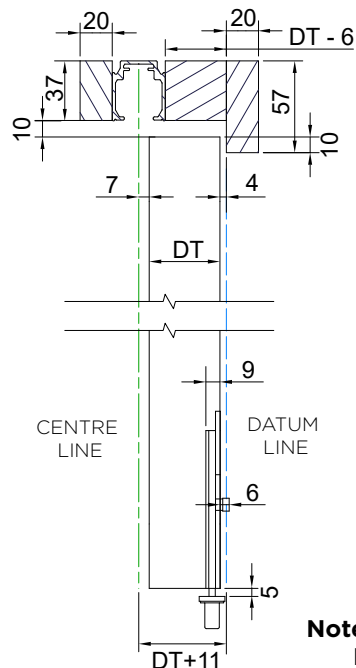

Note: Timber not Provided.

9 DISASSEMBLE BOTTOM PIVOT.

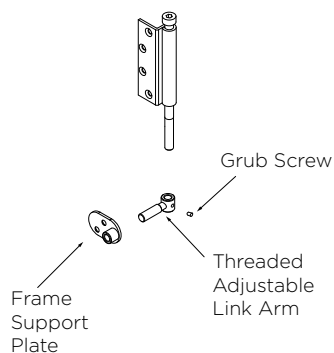

10 FIX FRAME SUPPORT PLATE TO FRAME ON PIVOT DOOR SIDE. MIRROR THIS STEP ON OTHER SIDE OF FRAME.

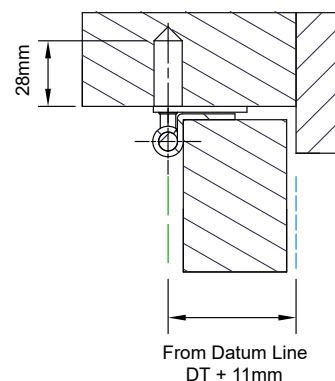
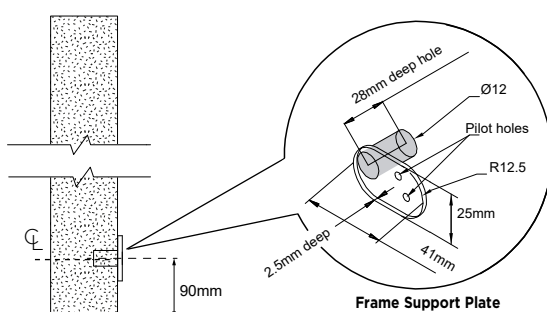

Note: Ensure 12mm diameter hole is inline with centre of track.

11 SCREW LINK ARMS INTO FRAME SUPPORT PLATES.

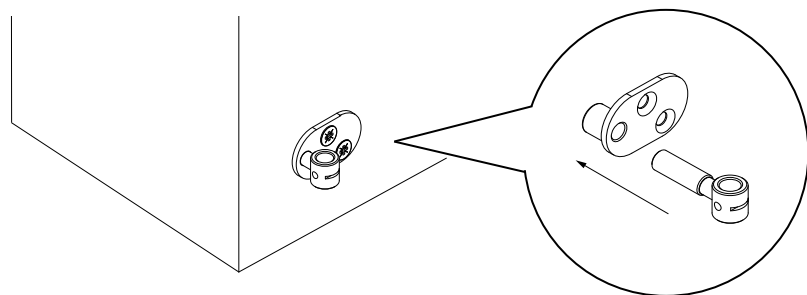

SIDE VIEW

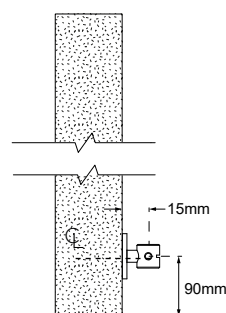

FLUSH BOLT ROUTING DETAIL

12

ROUTE FLUSH BOLTS (SEE DIAGRAM 1 FOR LOCATION). SECURE FLUSH BOLTS USING 30MM SCREWS PROVIDED.

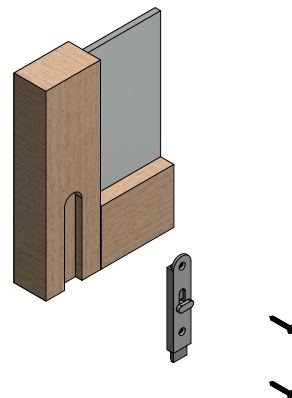
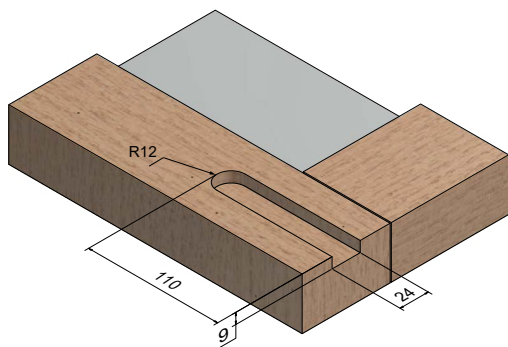

DOORS AND HINGES OVERVIEW

13

DIAGRAM 4

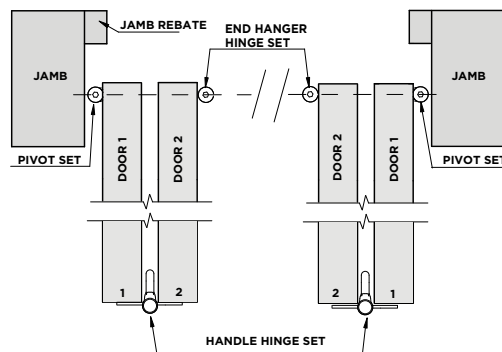
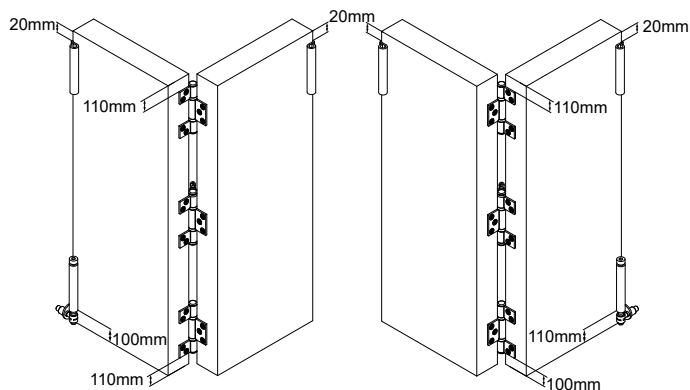

HANGING DOOR 1

14

FIX TOP AND BOTTOM PIVOT HINGE TO DOOR 1 (SEE DIAGRAM 4 FOR LOCATION).

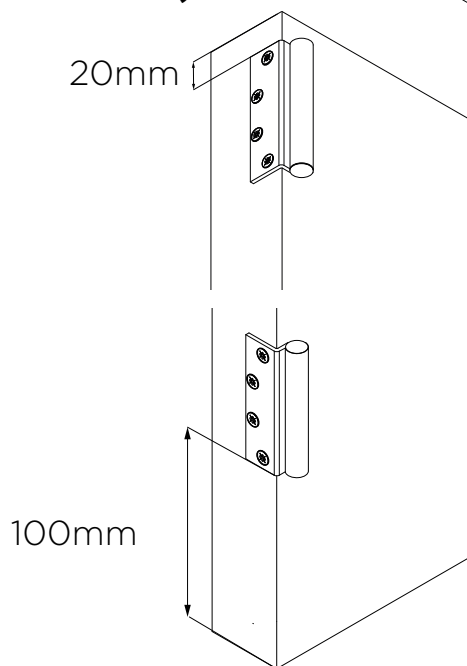

15

FIX HINGE TO DOOR 1 (SEE DIAGRAM 4 FOR LOCATION).

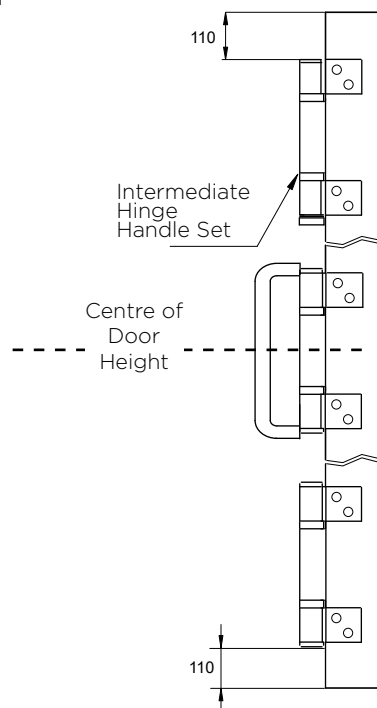

16

RAISE DOOR 1: 5MM FROM FLOOR. UNSCREW NUT, SLIDE STRAP BOLT THROUGH HINGE AND REATTACH NUT. TIGHTEN WITH 5MM ALLEN KEY.

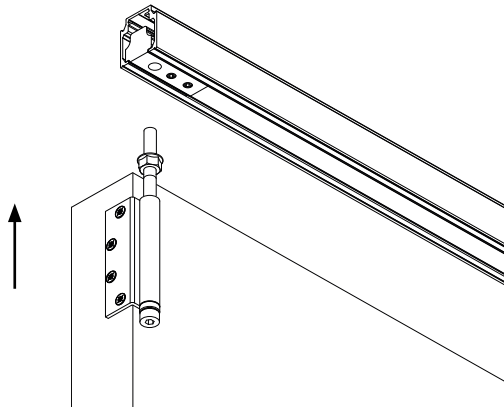

Please ensure doors are parallel and square

17

SLIDE STRAP BOLT THROUGH BOTTOM HINGE AND INTO LINK ARM. TIGHTEN WITH 5MM ALLEN KEY.

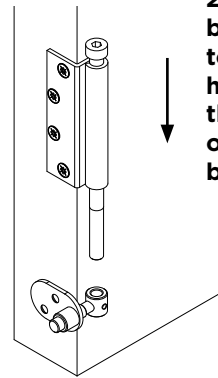

Note: Ensure there is a 2mm gap between the top of the hinge and the bottom of the strap bolt head.

HANGING DOOR 2

18

RAISE DOOR 2 5MM FROM FLOOR. CONNECT DOORS 1 AND 2 USING REMAINING HINGE LEAF.

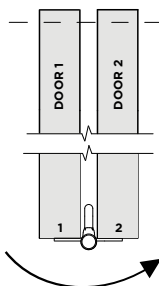
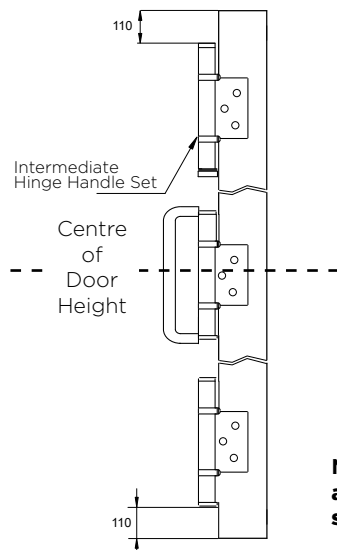

Folding Direction

Note: ensure doors are parallel and square

19

FIX END HANGER HINGE TO DOOR 2 (SEE DIAGRAM 4 FOR LOCATION).

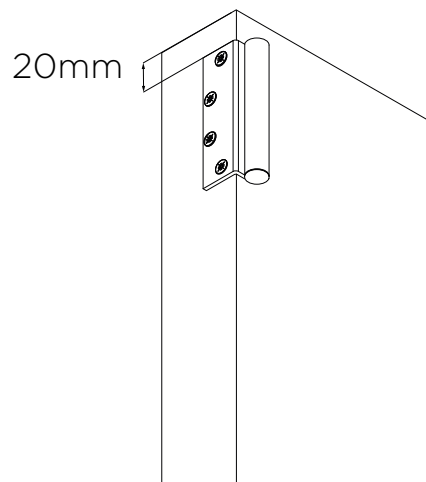
**20**

CONNECT HANGER BODY TO END HINGE ON DOOR 2 USING STRAP BOLT. TIGHTEN WITH 5MM ALLEN KEY.

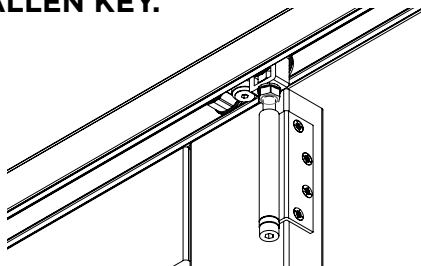

FITTING THE FLUSH BOLTS

21

CLOSE DOORS FLUSH. MARK POSITION OF FLUSH BOLT PIN ON FLOOR. OPEN DOORS. ROUTE FLOOR AREA. FIX FLUSH BOLT KEEP AND PLATE.

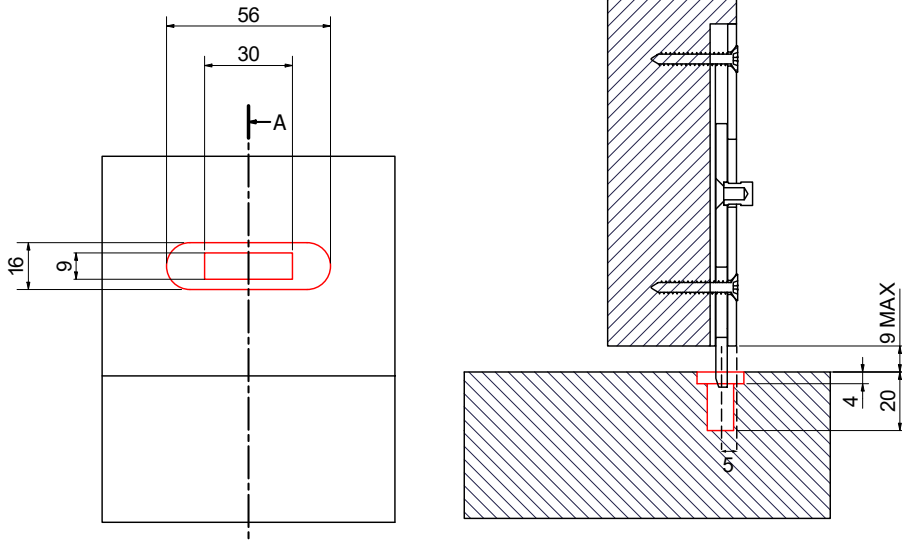

22

**HEIGHT ADJUSTMENT.
(+/-3MM)**

Close all doors and adjust door height for an equal gap between top of door and bottom of track (9mm gap is recommended).

Use 13mm spanner to tighten.

23

INSERT AND TIGHTEN GRUB SCREW.

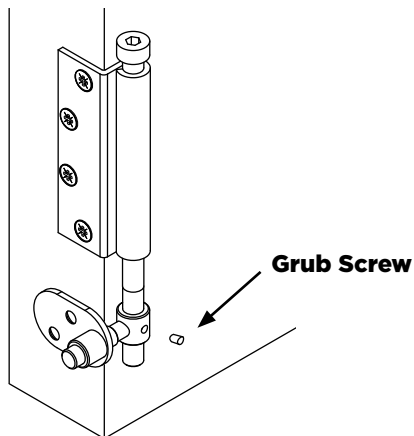

Ensure clearance between pivot door and frame is uniform.

24

CARE AND MAINTENANCE.

Keep track free from dirt and debris.

Periodically replace general purpose grease on bolts.

To prolong the appearance of exposed hinge parts, they can be periodically washed with soap and water.

Maintenance is required on all components including stainless steel to validate manufacturers

OPERATION INSTRUCTIONS

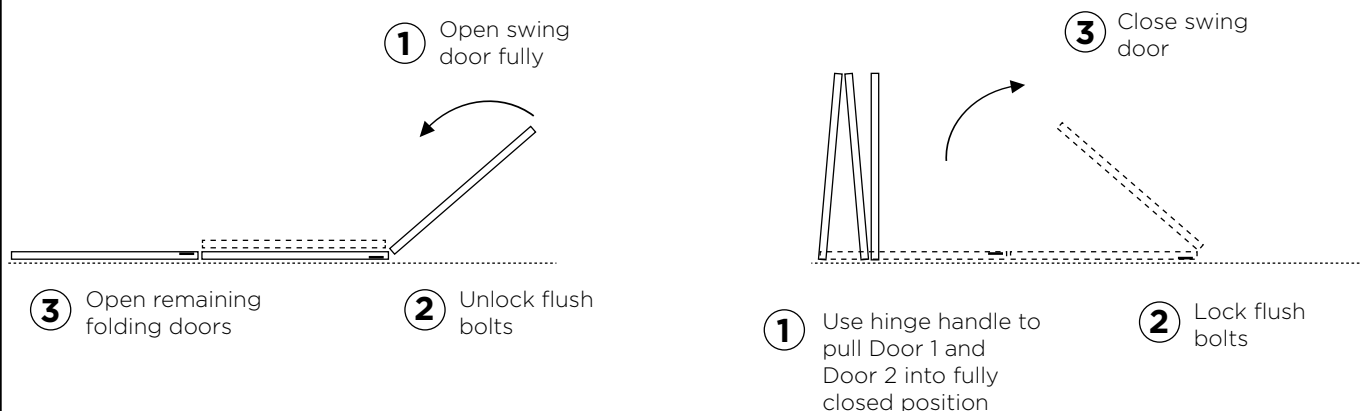

P C HENDERSON LTD
Durham Road, Bowburn,
Co. Durham,
DH6 5NG

UK SALES
t: +44 (0) 191 377 7345
e: sales@pchenderson.com
w: www.pchenderson.com

IRELAND SALES
t: +353 (0)1 643 6816
e: sales@pchenderson.ie
w: www.pchenderson.ie

INTERNATIONAL SALES
t: +44 (0) 191 377 7346
e: international@pchenderson.com
w: export.pchenderson.com

370971
REV 1
Aug-24