

RUSTIC SOFT CLOSE HENDERSON

Fitting Instructions

Kit	Max. Door Weight	Min. Door Width
R80SOFT	80kg	762mm

KIT CONTENTS

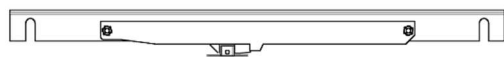

Damper & Plate



Trigger

NOTE: Installation of Rustic Soft Close should be completed after fitting the main system. These instructions show the Soft Close being installed onto the Rustic 100 system but can also be applied to the Rustic Top Mount. The instructions show the Soft Close installed to the left side of the system when facing the track. Rustic Soft Close can be installed onto the left or right hand side of the track – or both for a soft close and open.

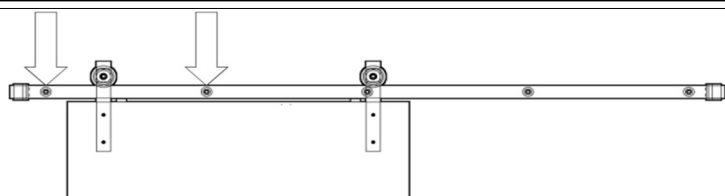

Soft Close goes over end track fixings.
Disengage anti-jump before removing door.

STEP BY STEP INSTRUCTIONS

STEP 1: Measure X - the distance from the door edge in the closed position to the first hole of the track.

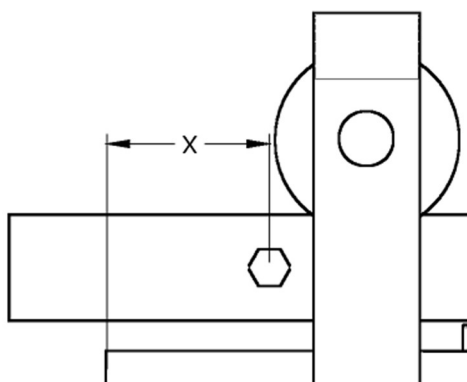

STEP 2: Remove the door and door stop from the track.

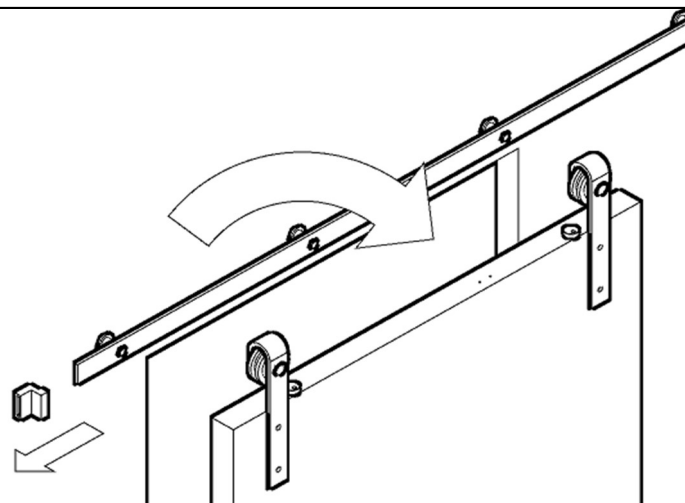

STEP 3: Drill pilot holes for the trigger in the position below (X is taken from **STEP 1**).

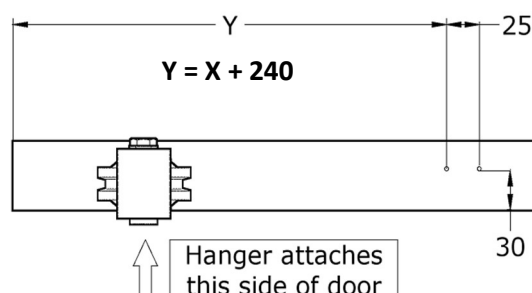

STEP 4: Install the Soft Close in correct orientation.
(Illustrated from the rear, soft close can easily be unscrewed and reversed to get correct orientation).



A: Right



B: Left

STEP 5: Loosen end two fixings. Slot Soft Close onto standoffs.

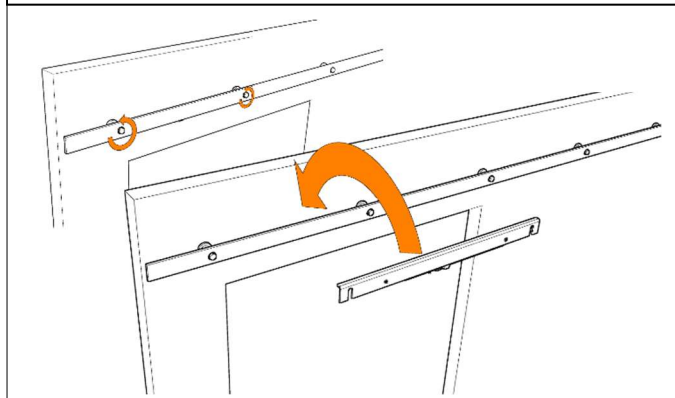

STEP 6: The Soft Close sits behind the track. Tighten the two fixings.

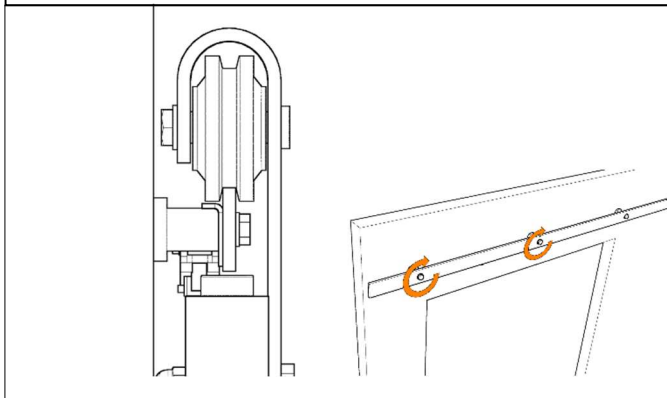

STEP 7: Loosely install the trigger on top of the door pushing it as far forward as possible.

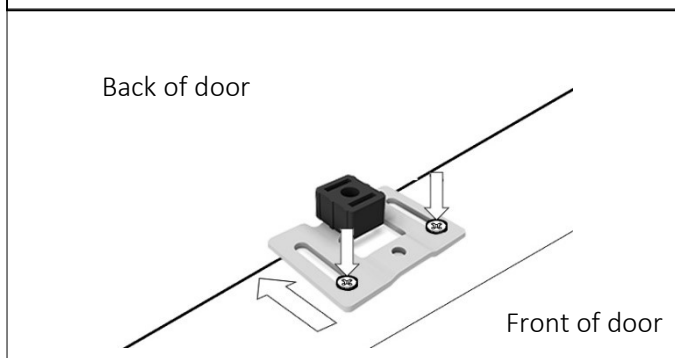

STEP 8: Hang the door back on the track, ensuring the floor guide is engaged.

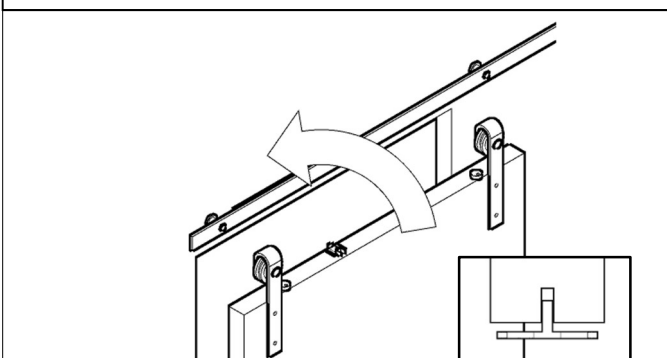

STEP 9: Adjust the trigger into the final position and tighten the screws.

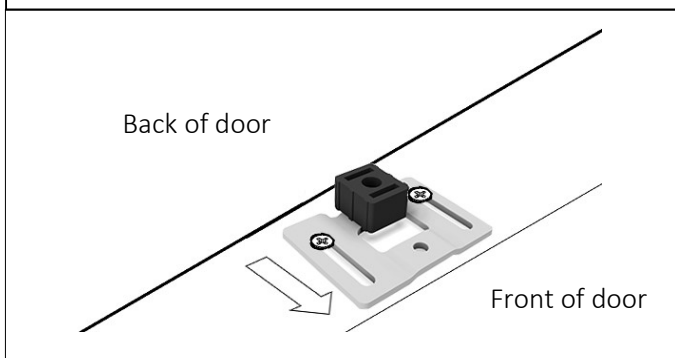

STEP 10: Open the jaws of the Soft Close as far as possible

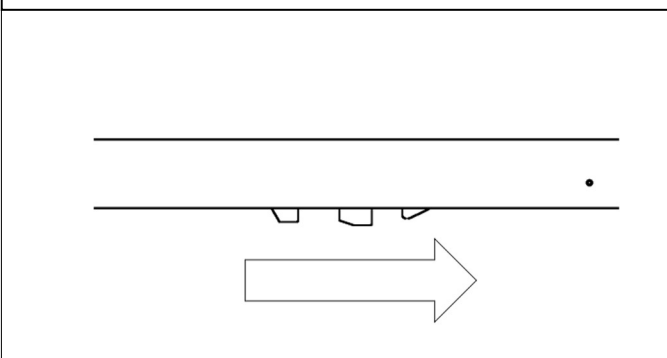

STEP 11: Check the engagement of the trigger with the Soft Close jaws. Adjust the trigger height as necessary.

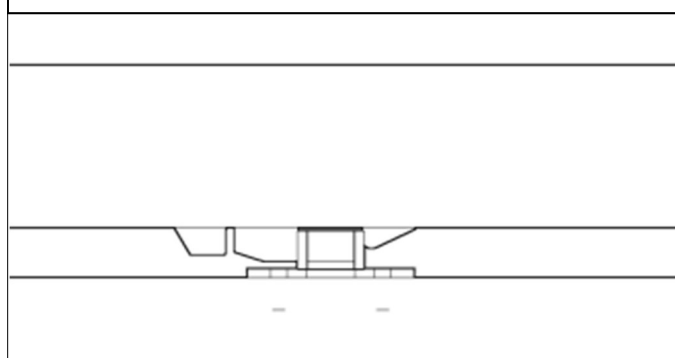

STEP 12: Check the anti-jump cams are engaged. Replace the door stop to the ends of the track.

