

EVOLVE

POCKET DOOR PRO

HENDERSON

80kg

Wood

Interior

Automated

Automated sliding system for wooden pocket doors weighing up to 80kg

Overview

Evolve Pocket Door Pro is a professional sliding door solution that allows the door to slide into a cavity wall. Designed with a high quality, aluminium cavity frame, the system is extremely robust. Catering for residential and light commercial applications, the system is ideal for rooms where space is limited such as bathrooms, ensuites or kitchens as well as being used to improve mobility access.

Suitable for 120mm or 125mm finished wall thickness - the system is extremely versatile. Sliding doors can open at the push of a button, remote control or by activation of a movement sensor - offering the utmost in sophistication and convenience.

For bi-parting automated pocket door, two kits can be used.

Features and Benefits



- Fully automated pocket door system
- Doors open via control switch, remote control or motion sensor
- Robust aluminium cavity frame, designed for rapid installation
- Kit can be used with or without an architrave
- Available for 120mm or 125mm finished wall thickness
- For bi-parting automated doors, two kits can be used
- Liner kit available as an optional extra for a professional finish



Product and Door Specification

Kit Order Code	Max. Door Width	Max. Door Height	Door Thickness Range	Max. Door Weight
EVOPRO10/**	930mm	2315mm	35 - 44mm	80kg

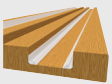
**For full short code please replace with required finished wall thickness - 120 or 125 (mm)

Kit Contents		Drive Unit Specification		Accessories			
Aluminium Track (x1)	Screws	Operation Voltage:	24V safety – low voltage via external power unit	Liner Kit	Full timber liner kit for a professional finish	LK10/***(for use with EVOPRO10)	
Aluminium Upright (x4)	Tie Back & Fixing Block (x4)	Maximum Operating Speed:	Door weight dependent: Up to 80kg - 20cm/s max. Up to 60kg - 23cm/s max. Up to 40kg - 26cm/s max.	Remote Control	Includes a single channel remote control & one wireless receiver control panel	E2/RCK	
Hangers (x2)	Motor (1.5m cable length)	Running Performance:	Soft start and stop	Radar Motion Sensor	Available in black, white or aluminium	ER/B, ER/W or ER/S	
Floor Guide (x1)	Toothed Belt	Safety Function:	Includes obstacle detection in both directions	*** For full short code, please replace with required finished wall thickness - 120 or 125 (mm).			
Fixing Plate (x4)	Belt Clamp	Configurable Options:	Push and go, closing speed and auto c losing delay timer - can all be configured to user preference				
Header Fixing Bracket (x8)	Tension Wheel						
Door Stop (x1)	24V Transformer						
Noggin c/w Fixing Vlock (x4)	Wall Mounted Control Panels (x2)						
Floor Bracket (x4)							

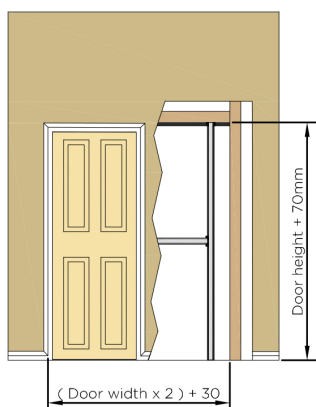

Finished Wall Thickness Calculation

120mm Finished Wall Thickness

95mm cavity + 12.5mm plasterboard either side = 120mm finished wall thickness

125mm Finished Wall Thickness

100mm cavity + 12.5mm plasterboard either side = 125mm finished wall thickness

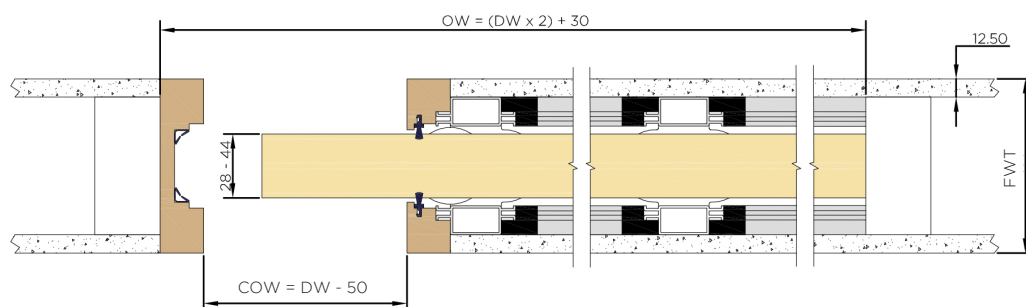
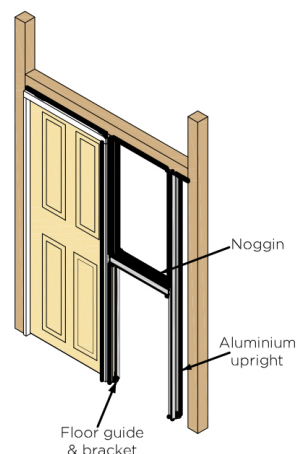
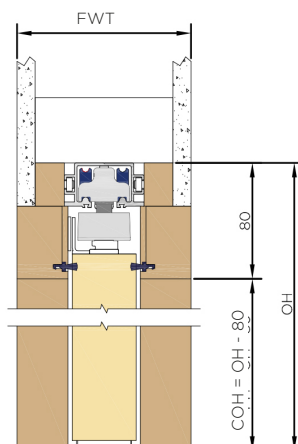
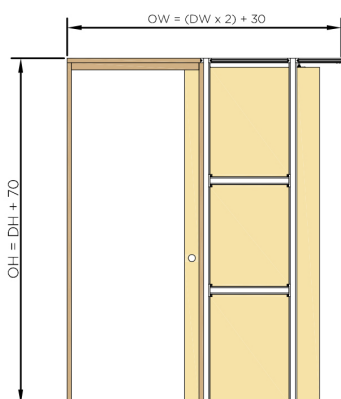
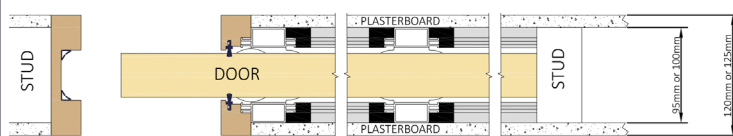

Key

OW	Overall width
OH	Overall height
DH	Door height
DW	Door width
COH	Clear opening height
COW	Clear opening width
FWT	Finished wall thickness

Opening Size Guide

Kit Short Code	Max. Passage Width (W x H)	Overall Dimensions (W x H)	Cavity Thickness	Finished Wall Thickness (WT)
EVOPRO10/**	880mm x 2305mm	1890mm x 2385mm	95mm or 100mm	120mm or 125mm

For further information, please contact us on:

UK Sales

T: +44 (0) 191 377 7345

E: sales@pchenderson.com

W: www.pchenderson.com

Export Sales

T: +44 (0) 191 377 7346

E: international@pchenderson.com

W: export.pchenderson.com