

Evolve Pocket Door Pro

Automated sliding system for pocket doors weighing up to 80kg



Evolve Pocket Door Pro is a professional hardware solution that allows doors to automatically slide into a cavity wall. Catering for wooden doors weighing up to 80kg in residential or light commercial applications, the system is ideal for rooms where space is limited such as bathrooms, en-suites or kitchens as well as improving mobility access.

The system comes with wall mounted control panels as standard. Alternatively, the doors can also be opened by remote control or activation of a movement sensor - see our optional accessories for more details.

Evolve Pocket Door Pro has been designed with the installer in mind to make installation and maintenance of the system as easy as possible. The high-quality aluminium cavity frame comes with push together parts for rapid installation.

The system is available in kit pack format, which can be cut to size, and caters for a finished wall thickness of 120mm or 125mm. For bi-parting doors, two kits should be purchased. For a professional finish, a liner kit is available for both single or bi-parting door applications as an optional extra.

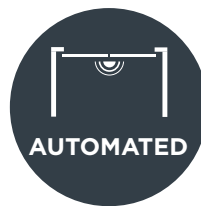

Product Specification

Product Code	Track Length	Max. Door Width	Max. Door Height	Door Thickness	Max. Weight	Finished Wall Thickness
EVOPRO10	1890mm	930mm	2315mm	35 - 44mm	80kg	120mm or 125mm

Optional Liner Kit

Product Code		Max. Door Thickness	Finished Wall Thickness
Single Doors	Bi-parting Doors		
LK/120	BILK/120	45mm	120mm
LK/125	BILK/125	45mm	125mm

Optional Accessories

Component	Product Code
Remote Control Kit	(E2/RCK)
Radar Motion Sensor	(ER/*)

*Available in black (ER/B), white (ER/W) or aluminium (ER/S)

Kit Contents

Component	Quantity
Aluminium Track	1
Aluminium Uprights	4
Hangers	2
Floor Guide	1
Fixing Plate	4
Header Fixing Bracket	8
Door Stop	1
Noggin c/w Fixing Block	4
Floor Bracket	4
Tie Back & Fixing Block	4
Motor	-
Toothed Belt, Clamp & Tension Wheel	-
24V Transformer	-
Wall Mounted Control Panels	2

Drive Unit Specification

Specification	Detail
Operation Voltage:	24V safety - low voltage via external power unit
Maximum Operating Speed (door weight dependent)	Up to 80kg - 20cm/s max speed Up to 60kg - 23cm/s max. speed Up to 40kg - 26cm/s max. speed
Running Performance:	Soft start and stop
Safety Function:	Includes obstacle detection in both directions
Configurable Options:	Push and go, closing speed, auto closing delay timer can all be configured to user preference

Product Diagrams

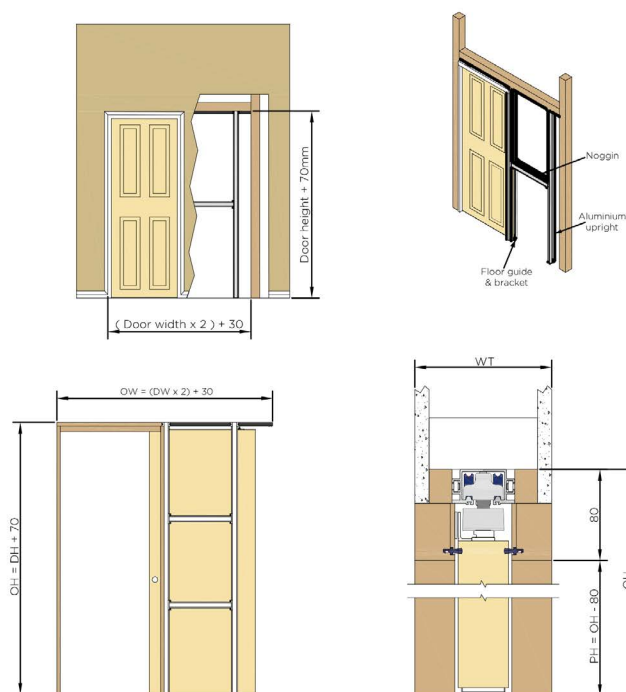

Key

OW	Overall width
OH	Overall height
DH	Door height
DW	Door width
PH	Passage height
PW	Passage width
WT	Finished wall thickness

For Bi-Parting Doors

$$PW = (2 \times DW) - 50$$

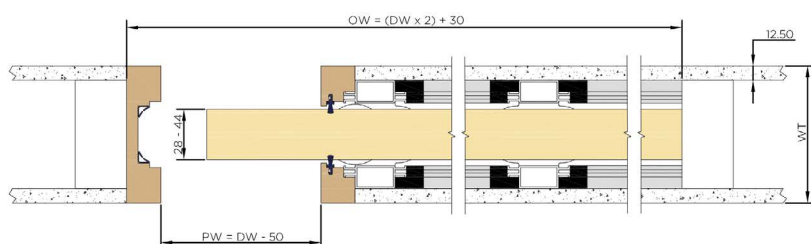

Finished Wall Thickness Calculation

120mm Finished Wall Thickness - 95mm cavity + 12.5mm plasterboard either side = 120mm finished wall thickness

125mm Finished Wall Thickness - 100mm cavity + 12.5mm plasterboard either side = 125mm finished wall thickness

Opening Size Guide

Kit	Max. Passage Width (W x H)	Overall Dimensions (W x H)	Cavity Thickness	Finished Wall Thickness (FWT)
EVOPRO10	880mm x 2305mm	1890mm x 2385mm	95mm or 100mm	120mm or 125mm