

FITTING INSTRUCTIONS – NOTICE DE POSE – MONTAGE HANDLEIDING – MONTAGEANLEITUNG ISTRUZIONI DI MONTAGGIO – INSTRUCCIONES DE MONTAJE

Warranty. This product is covered by a 10 year manufacturer's warranty. Please see the P C Henderson website for terms and conditions.

WATCH THE INSTALLATION VIDEO

Visit: www.pchenderson.com/soltaire-installation

Or scan the QR code using your phone



System Specification

Maximum Panel Weight = 120kg
Minimum Panel Thickness = 24mm

Maximum Panel Thickness = 48mm
Maximum Panel Height = 3000mm

Tools required



1 x Phillips screwdriver

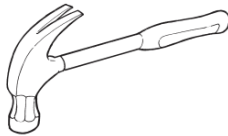

1 x Hammer

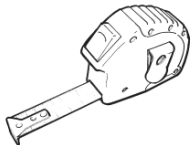

1 x Tape measure



1 x 13mm spanner

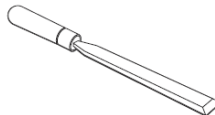

1 x Chisel

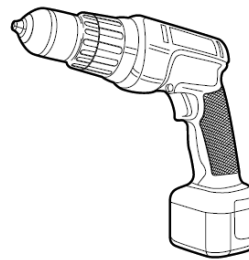

1 x Drill

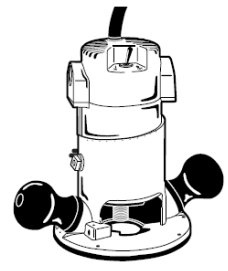

1 x Router

Kit Contents

120 Track – 2M

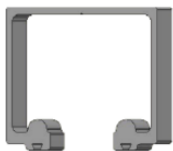

2 x 51/120/SS
Hanger + fixing
screws

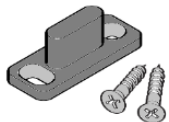

1 x Floor Guide

2 x Flush Pulls

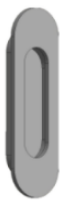

2 x Track
stops

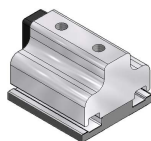

4 x Face Fix
Brackets

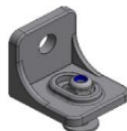

Interior Kit

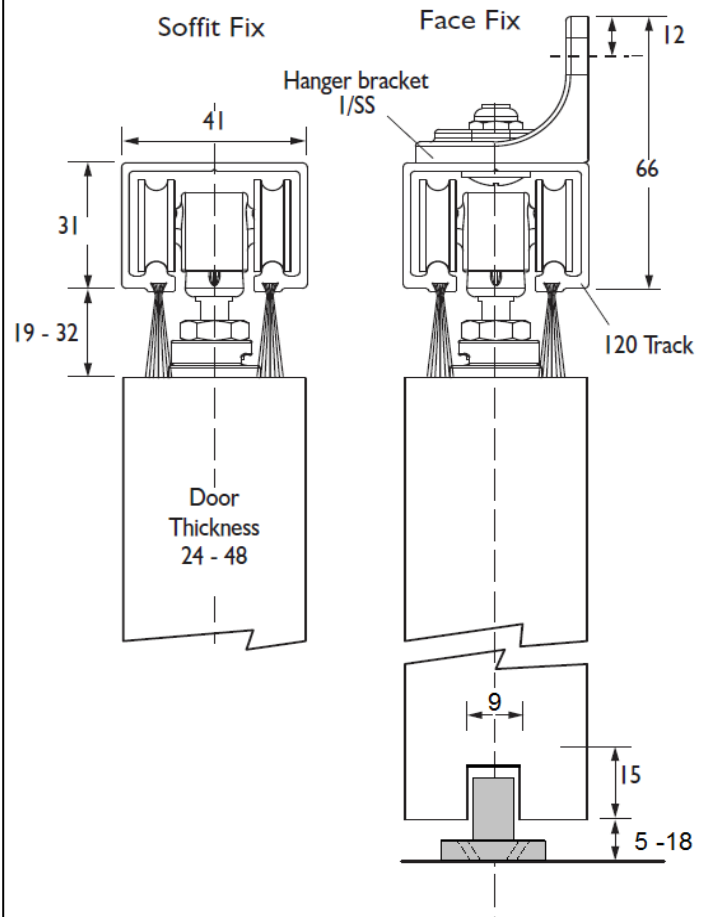

PCH Suggested Layout/Door Height

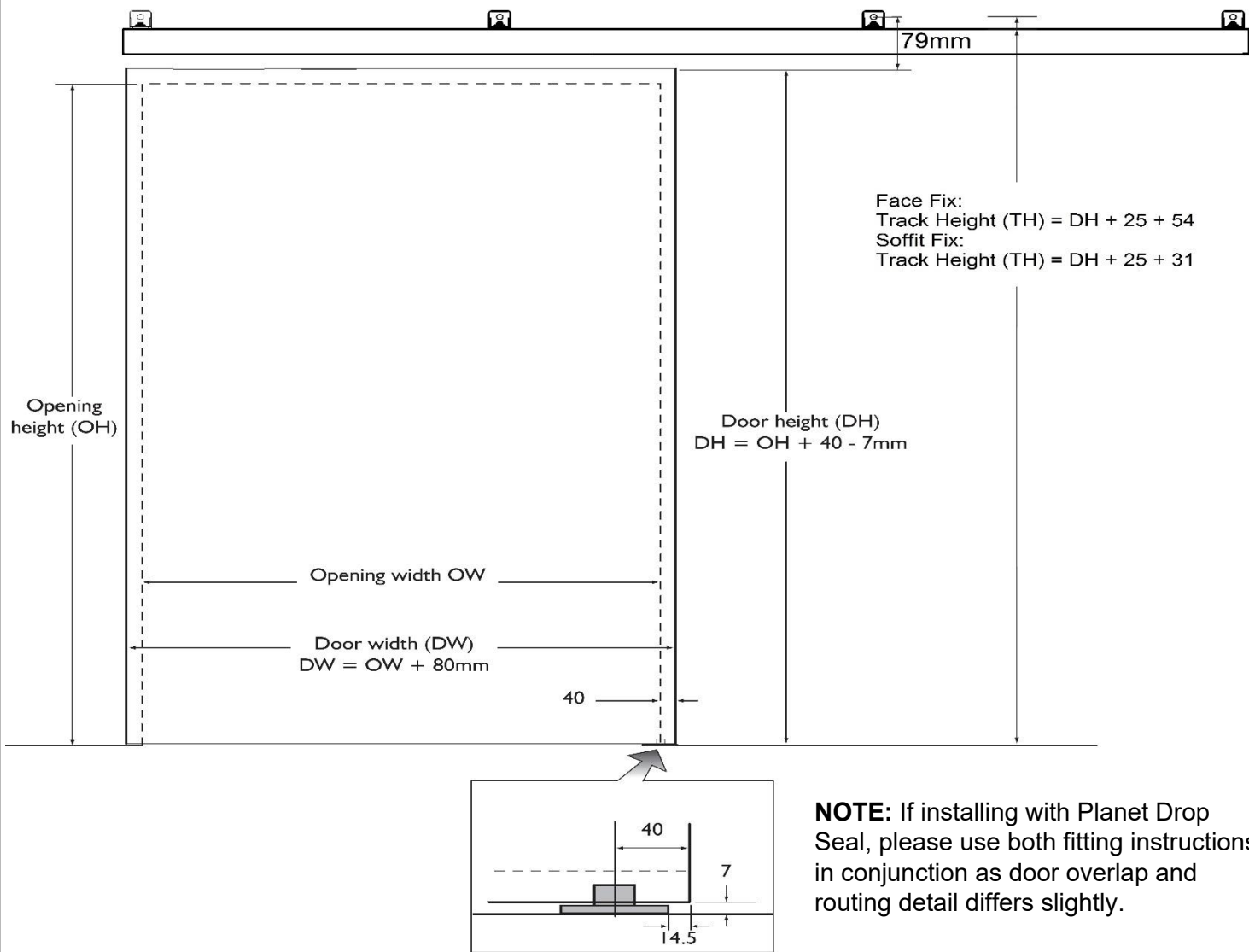

1. Fit Apron plate

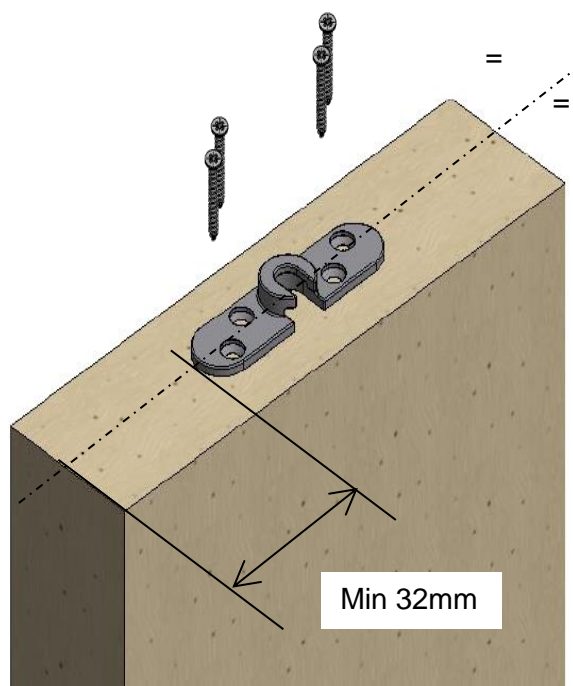

2. Door Routing Detail for Floor Guide

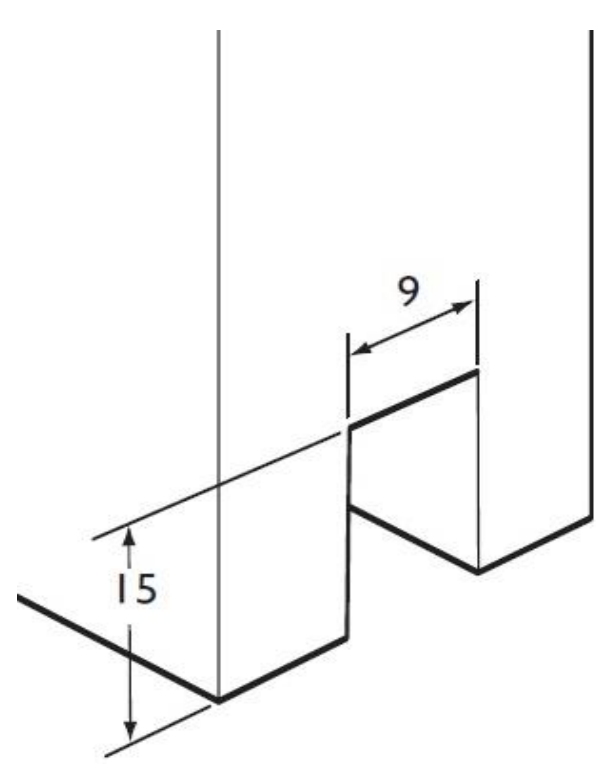

3. Prepare and Fit Track

- Cut track to length required
- Drill holes in track – hole size depends on fixing method. Use “V” to ensure holes central

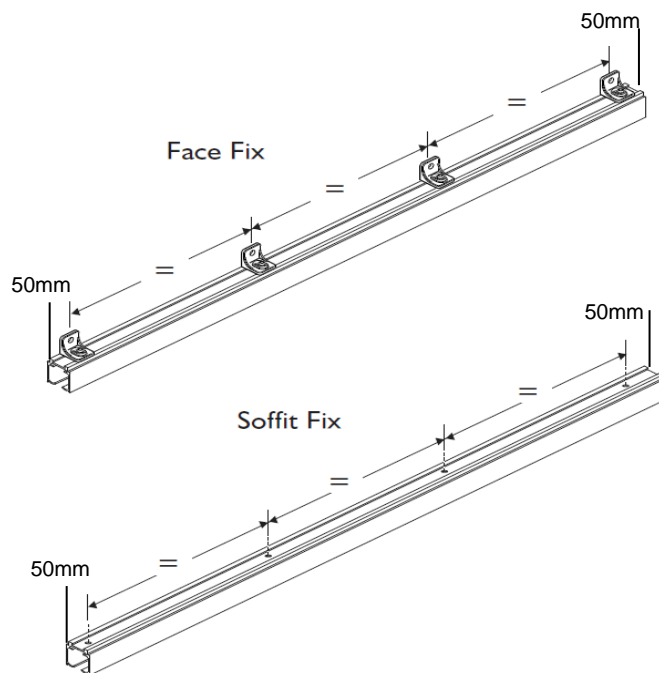
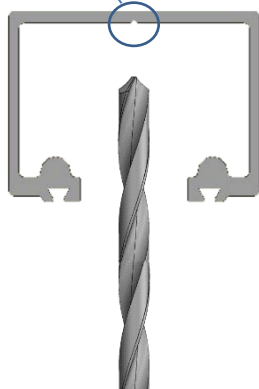

It is the installer's responsibility to ensure that the correct fixing/wall insert is used and is suitable - depending on the wall/ceiling type and quality

4. Load Hangers and Stops to Track

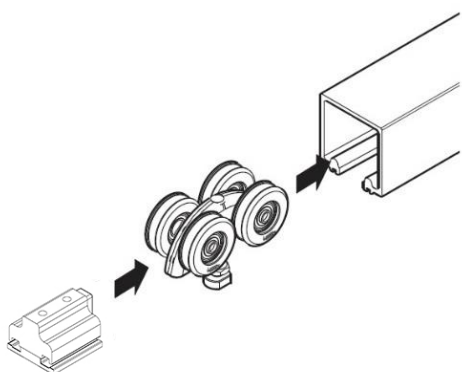

5. Fit Door

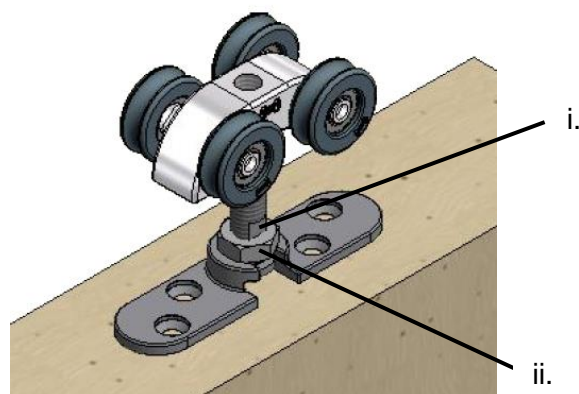

- Set Door height by rotating strap bolt on flats
- Once position set – tighten thin nut against apron

6. Check Door Height

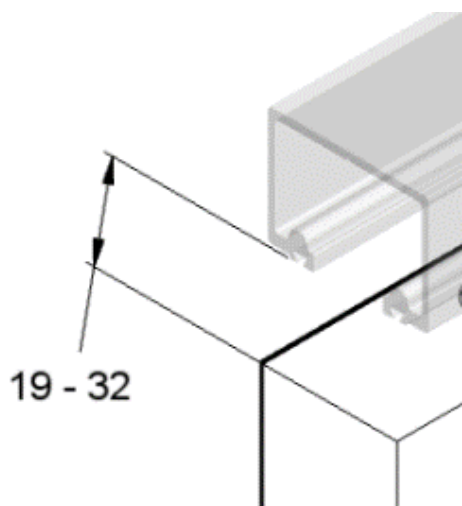

7. Confirm Door Movement

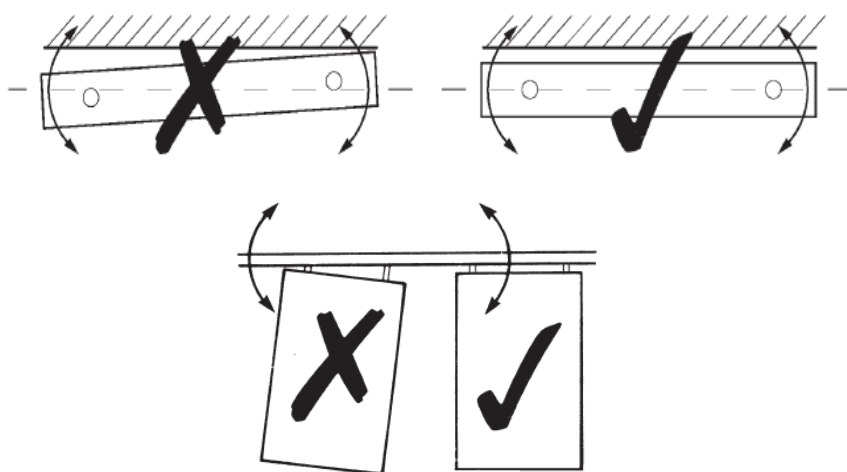

8. Fit Floor Guide

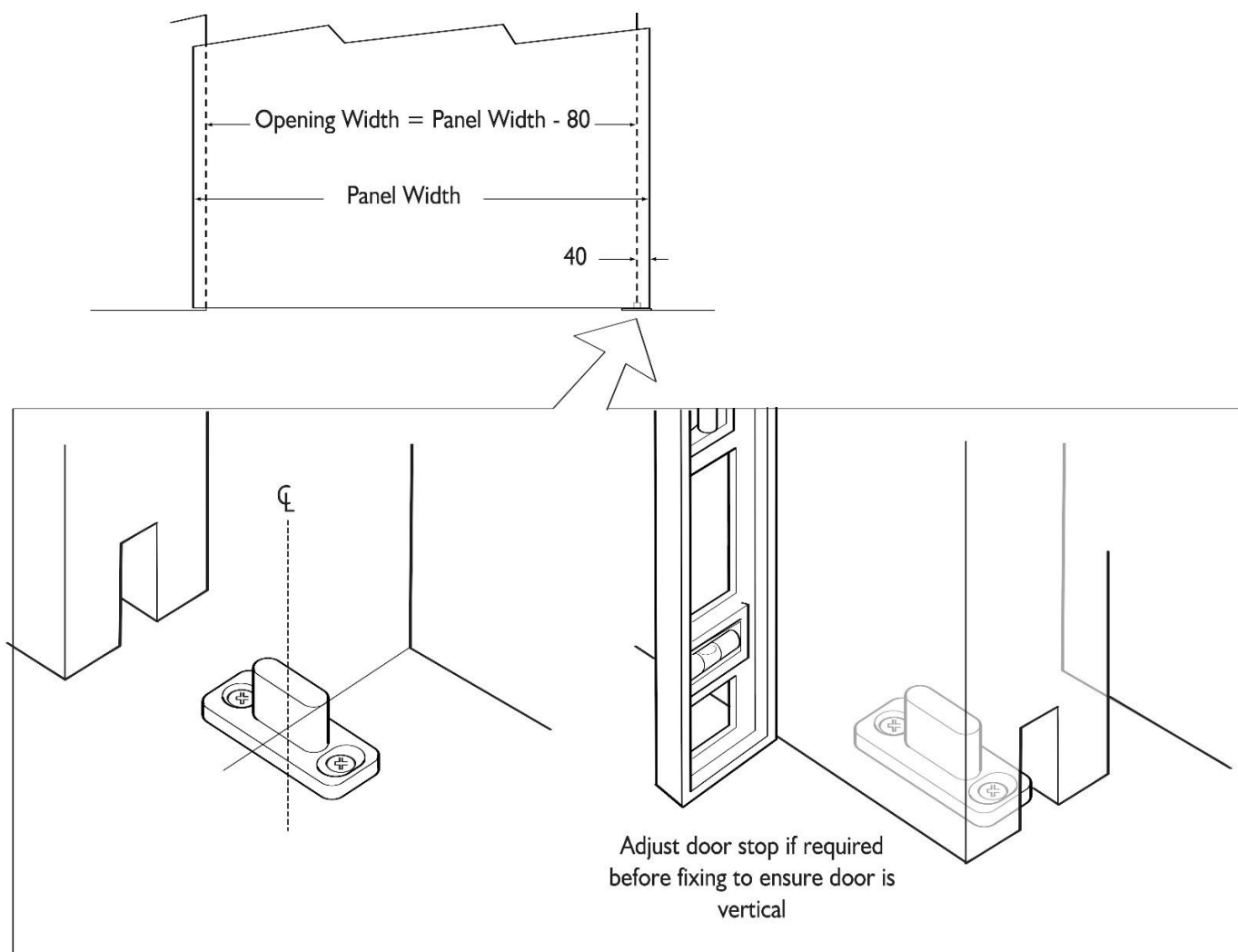

9. Final positioning:

Position & secure track stop block at both ends of the track

