

Round Flush Pull Set

© CARLISLE BRASS

Round flush pull set for use with sliding doors.



Features & Benefits

- Round flush pull set for use with sliding door and pocket door systems.
- Comes complete with 2 x round flush pulls and 1 x round finger pull.
- Upon installation, the flush pulls are recessed into the face of the door to offer a minimalistic appearance.
- Available in four stunning finishes — Black, Chrome, Satin Brass and Satin Nickel.
- Suitable for doors with a minimum thickness of 35mm.
- Extremely easy to install.

ALEXANDER & WILKS



Product Code	Finish	Flush Pull Diameter	Finger Pull Diameter
FPR/S	Satin Nickel	57mm	29mm
FPR/C	Chrome		
FPR/B	Black		
FPR/PB	Satin Brass		

Technical Drawing

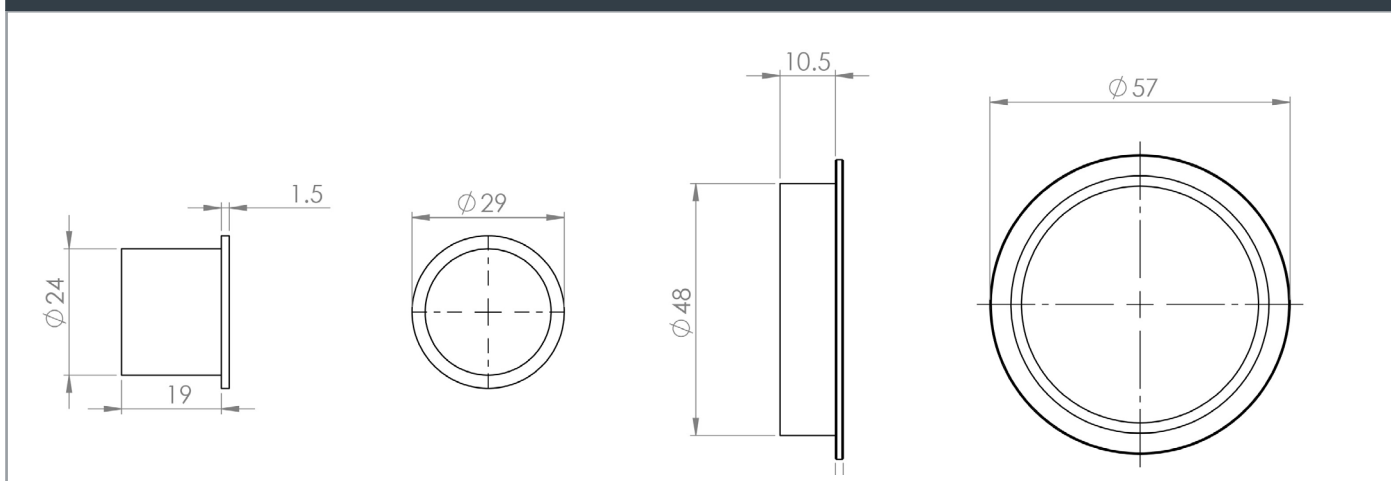

P C Henderson Ltd
Durham Road, Bowburn,
County Durham,
DH6 5NG

UK SALES
T: +44 (0) 191 377 7345
E: sales@pchenderson.com
W: www.pchenderson.com

HENDERSON