

## FITTING INSTRUCTIONS - NOTICE DE POSE - MONTAGE HANDLEIDING - MONTAGEANLEITUNG ISTRUZIONI DI MONTAGGIO - INSTUCCIONES DE MONTAJE

Instructions cover the installation of the following components

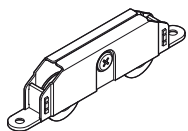

100N/200SS Roller

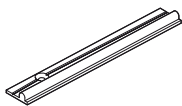

915A or 915B  
Bottom Rail



DS200/SS Floor Stop



113SS/94 Corner Bracket

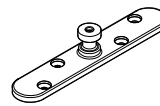

106HSS/94 Guide

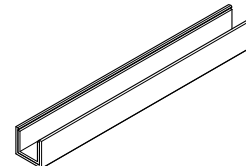

94SC & 94P Channel

### Face Fix

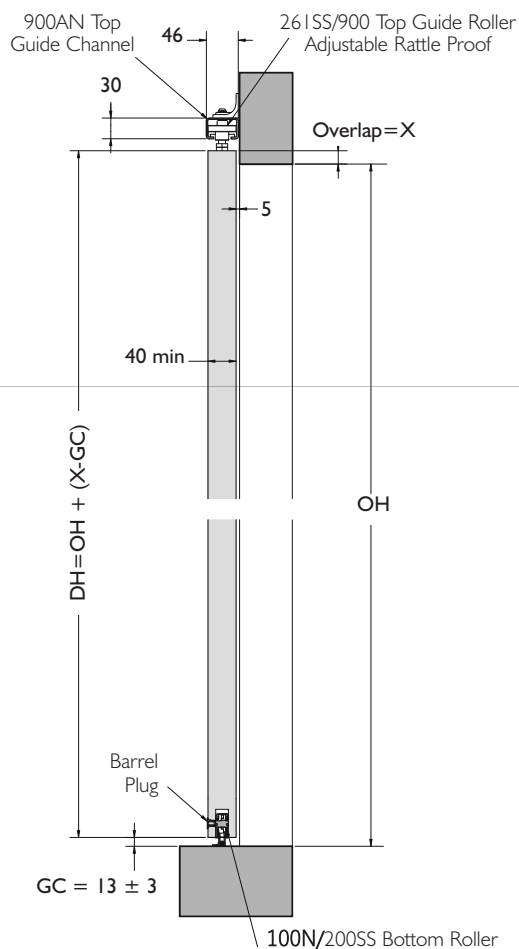

### Soffit Fix

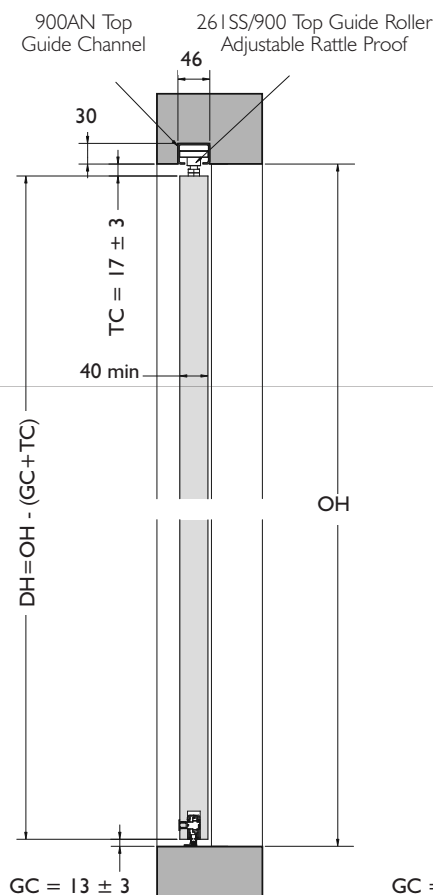

### Alternative Soffit Fix

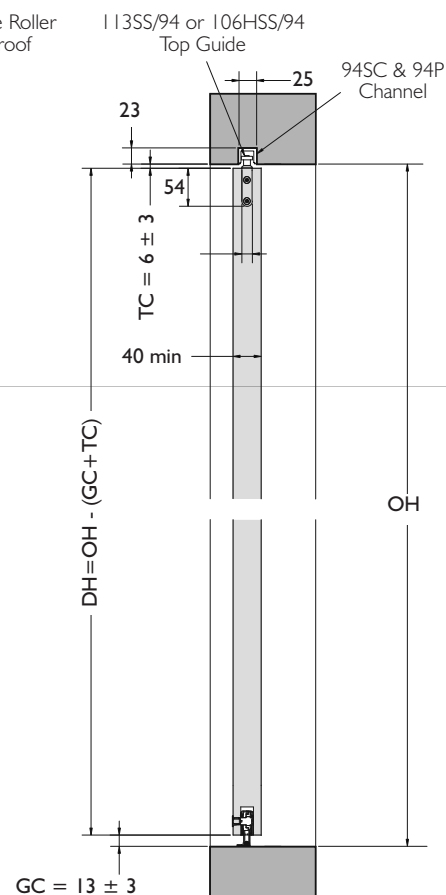

**NOTE:** Routing detail for all steps must be followed to the exact measurements provided. Failure to do so may effect the overall functionality and longevity of the product.

### Routing detail for guide rollers

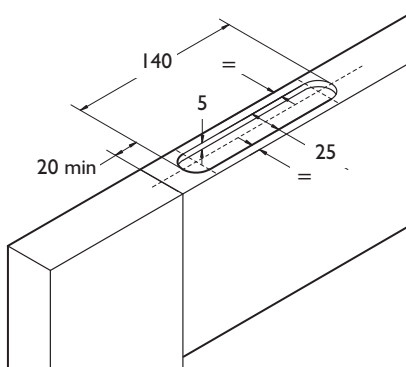

### Locate guide rollers

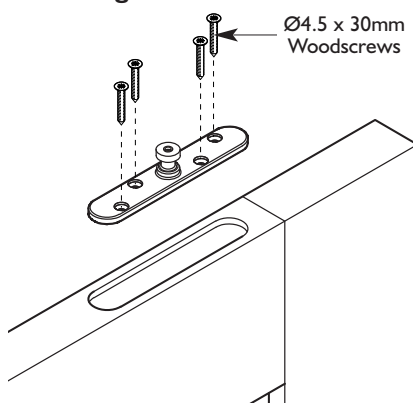

### Routing detail for corner bracket

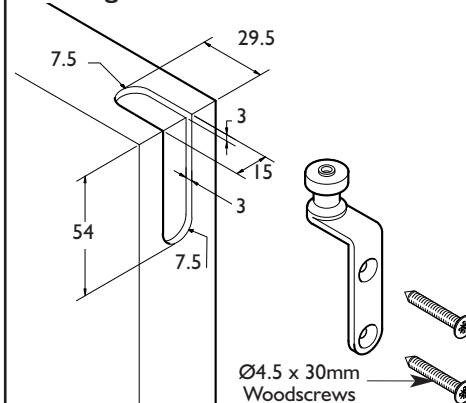

### Routing detail for bottom rollers

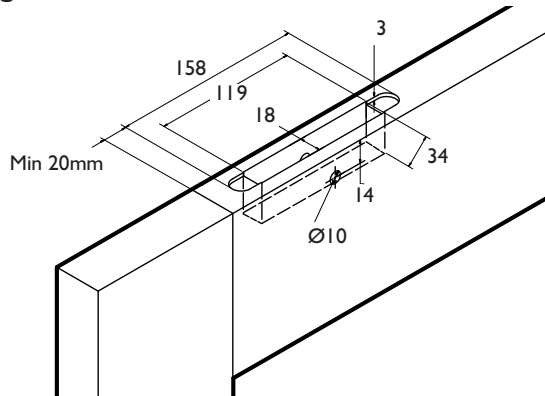

### Locate bottom rollers

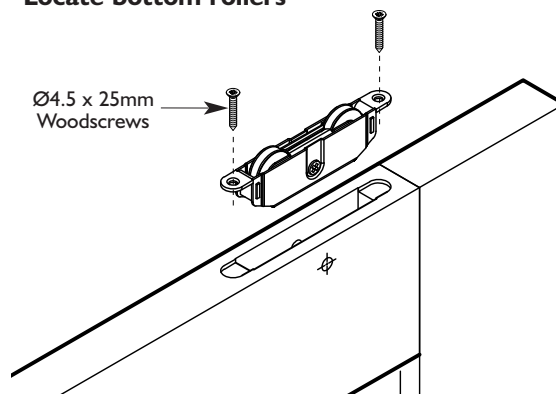

### Top guide channel and bottom rail installation

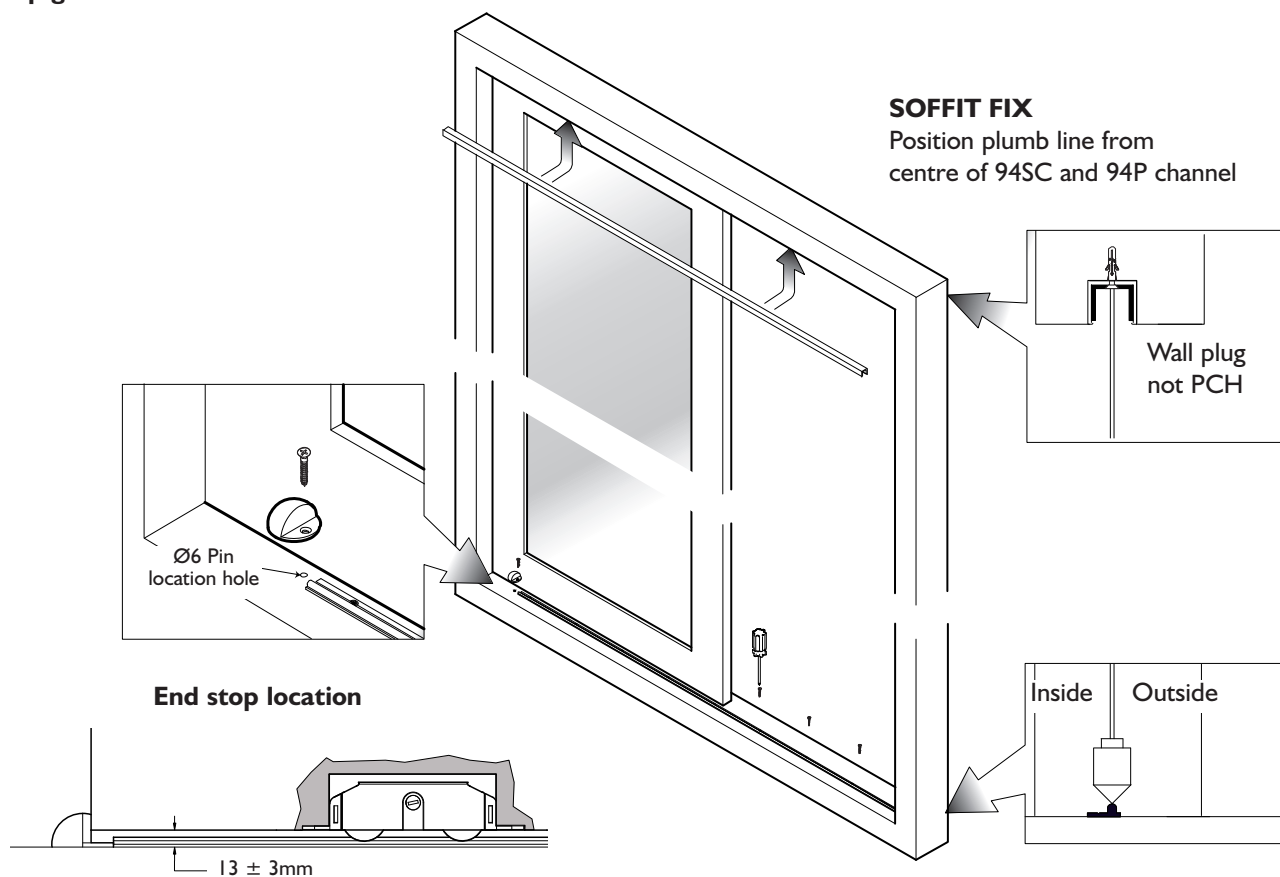

### Bottom roller adjustment

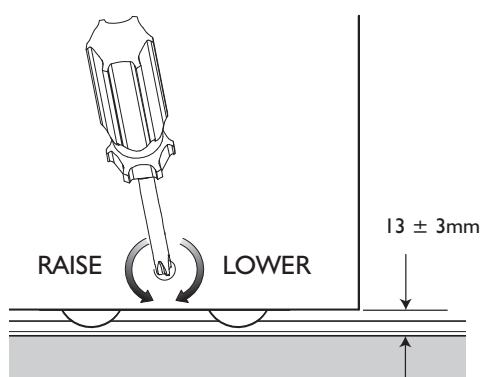

### Locate plugs

