

IMPERIAL PATIO KIT

FITTING INSTRUCTIONS

HENDERSON

WATCH THE INSTALLATION VIDEO

VISIT: WWW.PCHENDERSON.COM/IMPERIAL-INSTALLATION-VIDEO
OR SCAN THE QR CODE



KIT SPECIFICATION

Product Code		Track Length	Max. Door Width	Door Thickness Range	Max. Door Weight
Locking	Non Locking				
IMPATIO100/L	IMPATIO100/NL	3000mm	1500mm	40 - 56mm	100kg
IMPATIO/L	IMPATIO/NL	3000mm	1500mm	40 - 56mm	200kg

KIT CONTENTS

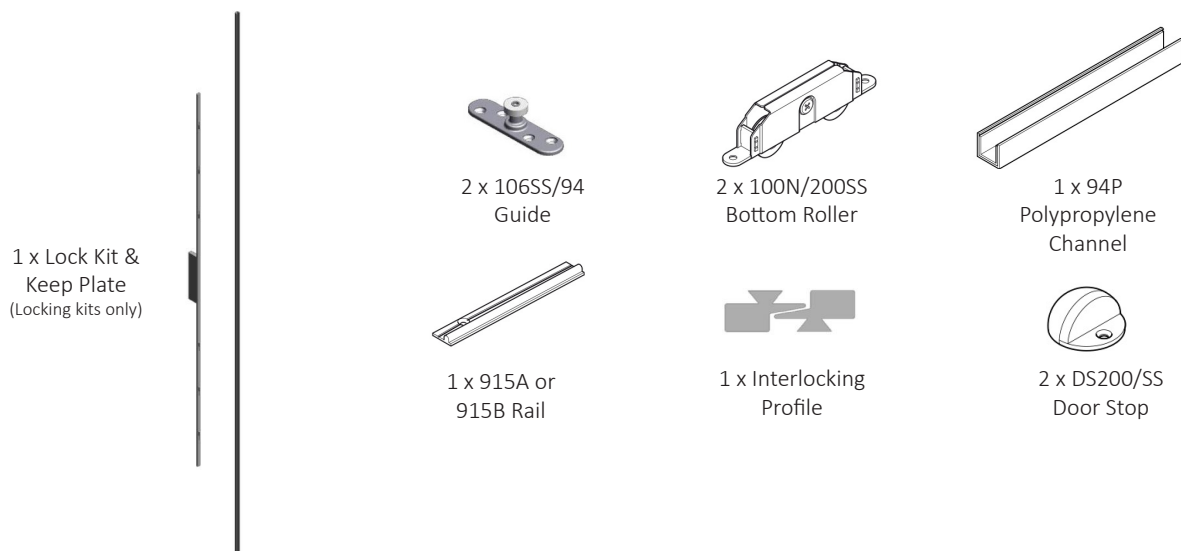

TOOLS REQUIRED

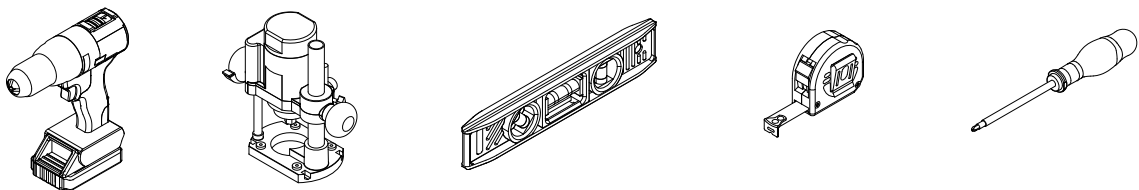

LOCKING KIT OVERVIEW

BIPARTING DOOR APPLICATIONS

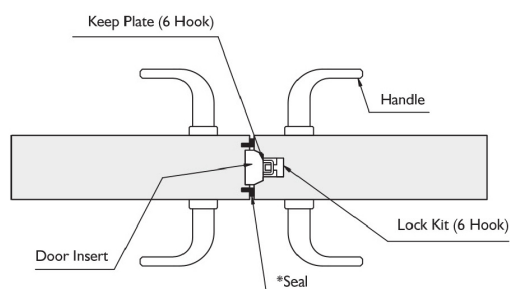

SINGLE DOOR APPLICATIONS

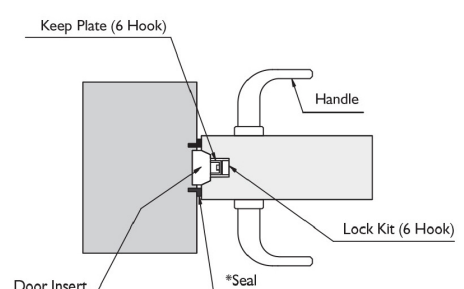

DOOR CONFIGURATIONS

1 x Sliding and 1 x Fixed Panel

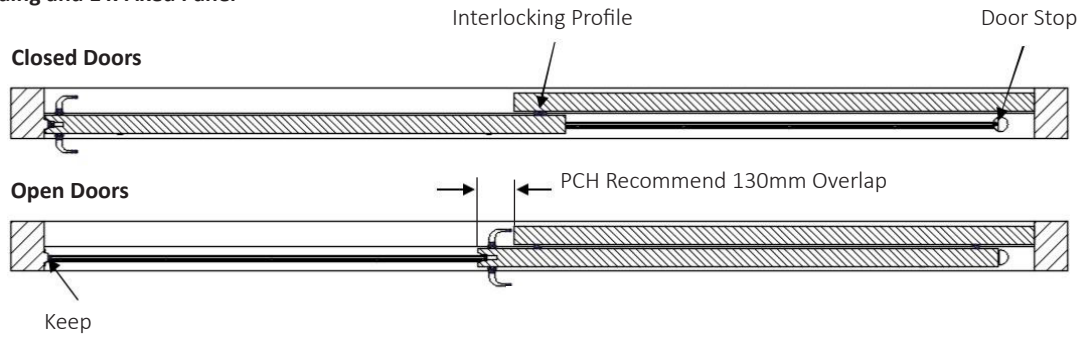

2x Sliding and 1 x Fixed Panel

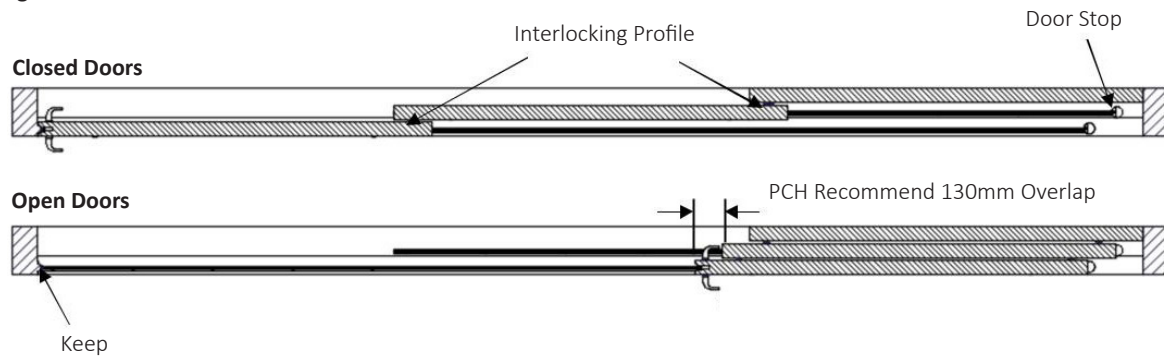

2x Sliding and 2 x Fixed Panel

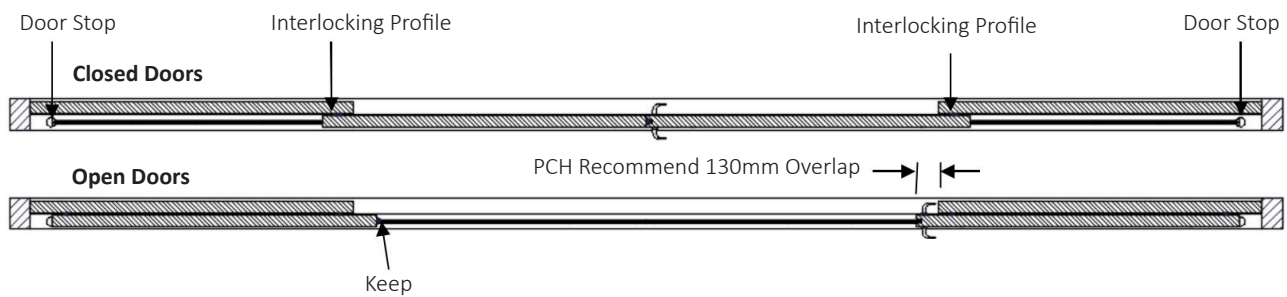

SYSTEM OVERVIEW

One Fixed and One Sliding Panel Central Meeting Panels

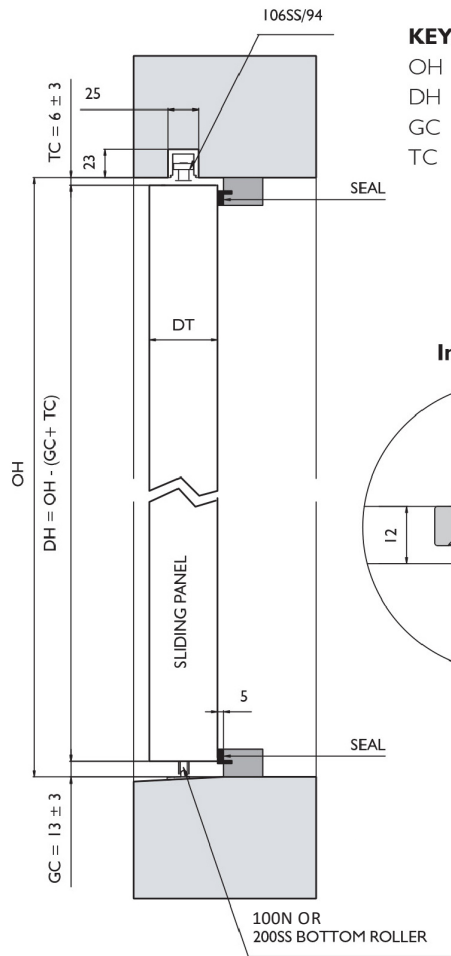

KEY

OH = Opening Height
DH = Door Height
GC = Ground Clearance
TC = Top Clearance

Interlock Detail

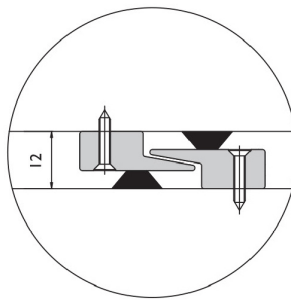

One Fixed and Two Sliding Panels

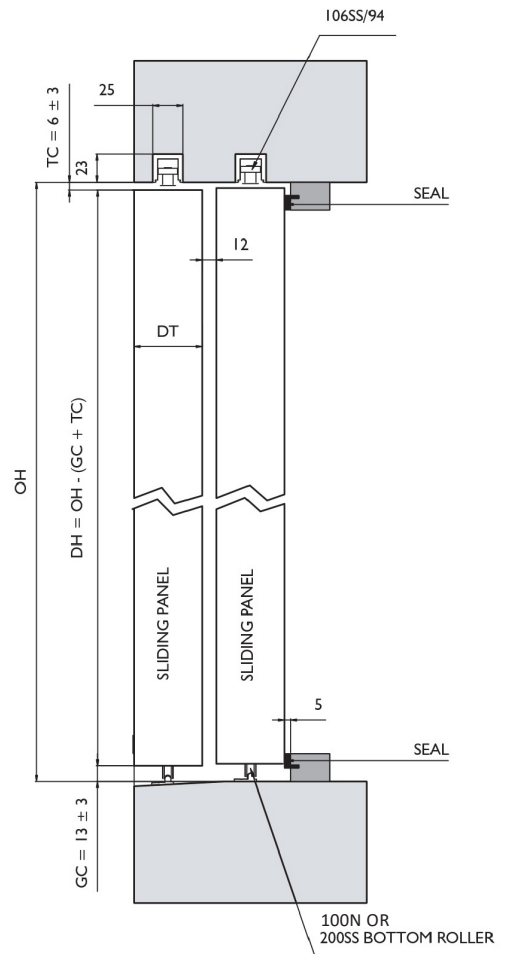

* = Seals not included in kit

PCH recommends a minimum door style of 150mm

STEP BY STEP INSTRUCTIONS

1

ROUTE GUIDES INTO THE TOP OF THE DOOR.

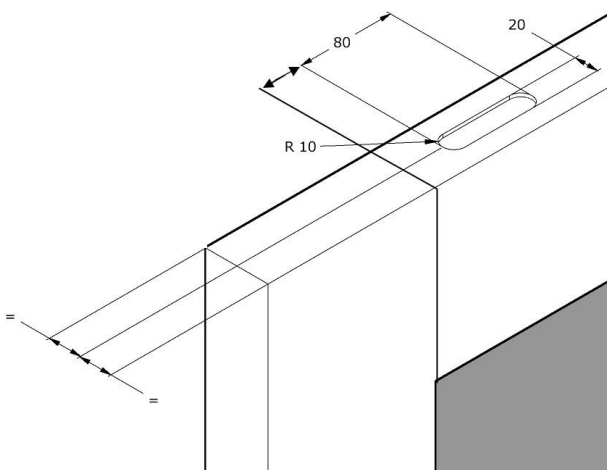

2

FIX TOP GUIDES INTO PLACE.

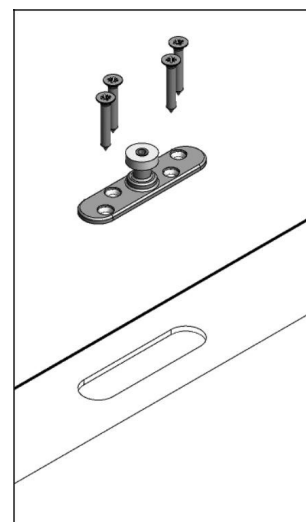

3

ROUTE BOTTOM ROLLERS INTO THE BOTTOM OF THE DOOR.

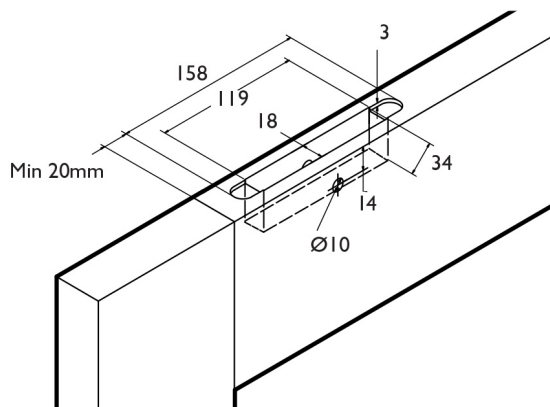

4

FIX BOTTOM ROLLERS INTO PLACE.

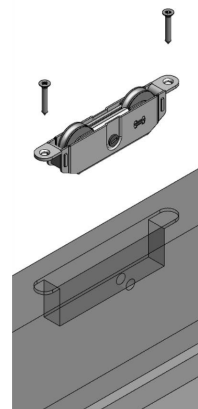

INSTALLING THE LOCK KIT (IF INSTALLING A NON LOCKING KIT SKIP TO STEP 10)

5

ROUTE THE LOCKING BAR INTO THE FULL HEIGHT OF THE DOOR.

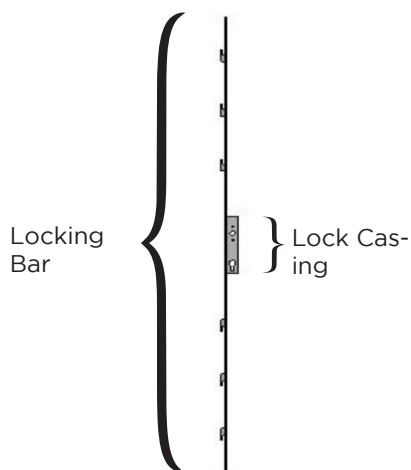

Elevated View

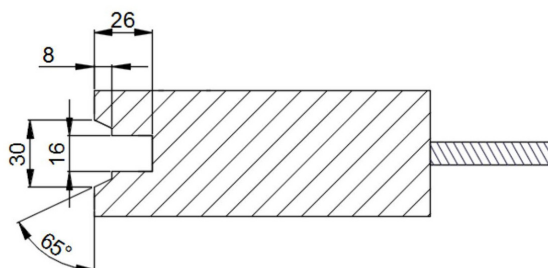

6

ROUTE THE LOCK CASING INTO THE DOOR AS SHOWN.

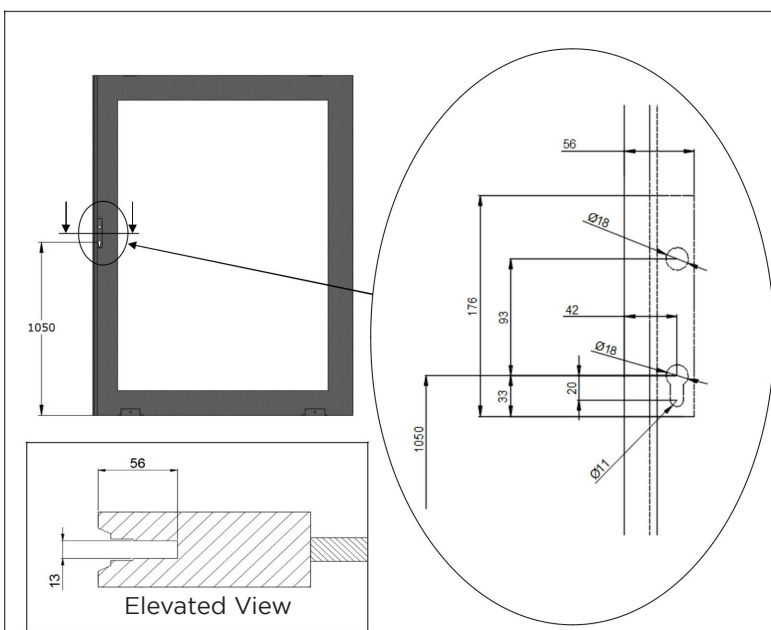
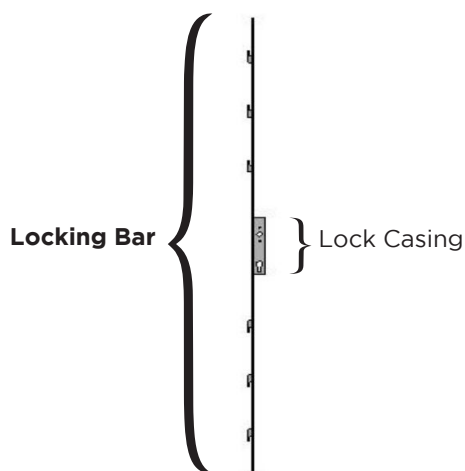

7

FIX LOCKING BAR INTO PLACE.

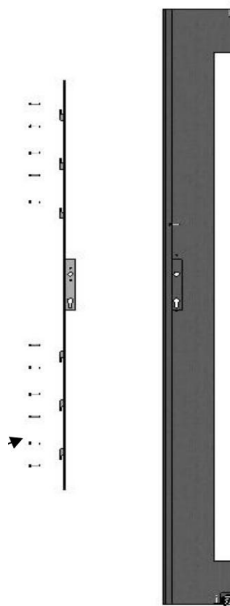

8

ROUTE THE KEEP PLATE THE FULL HEIGHT OF THE DOOR OR JAMB.

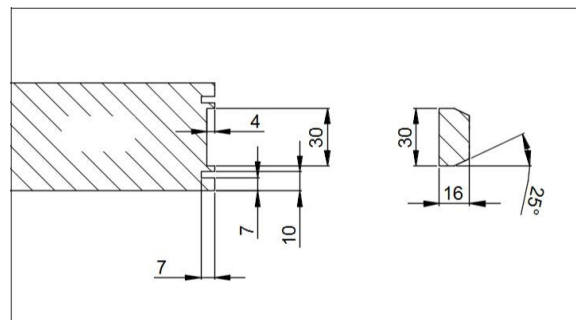

9

FIX THE KEEP INTO PLACE

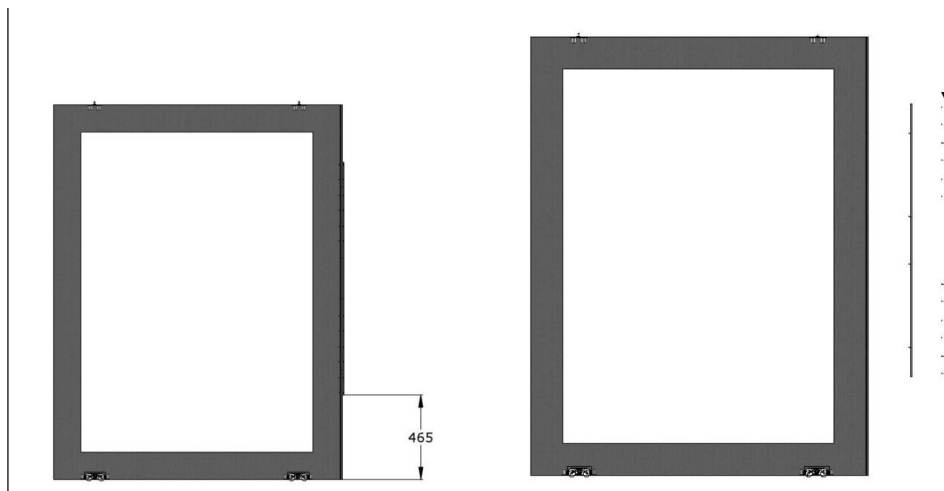

FITTING THE CHANNEL AND RAIL

10

FIX CHANNEL AND RAIL INTO PLACE, LEAVING 146MM FROM THE EDGE OF THE OPENING AT BOTH THE TOP OF BOTTOM OF THE FRAME.

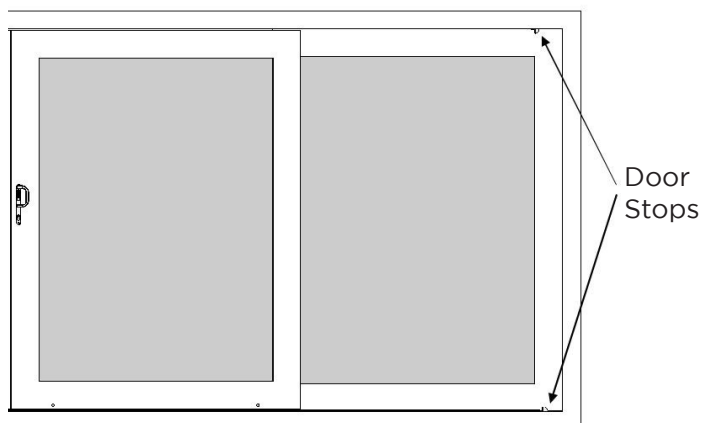
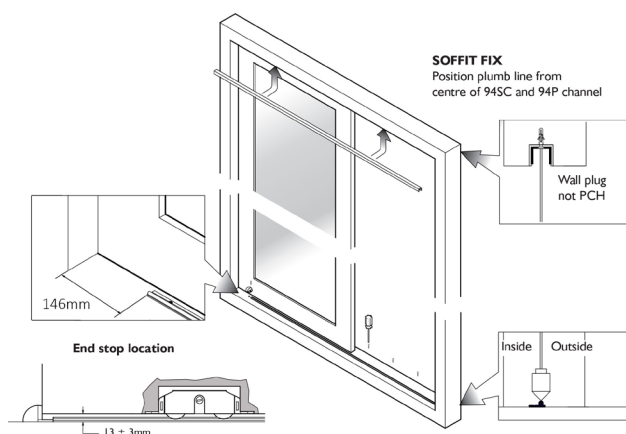

Channel & Rail Length Formular: Opening Size - 146mm

- 11** FIX THE DOOR STOPS INTO PLACE AT THE TOP AND BOTTOM OF THE OPENING.

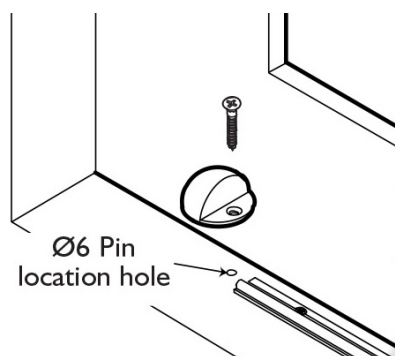

- 12** HANG THE DOORS.



- 13** FIX THE INTERLOCKING PROFILE INTO PLACE.

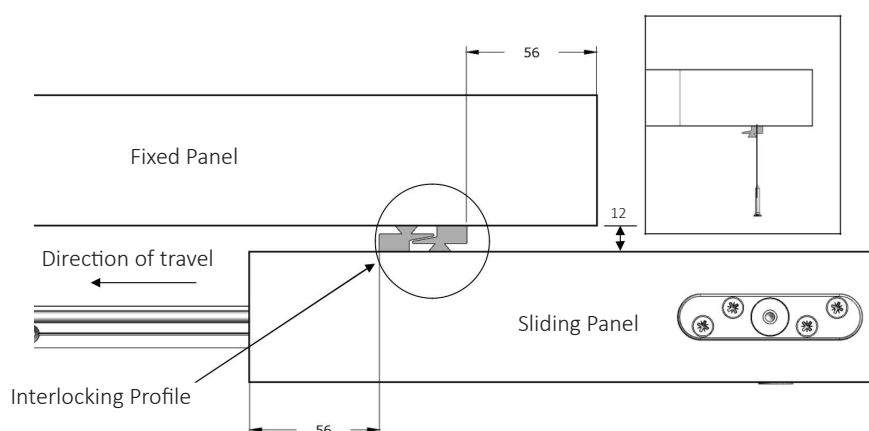

DOOR ADJUSTMENTS

- 14** ADJUST DOOR POSITION TO ENSURE SMOOTH RUNNING. LOCATE PLUG TO FIX BOTTOM ROLLER INTO PLACE.

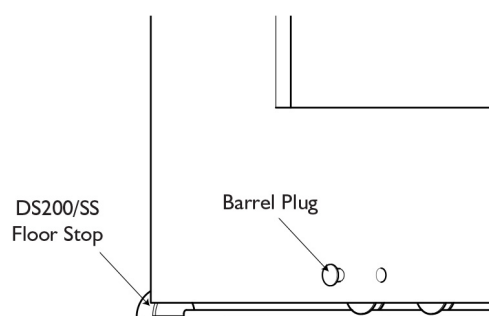
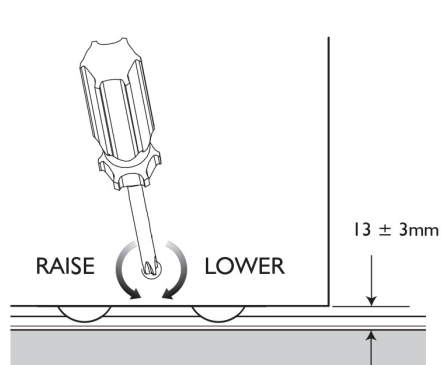

P C HENDERSON LTD UK SALES

Durham Road, Bowburn, t: +44 (0) 191 377 7345
Co. Durham,
DH6 5NG

e: sales@pchenderson.com
w: www.pchenderson.com

IRELAND SALES

t: +353 (0)1 643 6816
e: sales@pchenderson.ie
w: www.pchenderson.com

INTERNATIONAL SALES

t: +44 (0) 191 377 7346
e: international@pchenderson.com
w: export.pchenderson.com

600799

REV 14

Jan-25