

System specification – For use with SF50 – SF100 – SF150 – SFBR 80

Product name	Product short code	Minimum door thickness	Maximum door thickness	Maximum door height
Securefold 50kg & 100kg non mortice	TB/SF	56mm	68mm	3300mm
Securefold 50kg & 100kg mortice	TB/SFM			3300mm
Securefold 150kg non mortice	TB/SF150			4000mm
Securefold bottom roller 80kg non mortice	TB/SFBR			3000mm
Securefold bottom roller 80kg mortice	TB/SFMBR			3000mm

Content of kit (supplied in two packages)

Content of package one

2 x Shoot bolt block

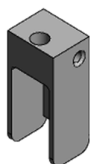

1 x Cover plate

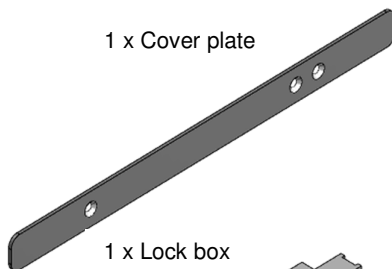

2 x Keep plate



2 x Floor keep

(Only 1 in SFBR kits)



1 x Lock box

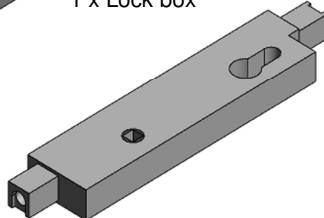

Screw pack contents

4 x Ø4.5 x 30 Wood screw

2 x 1 & 3/4" x 8g Woodscrews

2 x M4x9 Countersink head screw

Content of package two

1 x Long Lock rod

1 x Short lock rod

(Including assembled shoot bolts, connection pins and screws)

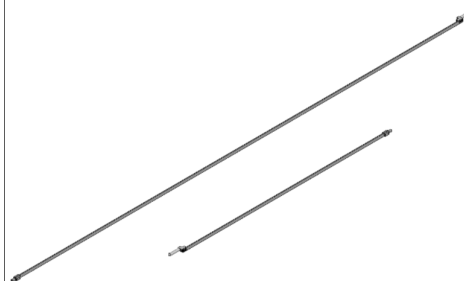

Accessories



Cover strip – available in Black, Brown or White



Handle Kit – Including Handle, Cylinder cover plate and screws

Tools required

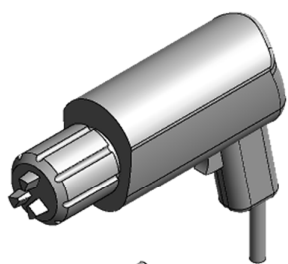

Drill & drill bit sizes
Ø3.0 & Ø4.1 (for
adjustment only)



Tape measure

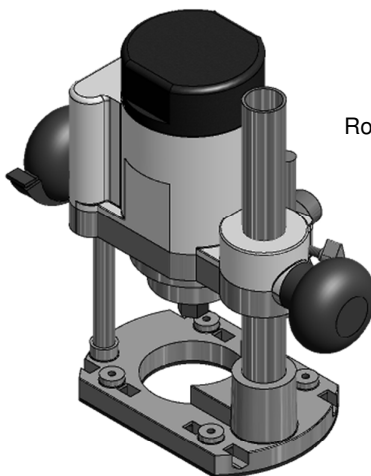

Router

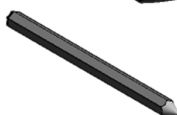

Pencil (for
adjustment only)



Posi drive
screwdriver

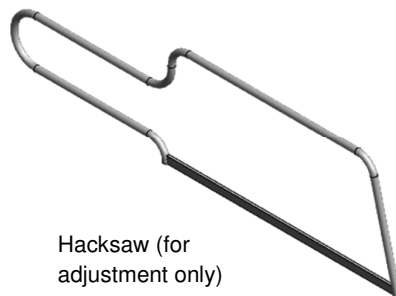

Hacksaw (for
adjustment only)

Door routing detail

Offsets		
	Non Mortise	Mortise
Lock rod offset = X	24mm	15mm
Lockbox offset= Y	16.5mm	15mm
Cover plate = Z	15.5mm	14mm

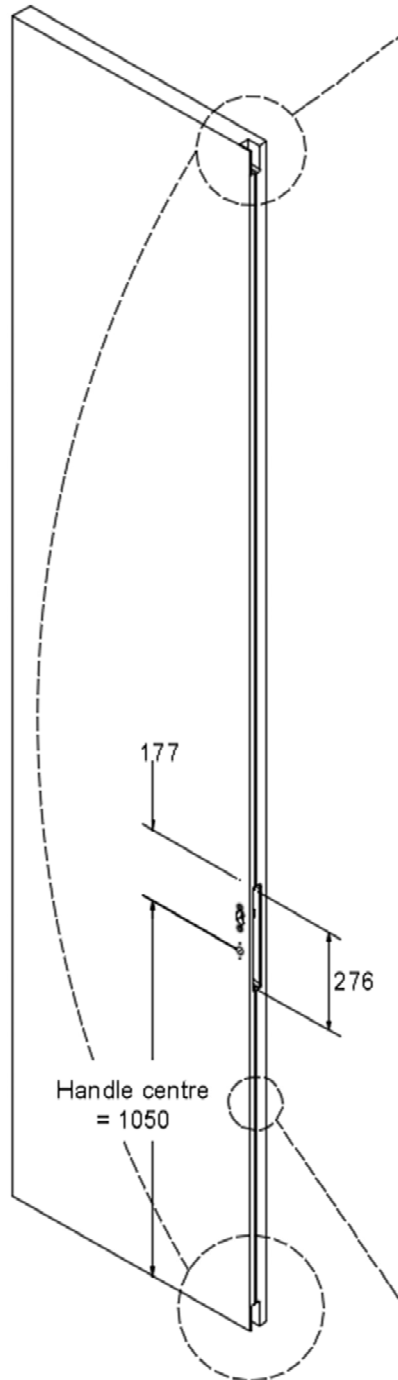

Shoot bolt block location

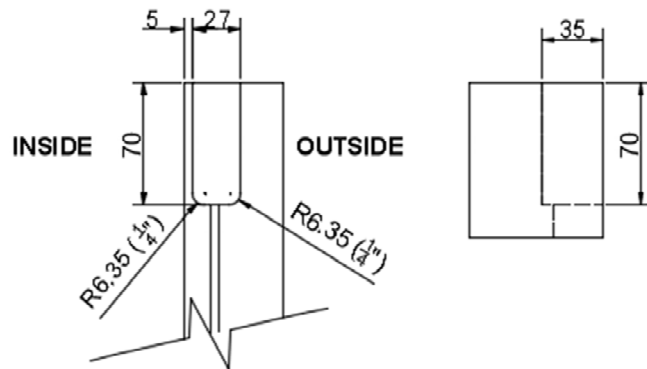

Lock box position

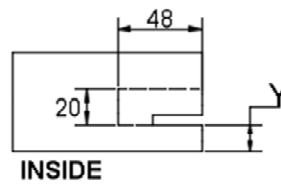

Handle & escutcheon plate position

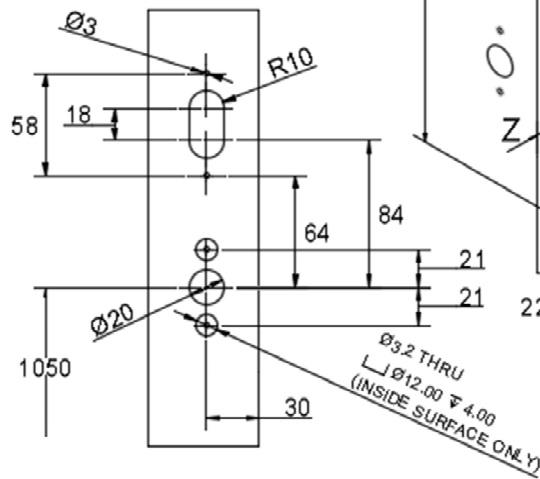

Cover plate position

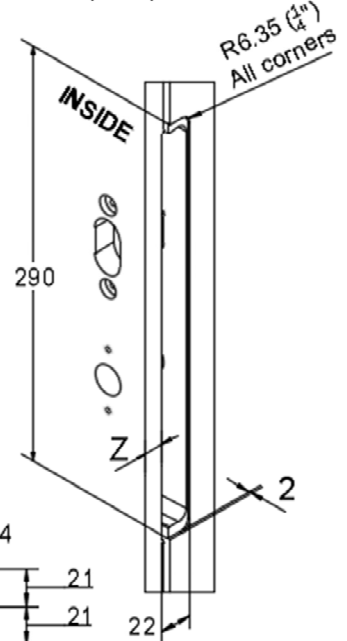

Lock rod position (full door height)

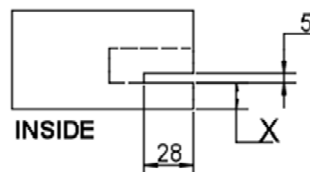

Routing detail for SF 50, 100 & 150 keep plates (use Ø4.5x30 wood screws)

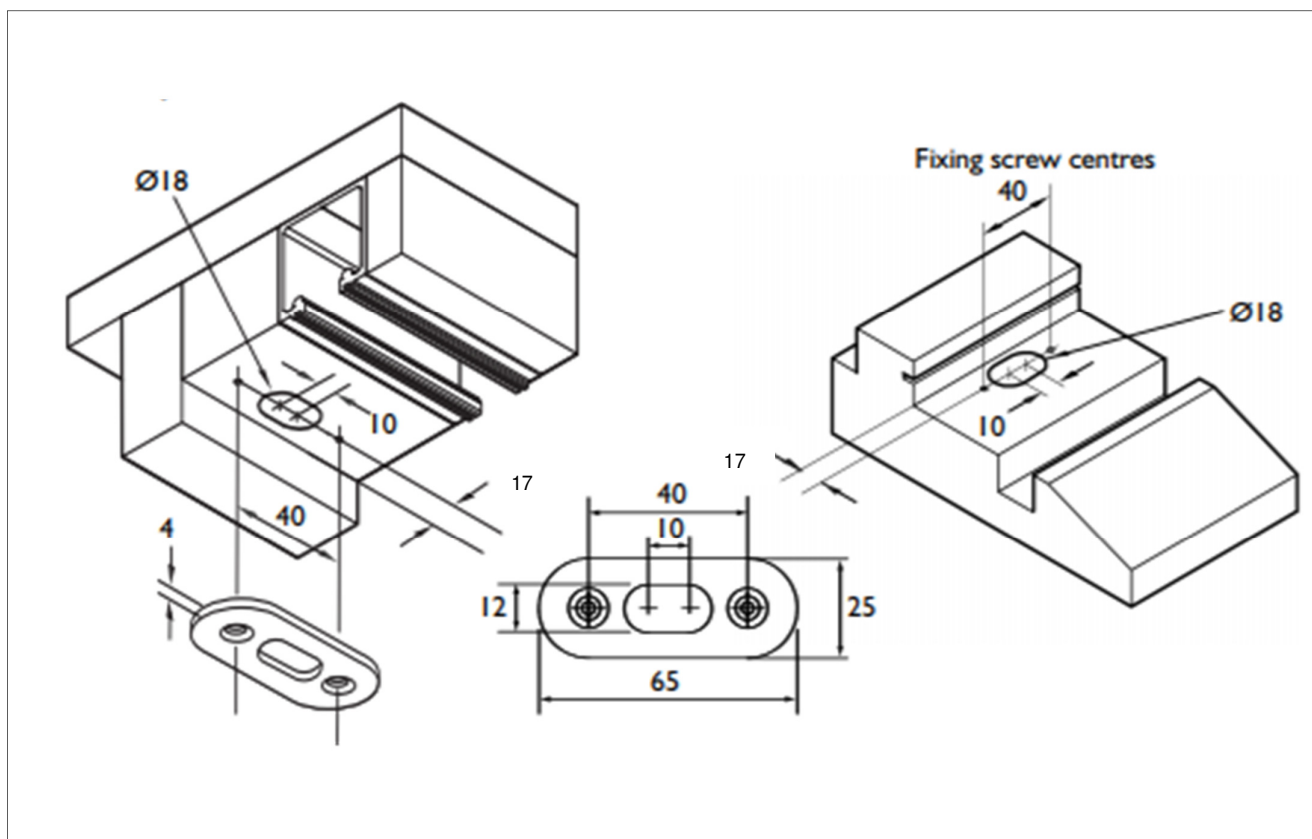

Routing detail for SFBR 80 keep plates (use Ø4.5x30 wood screws)

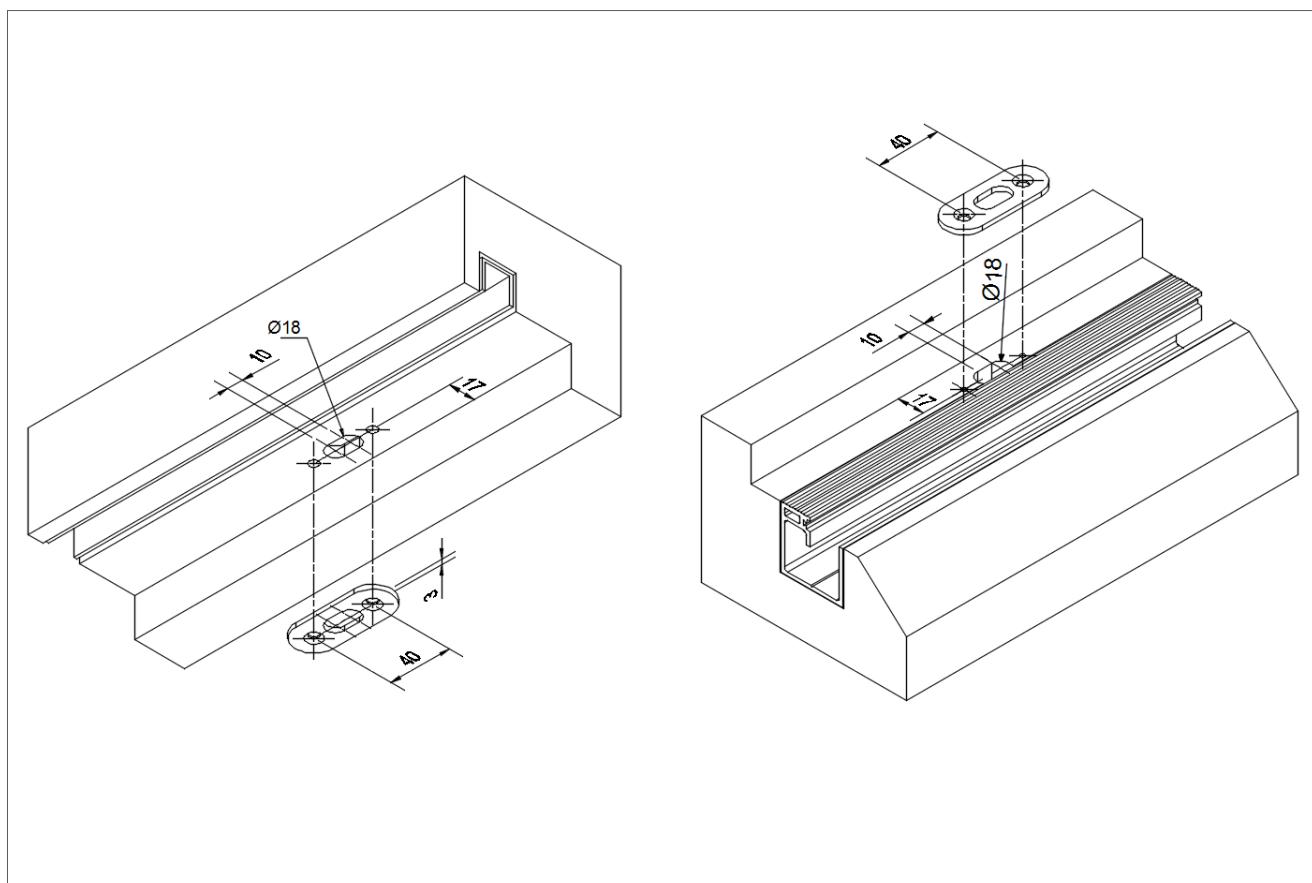

Mortice version

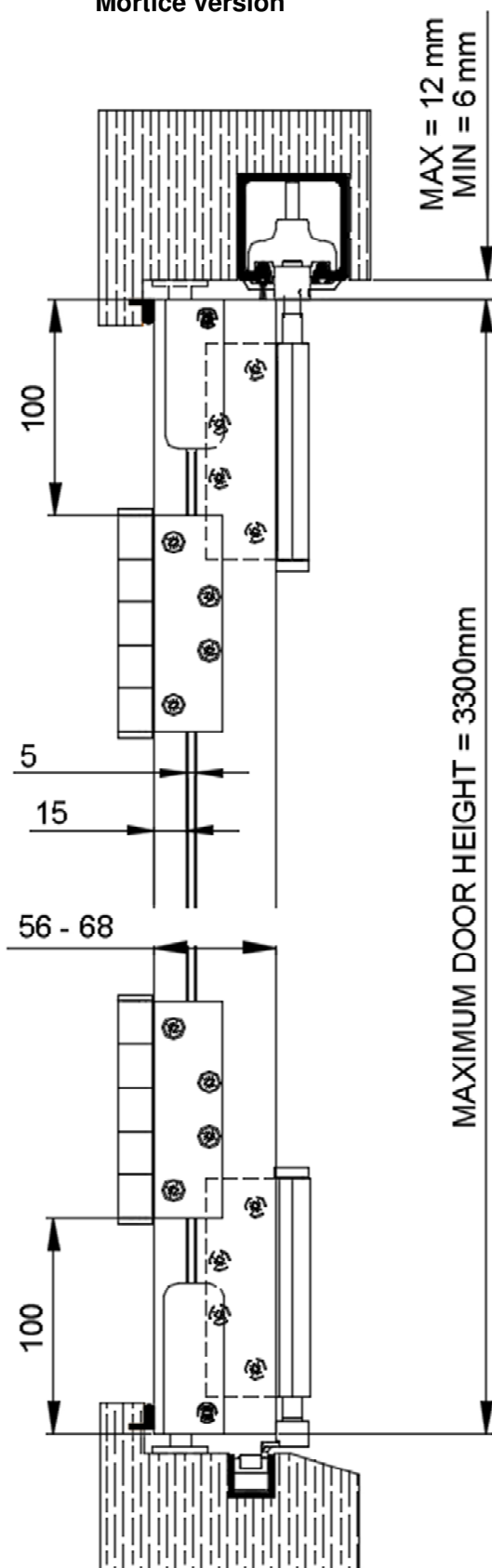

Non mortice version

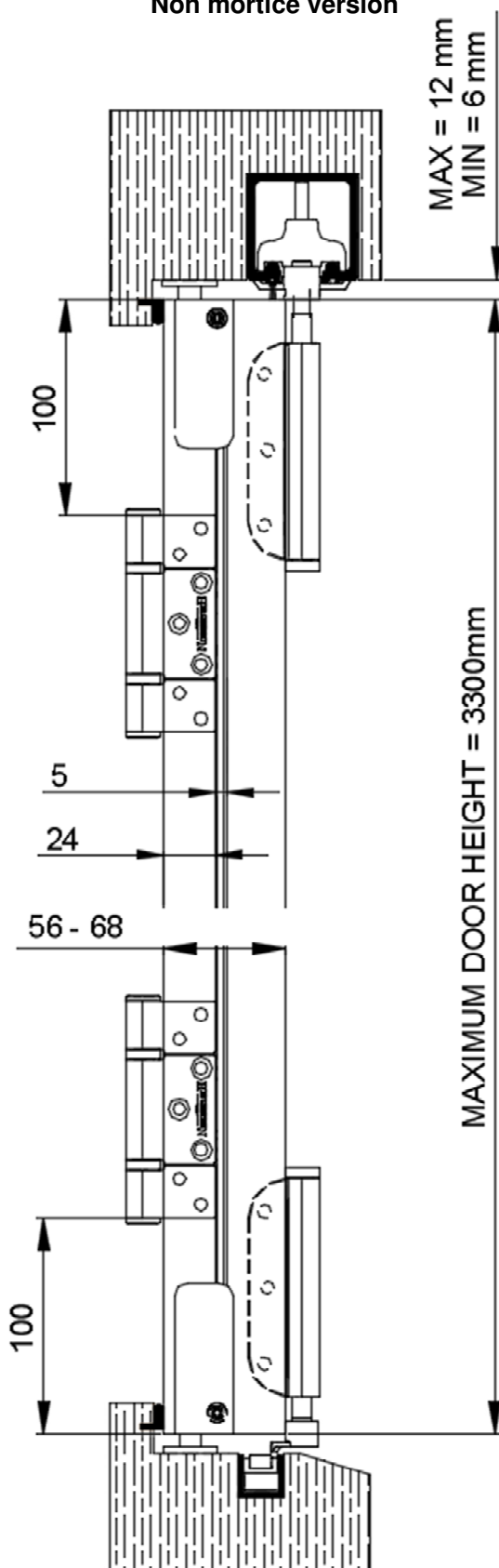

Mortice version

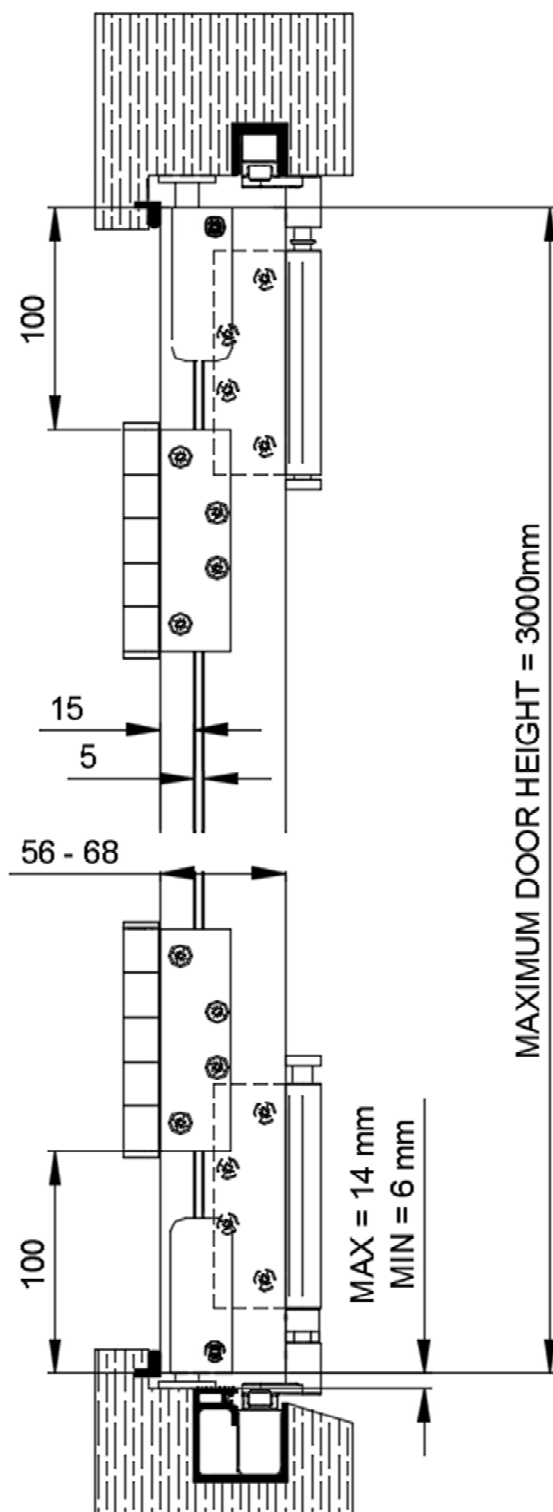

Non mortice version

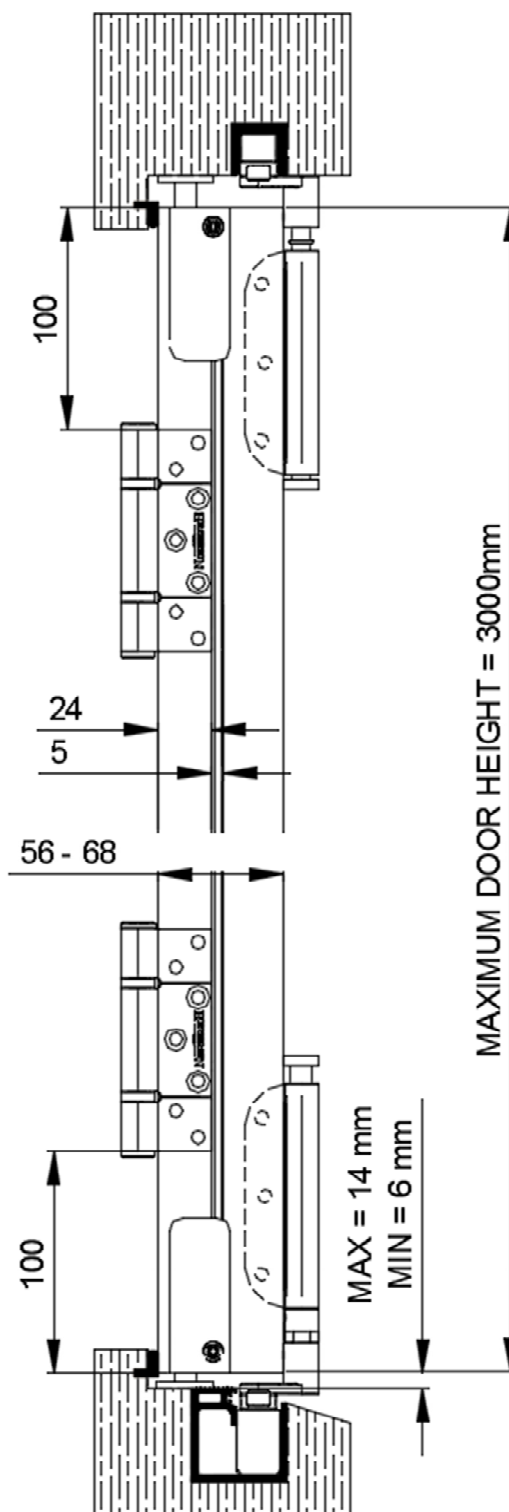

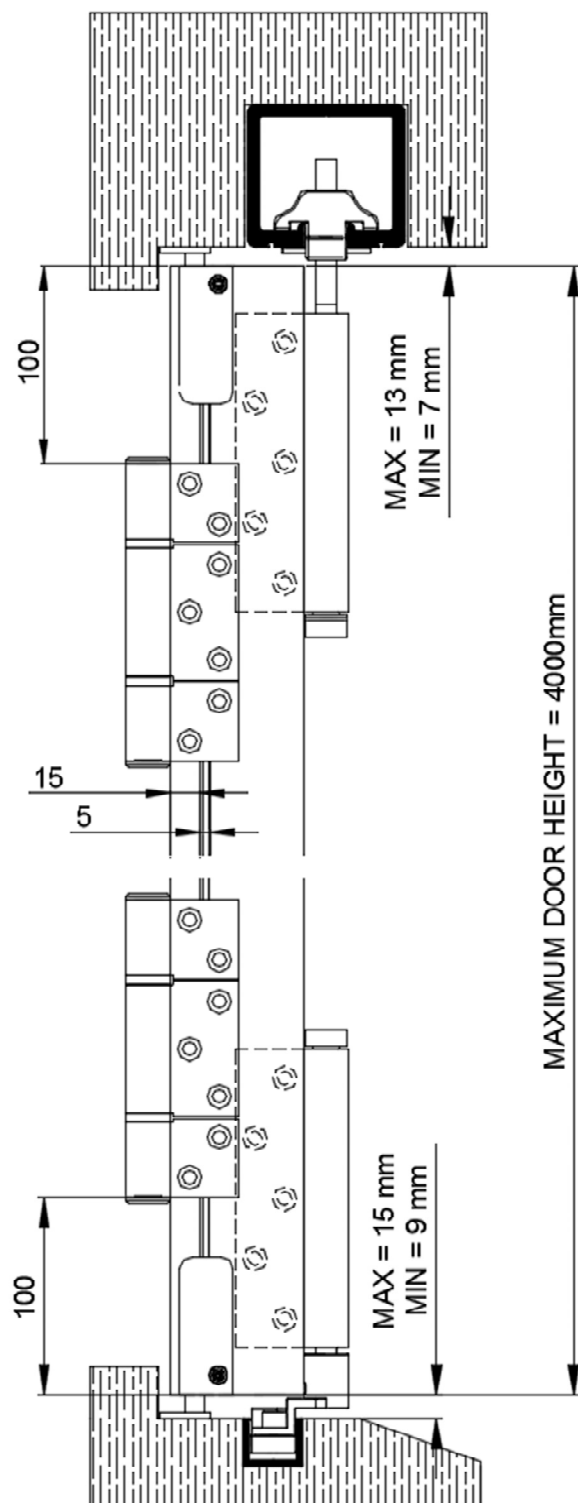

1. To reduce for specific door size, cut TOP LOCK ROD ONLY to suit door specific door height

Calculation Max leaf height (system specific) – actual leaf height = lock rod reduction

Max leaf height SFBR80 = 3000mm - SF50 & 100kg = 3300mm – SF150kg = 4000mm – SFBR80 = 3000mm

- A. Remove connecting pin, retain screws then cut to length (see calculation above)

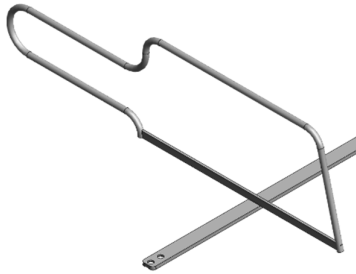

- B. Use connecting pin as drill guide – Drill 2 X Ø3.0

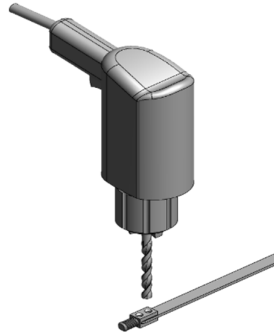

- C. Remove connecting pin – open out holes to Ø4.1. Re introduce countersink as required

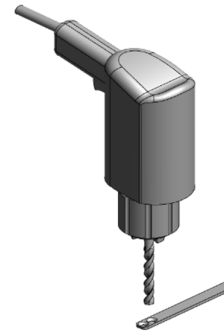

- D. Reattach connecting pin and secure screws with thread lock adhesive

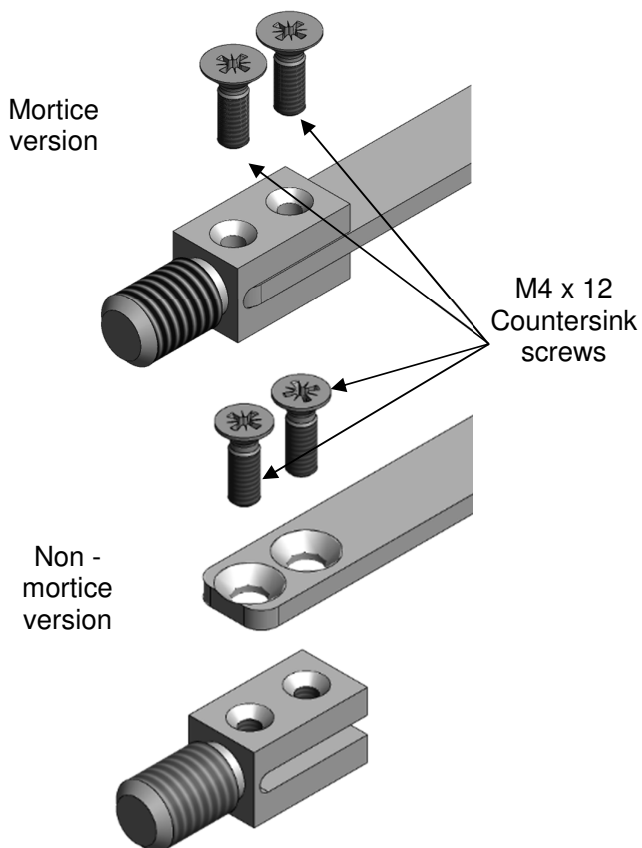

- E. Follow steps 2 through 7 to insert hardware into door

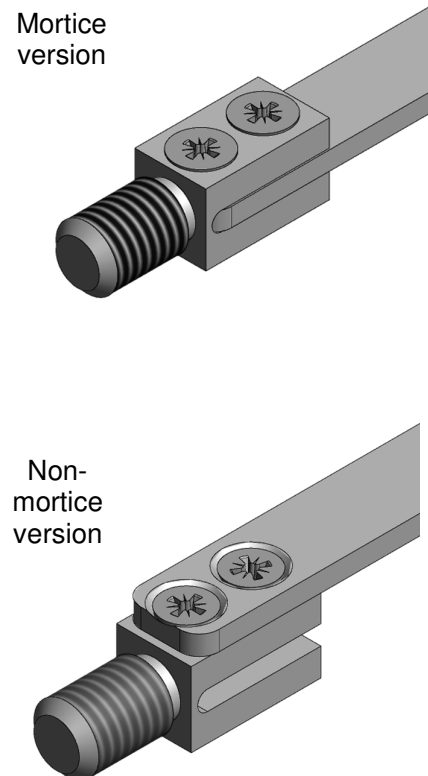

2. Attach lock rods to lock box – Ensure long lock rod is located in threaded end nearest the euro cylinder

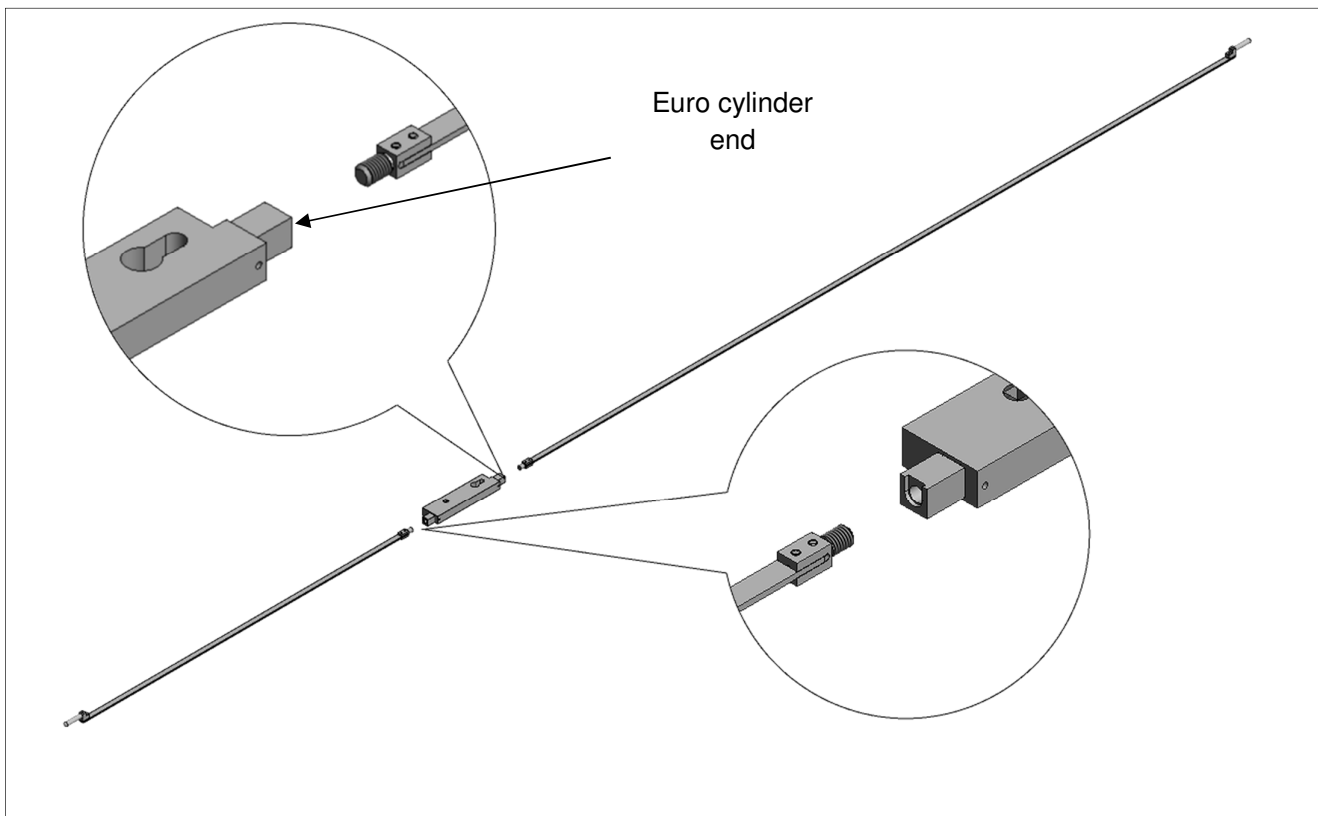

3. Rotate lock rods to engage with lock box

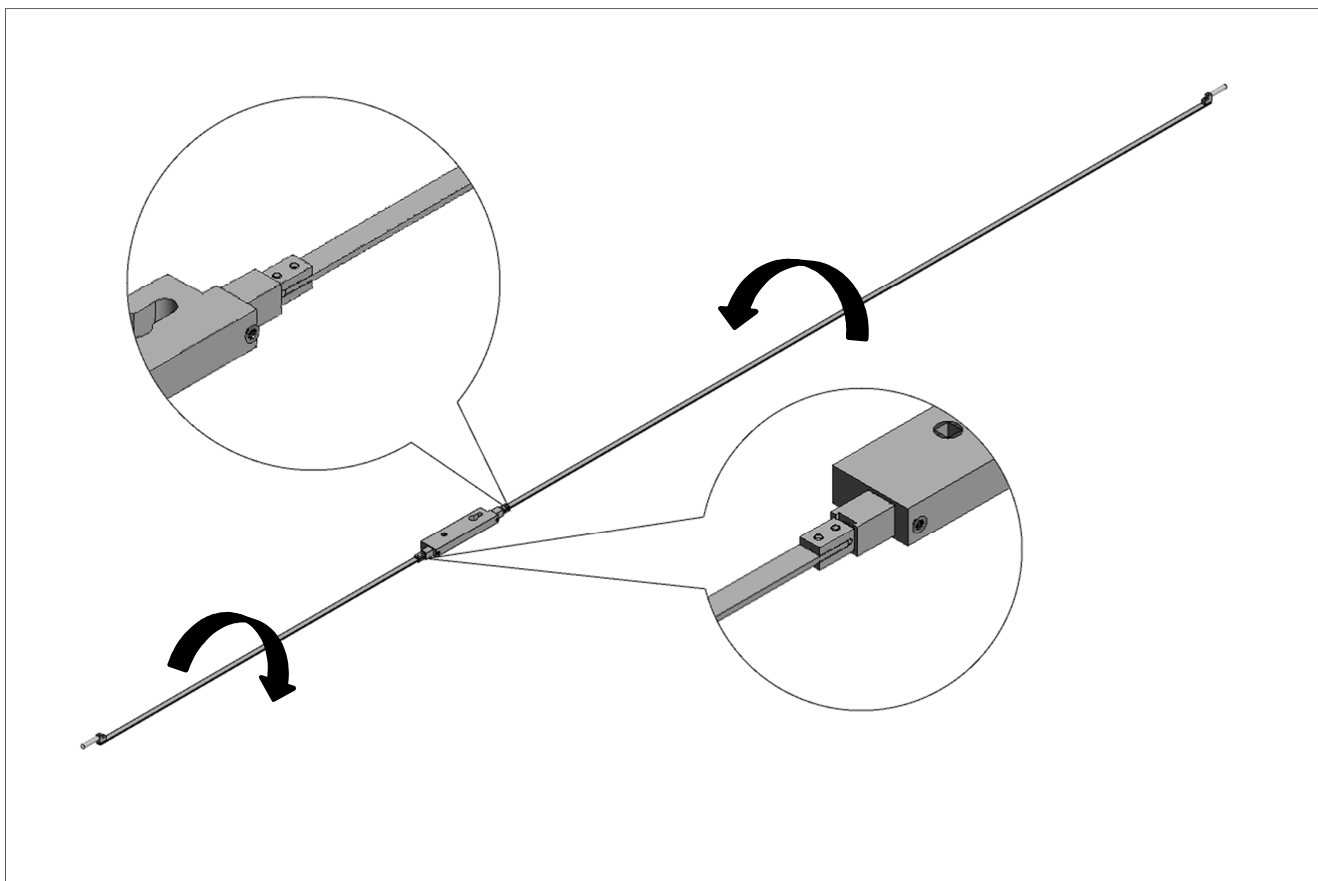

4. Insert assembly into routed door edge

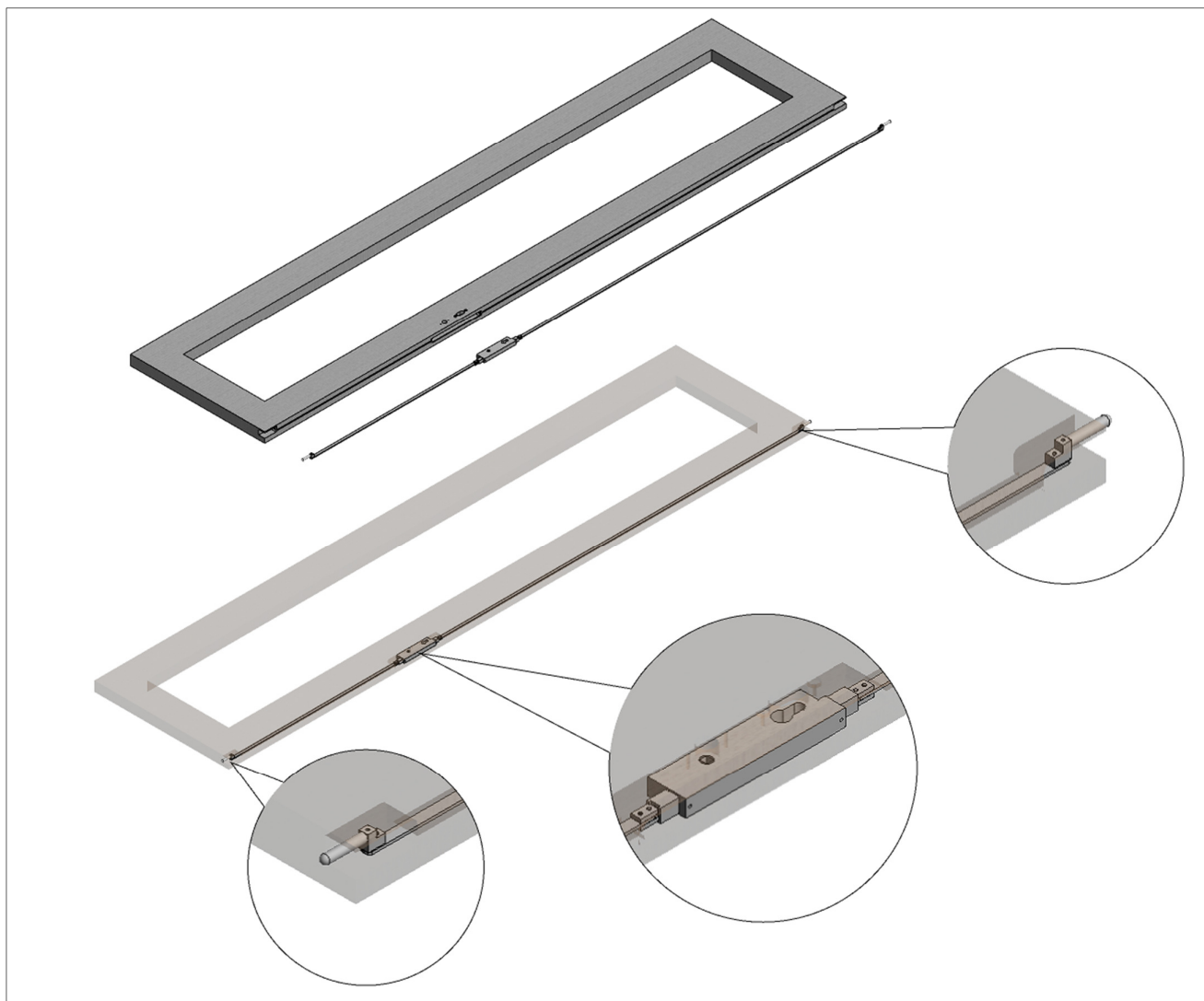

5. Position shoot bolt blocks in both ends

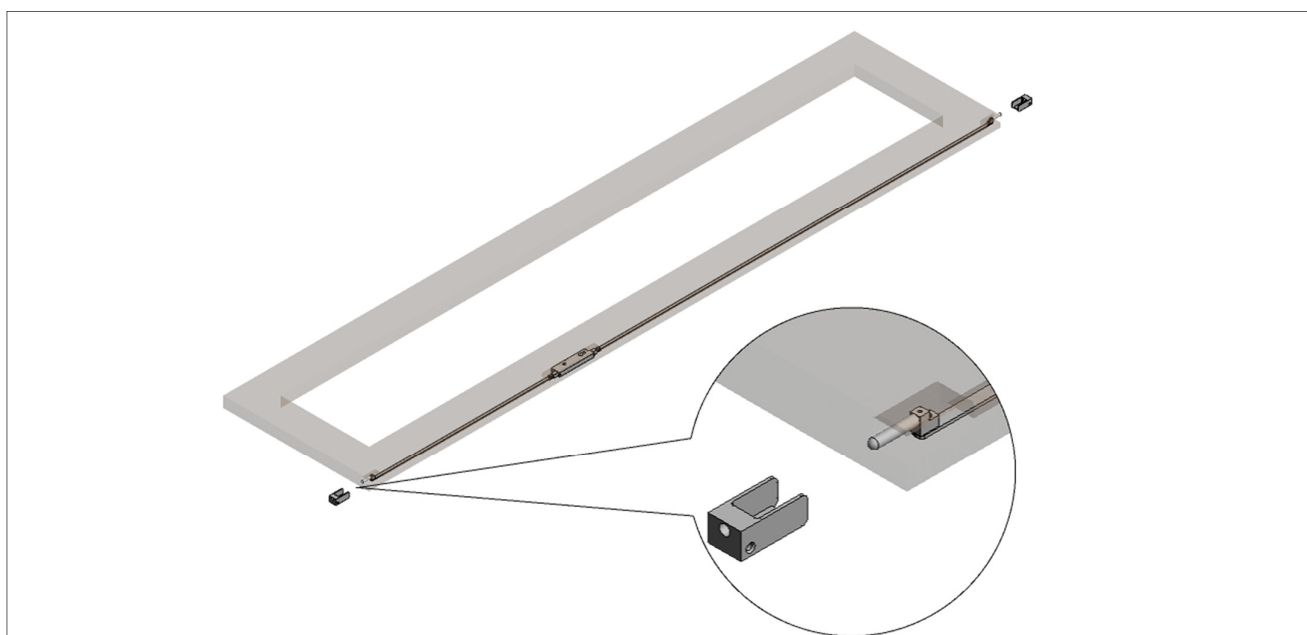

6. Secure blocks with screws

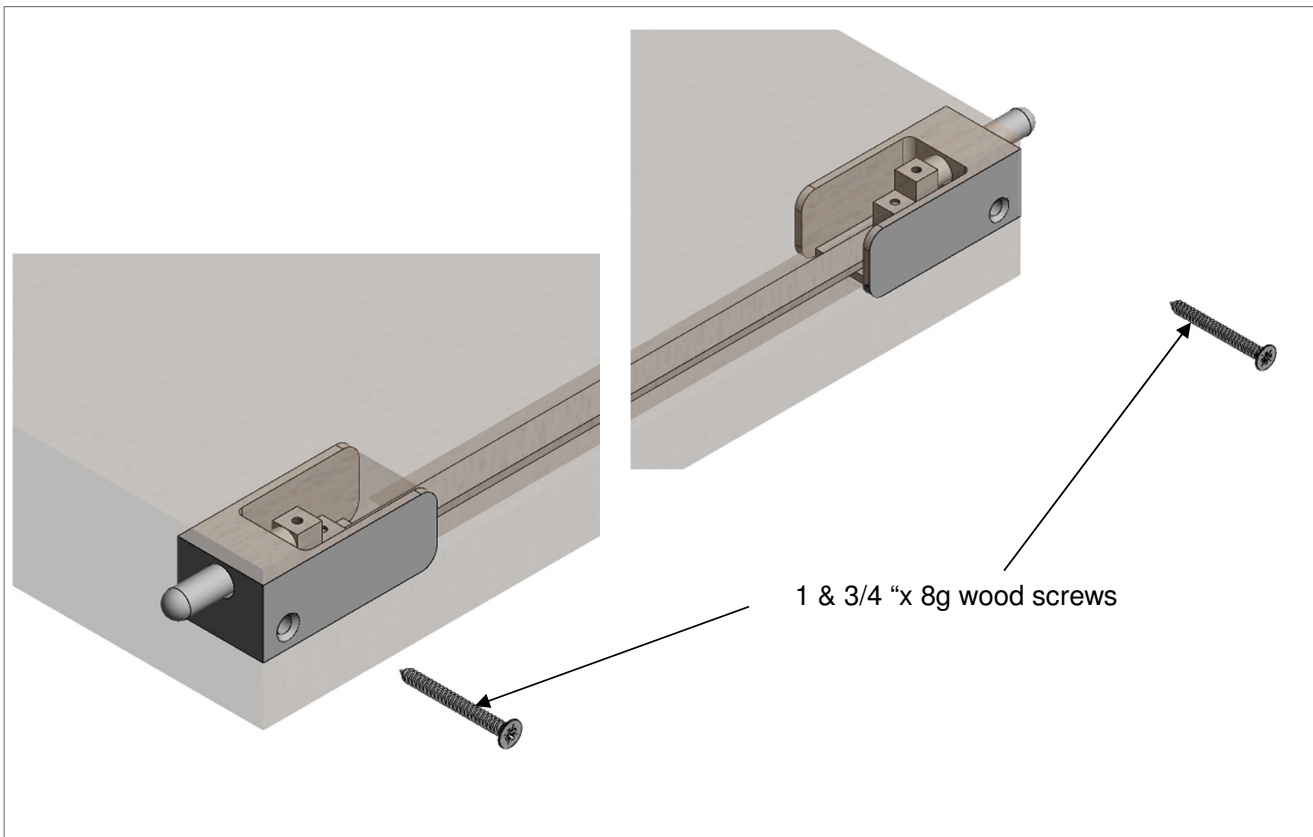

7. Attach cover plate

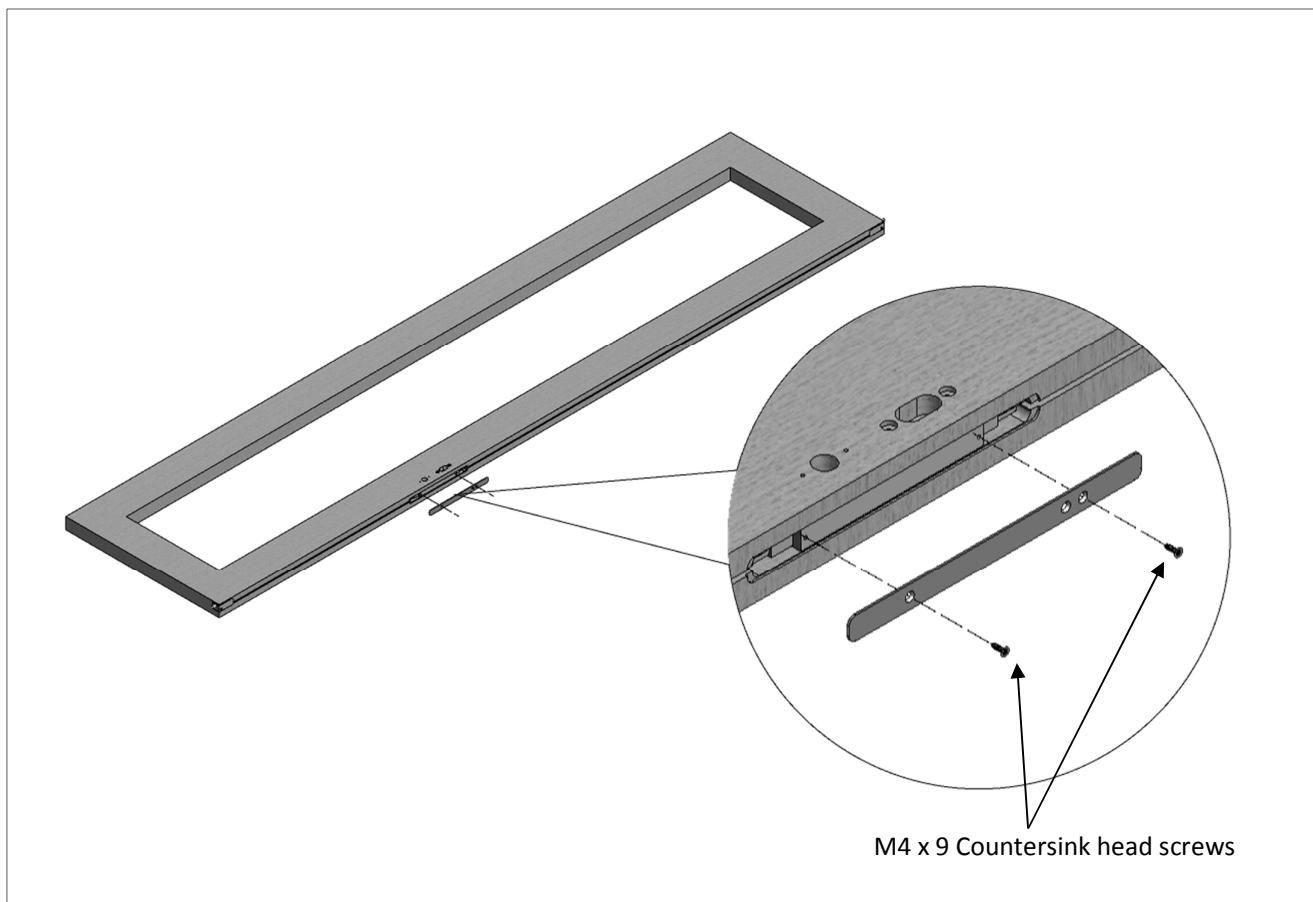

Finishing touches

Cut to length and insert coloured rubber seal into lock rod slot

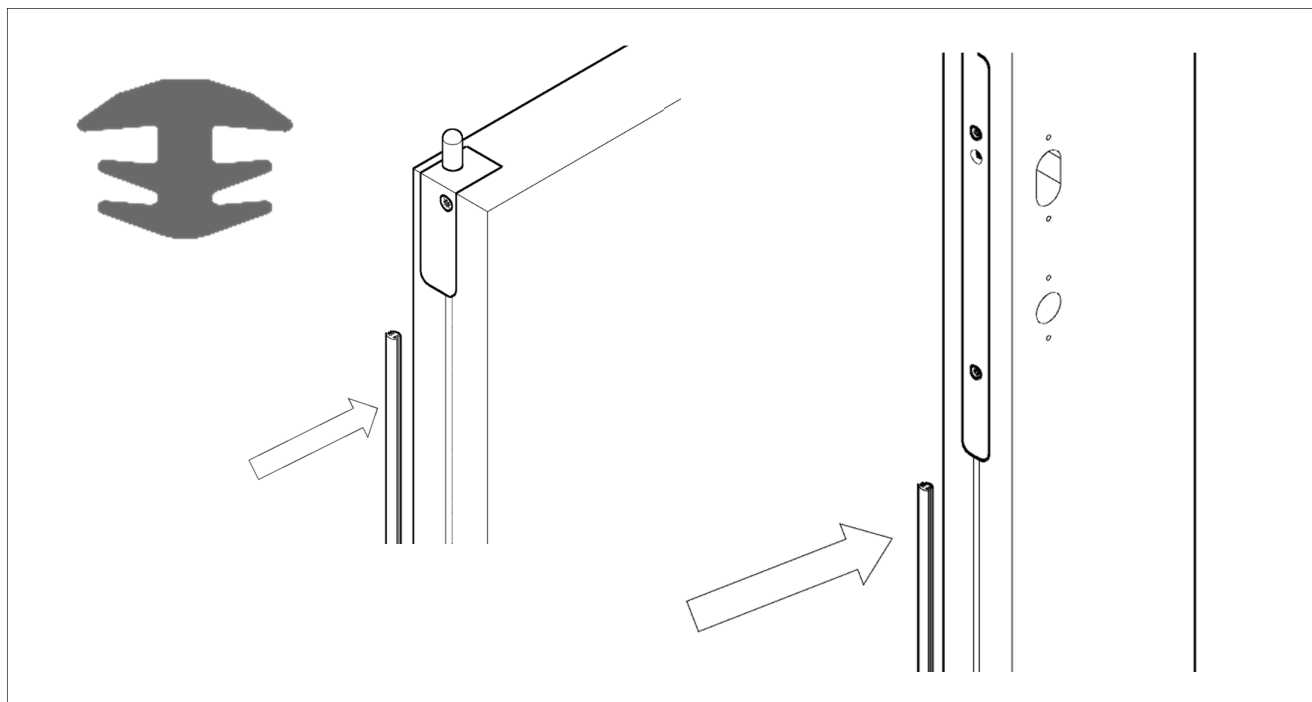

Fit handle and cylinder plate with suitable fixings

