

**FITTING INSTRUCTIONS – NOTICE DE POSE – MONTAGE HANDLEIDING –  
MONTAGEANLEITUNG ISTRUZIONI DI MONTAGGIO – INSTRUCCIONES DE MONTAJE**

**Warranty.** This product is covered by a 10 year manufacturer's warranty. Please see the P C Henderson website for terms and conditions

## WATCH THE INSTALLATION VIDEO

Visit: [www.pchenderson.com/imperial-installation](http://www.pchenderson.com/imperial-installation) or  
scan the QR code using your phone



### Specification

Maximum Door Height = 2400mm

Maximum Door Weight = 200kg

Maximum Door Thickness = 56mm

### Tools Required

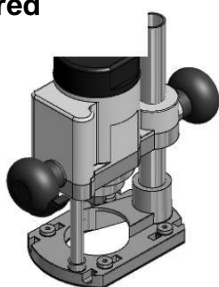

Router



Power  
Drill



Spirit Level



Tape Measure



Posi  
Screwdriver

### Kit Contents



1 x Lock Kit  
1 x Keep Plate  
(Not included in Slave Door Kit)



2 x Imperial 200kg  
Bottom roller



2 x 106SS/94  
Guide



1 x 915B Bronze  
Rail



2 x Floor  
Stop



2 x Interlocker  
2.4 Mtr

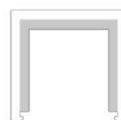

1 x 94P Polypropylene  
Channel

## Calculating Door and Opening Heights

### One Fixed and One Sliding Panel

#### Central Meeting Panels

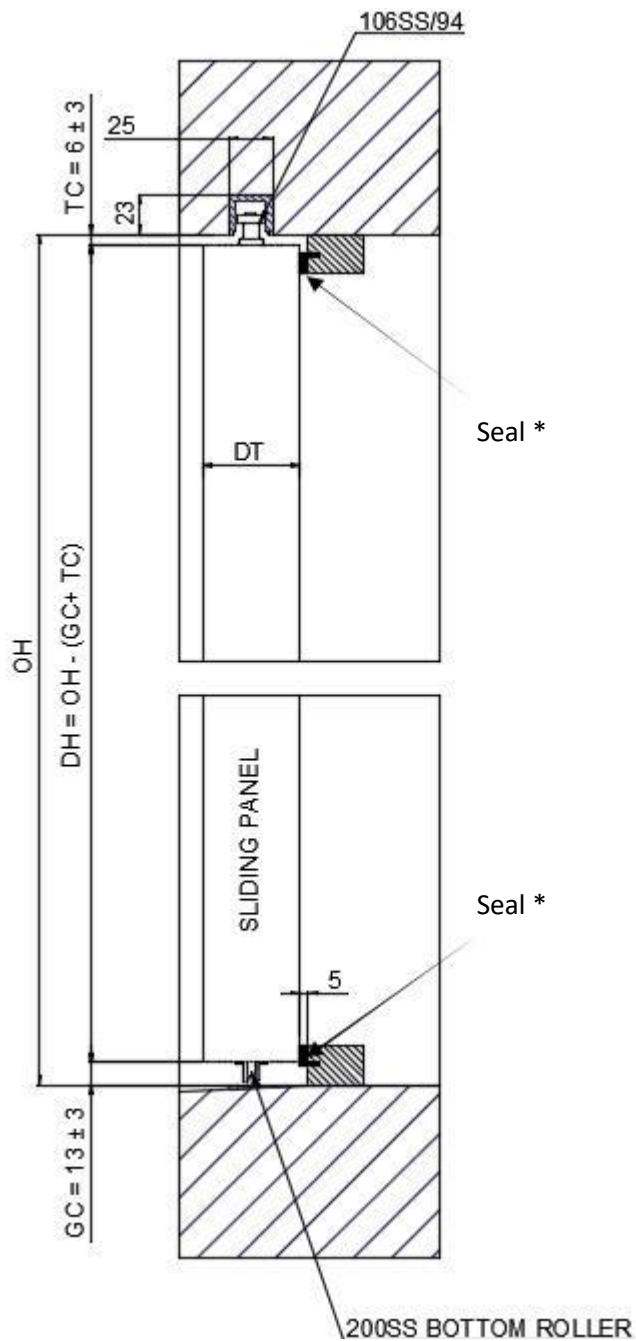

### One Fixed and Two Sliding Panels

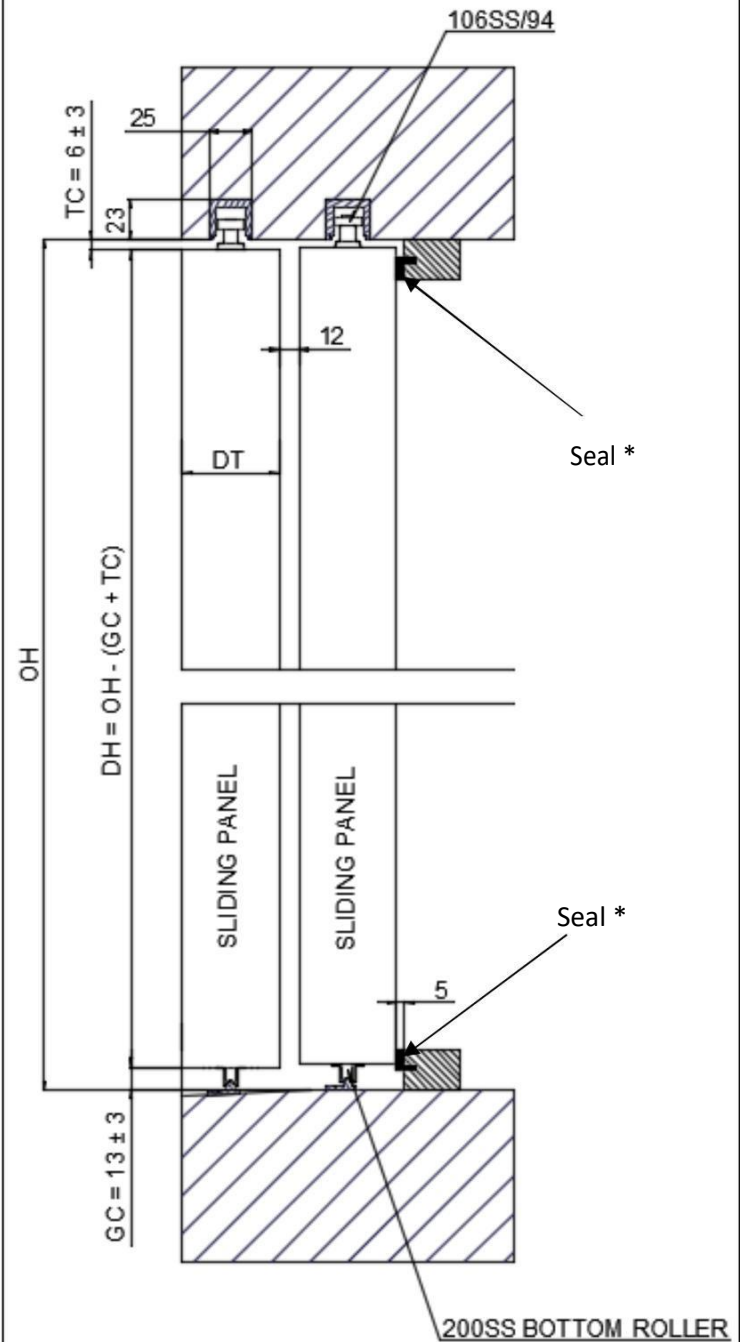

### KEY

DH = Door Height

OH = Opening Height

GC = Ground Clearance

TC = Top Clearance

\*= Not included in kit

PCH recommend a minimum door stile of 150mm

### One Fixed & One Sliding Panel Overview

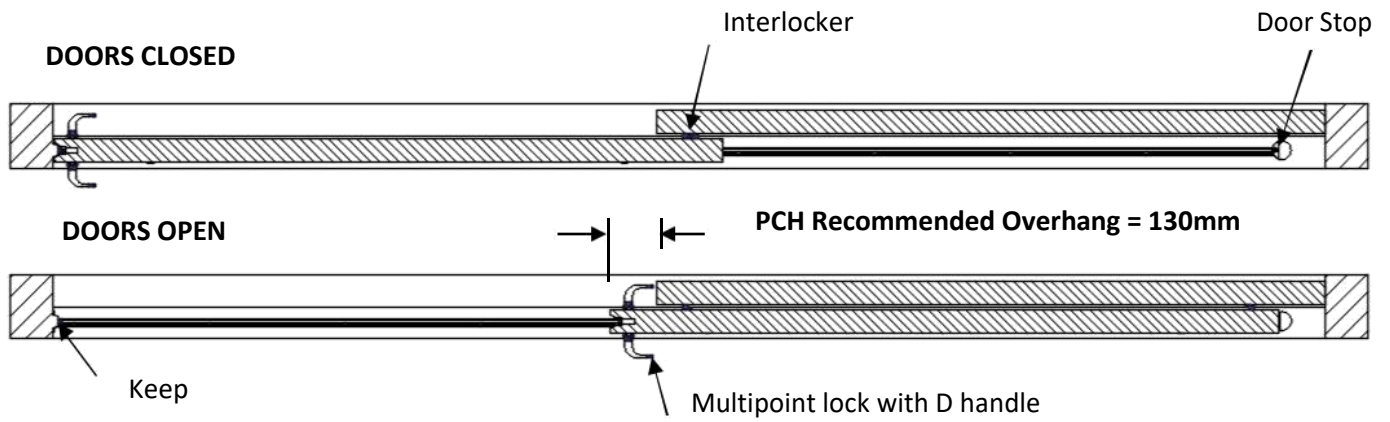

### One Fixed & Two Sliding Panel Overview

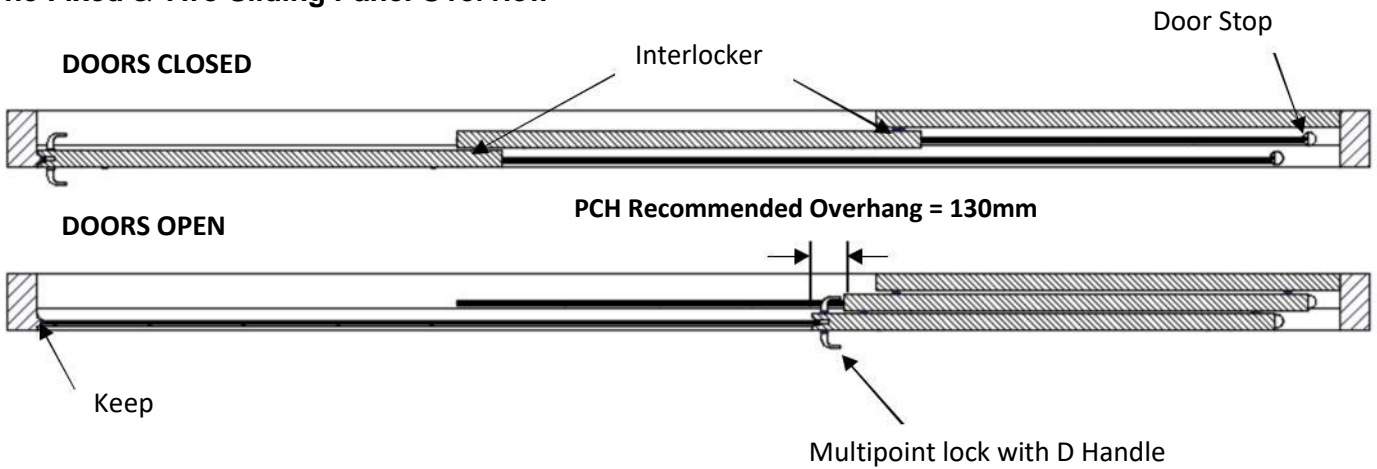

### Central Meeting Panel Overview

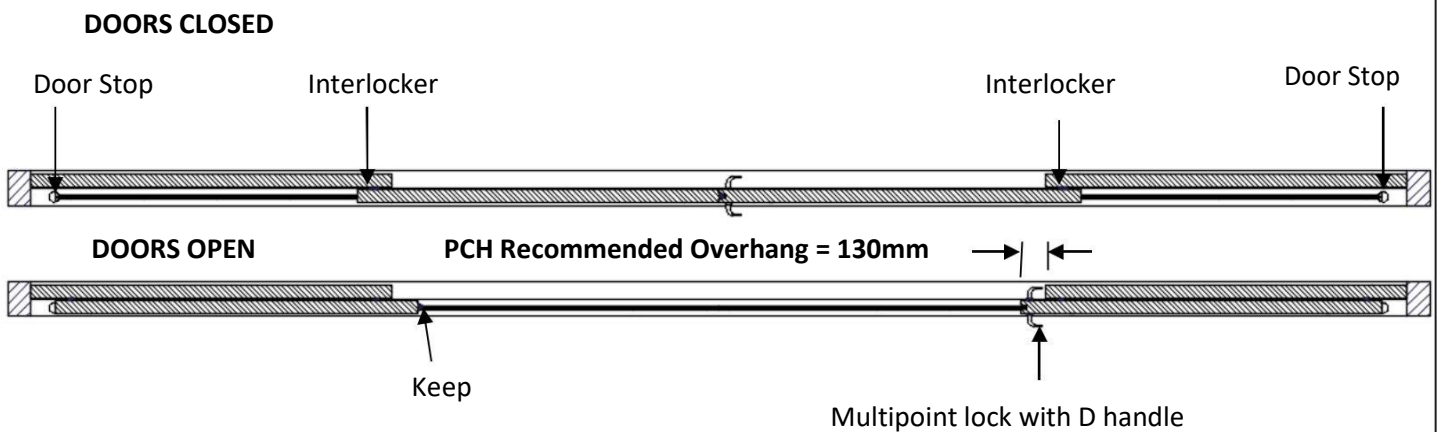

**Component Overview**

**Central Meeting Panels**

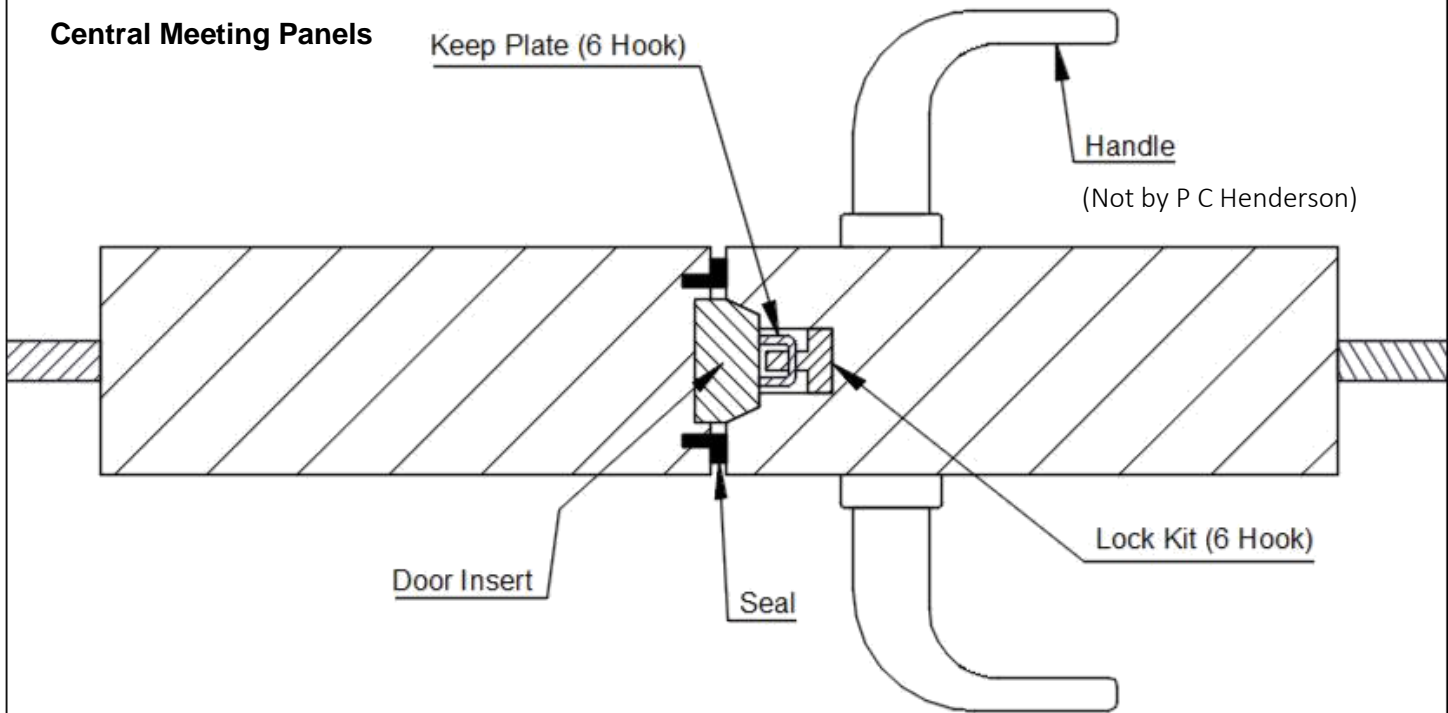

**Keep Plate (6 Hook)**

**Component Overview**

**Sliding Panels to One Side**

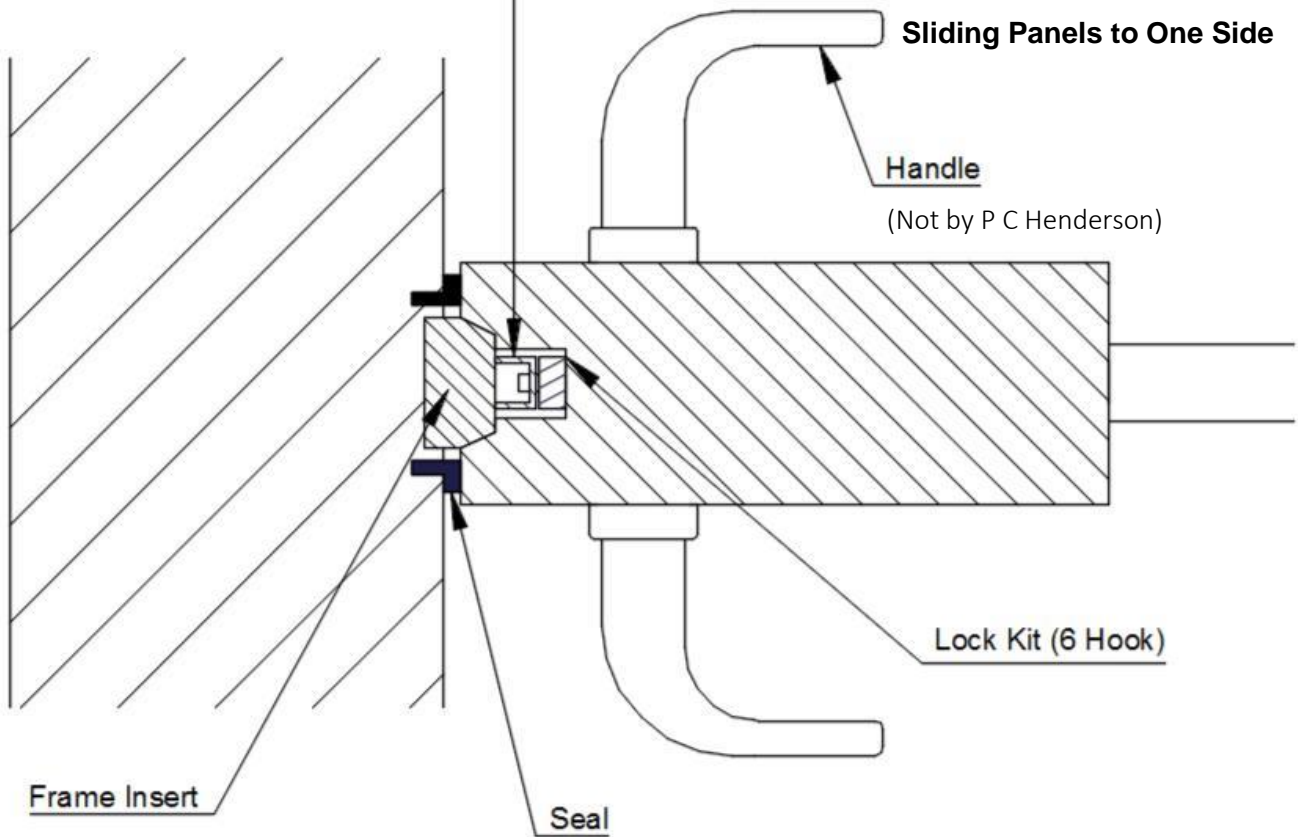

## 1. Routing detail for top guide

**NOTE:** Routing detail for all steps must be followed to the exact measurements provided. Failure to do so may effect the overall functionality and longevity of the product.

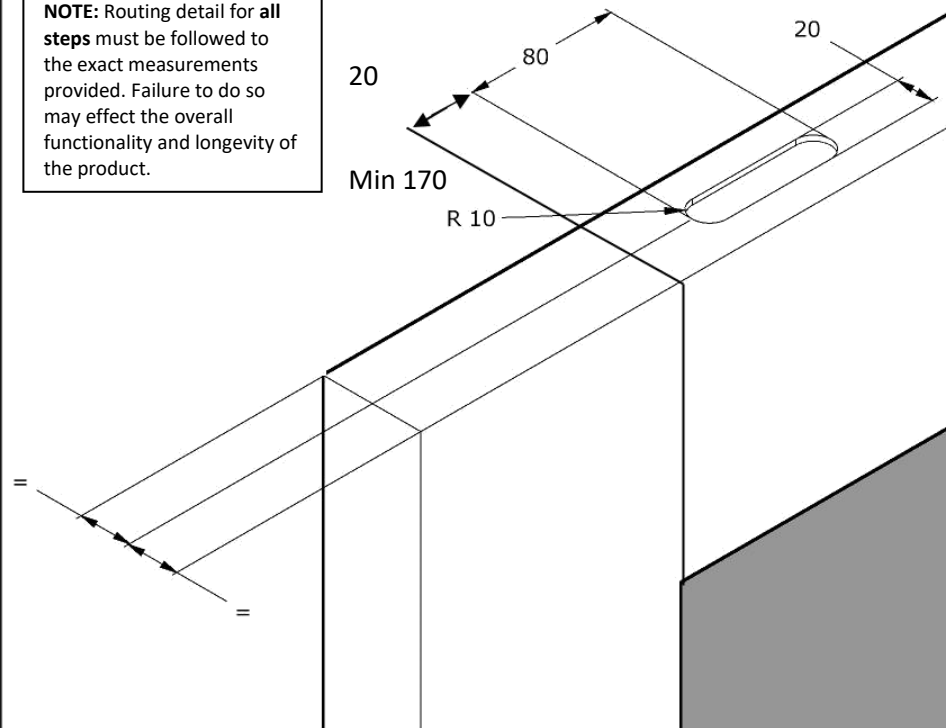

## 2. Attach Top Guides

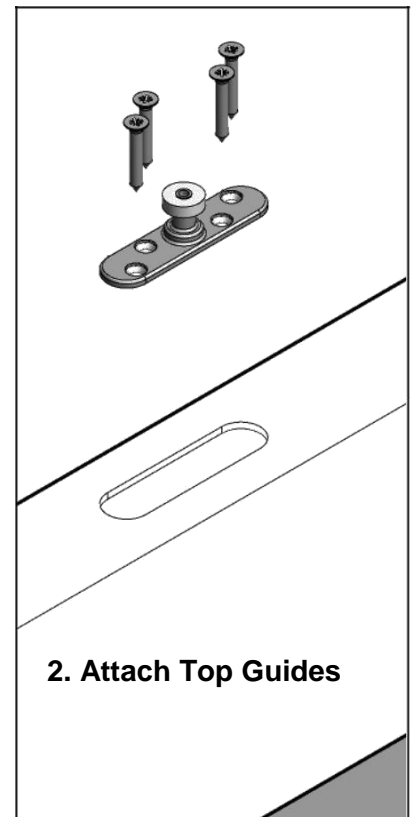

## 3. Routing detail for bottom roller

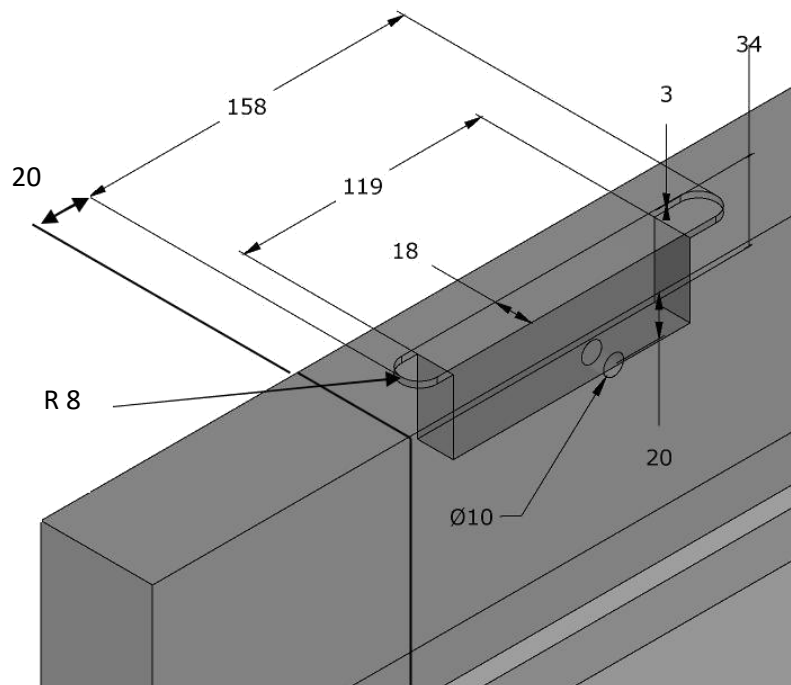

## 4. Attach Bottom Roller

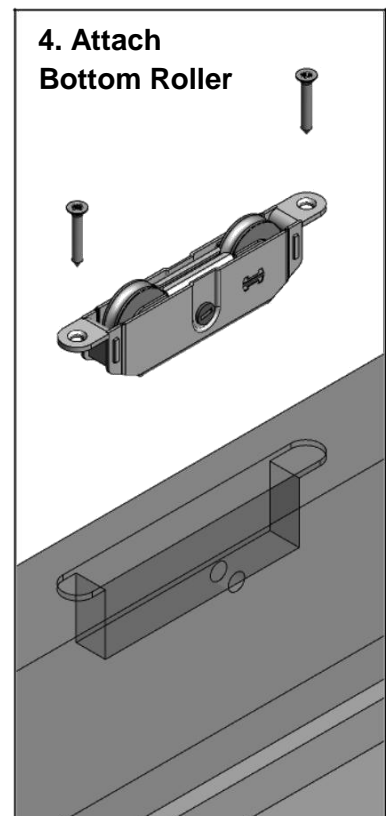

## 5. Locking bar routing detail (full height)

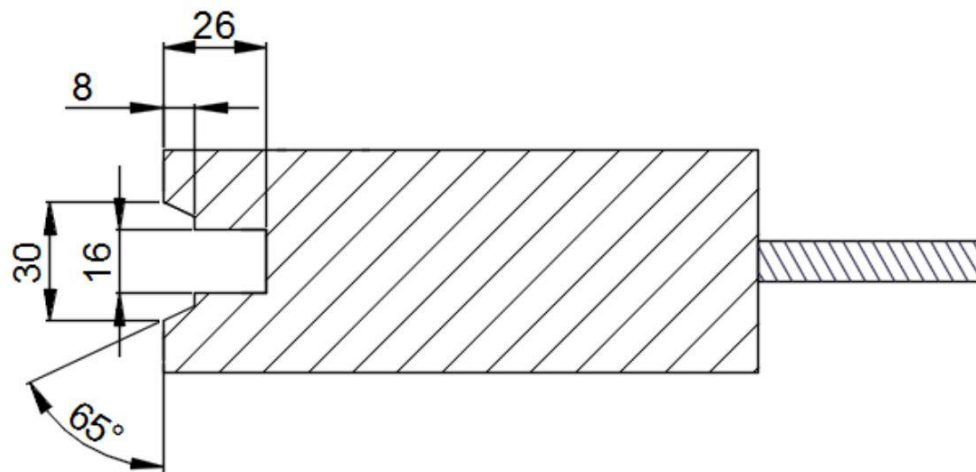

## 6. Locking bar routing detail

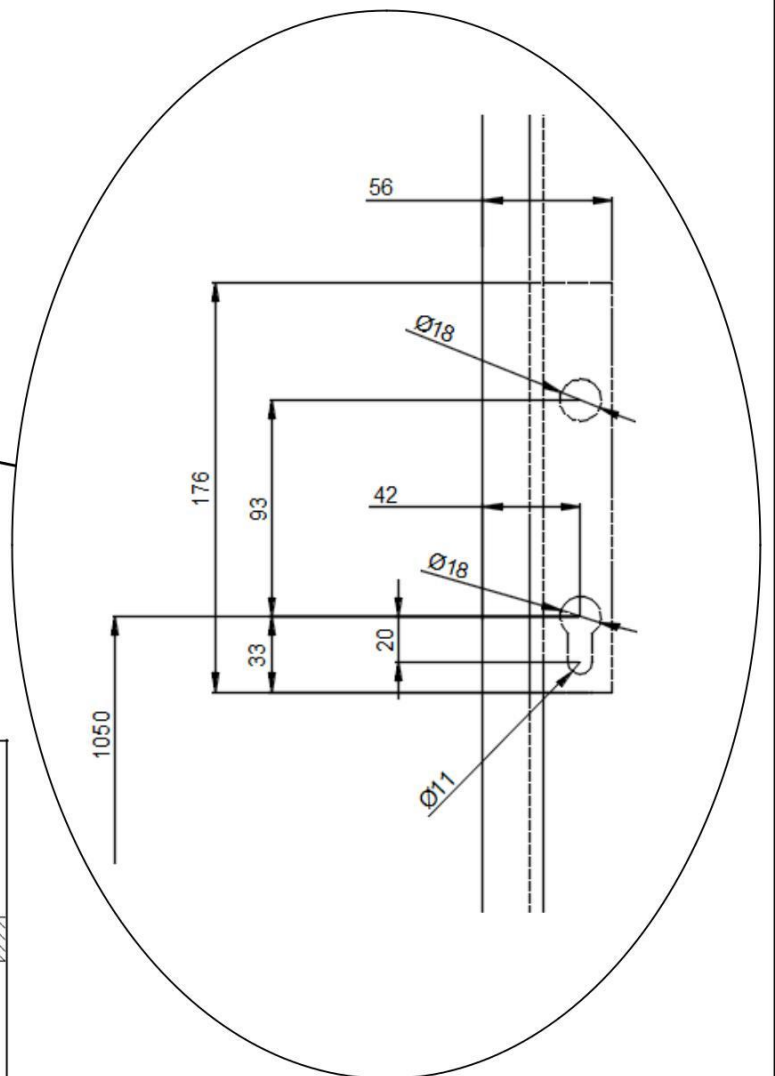
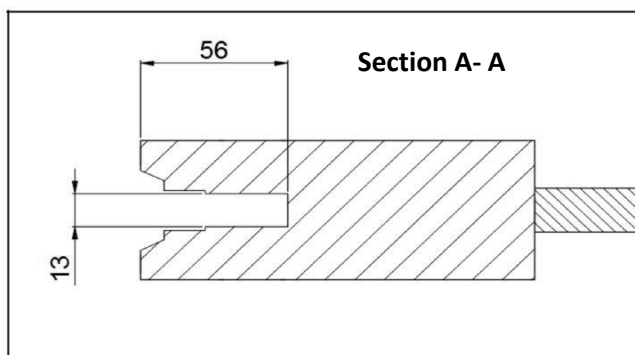
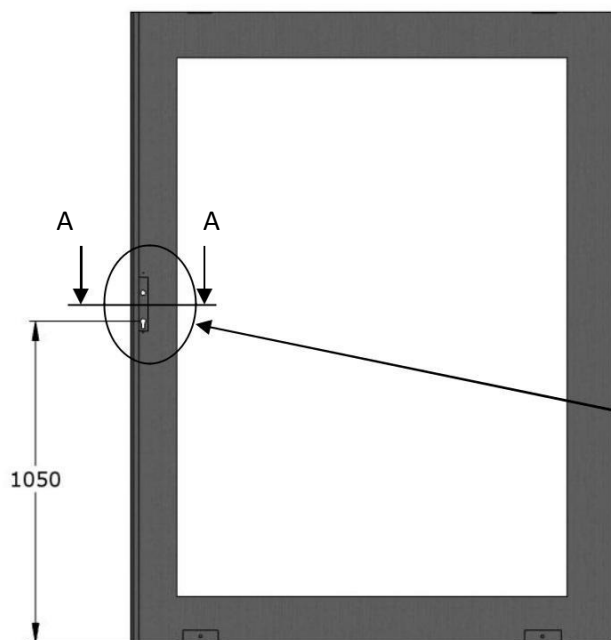

7. Locking bar & handle installation

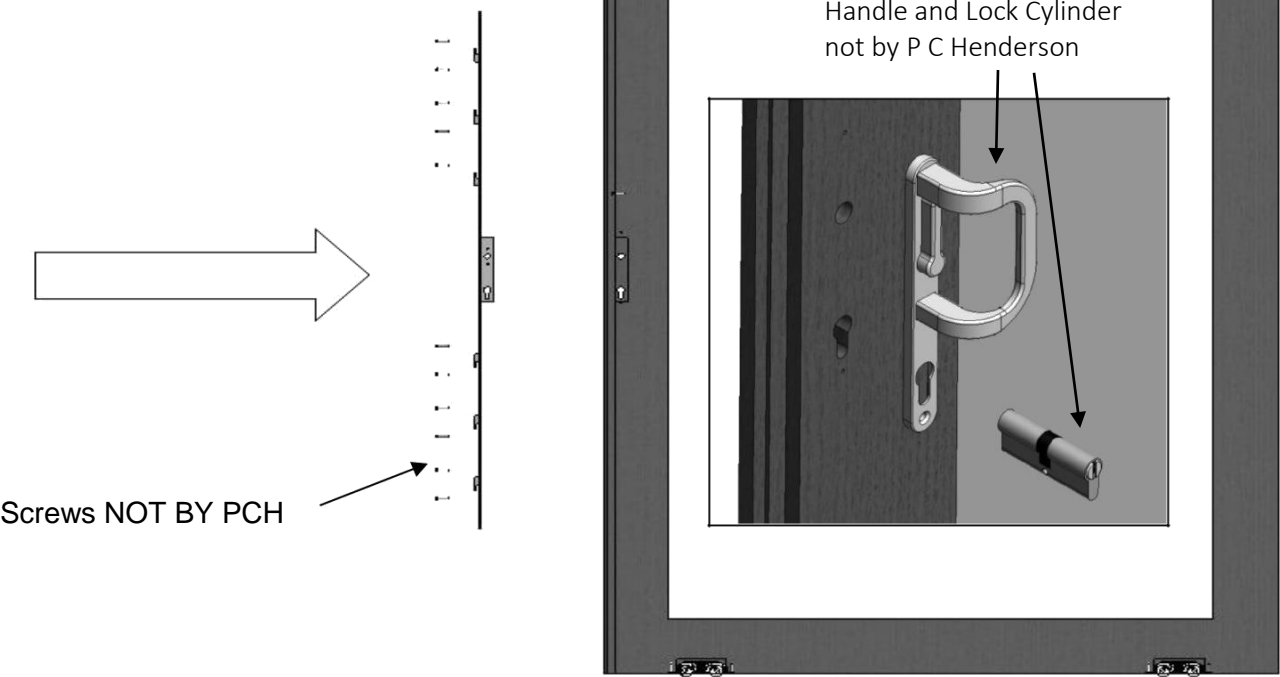

8. Keep location routing detail (full height)

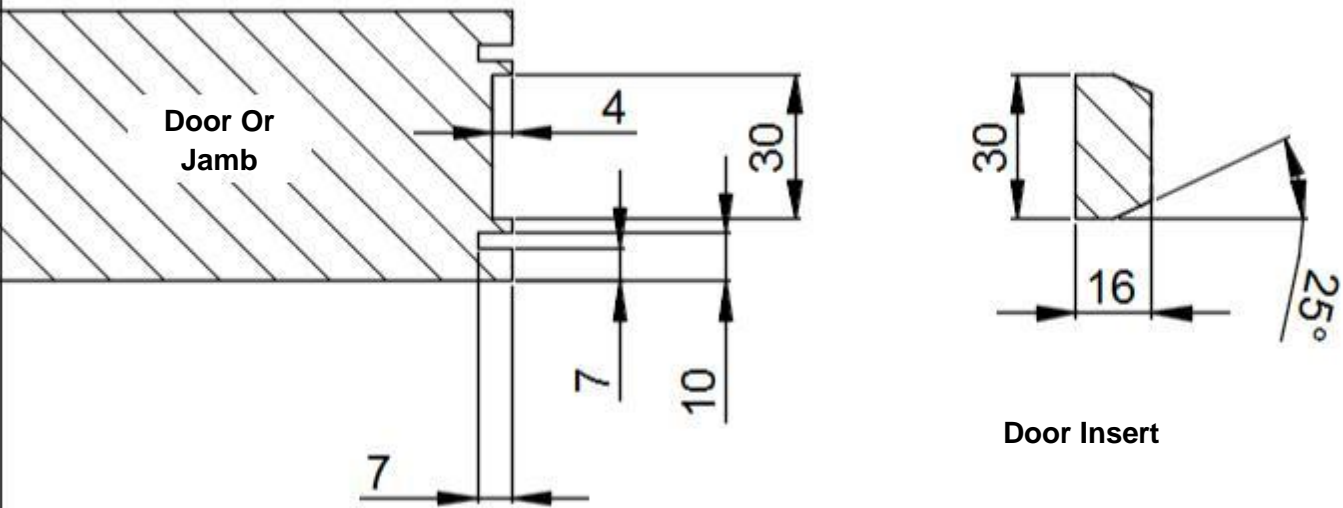



**9. Keep position & installation (on central meeting doors), for fixed panel installations attach keep to timber jamb**

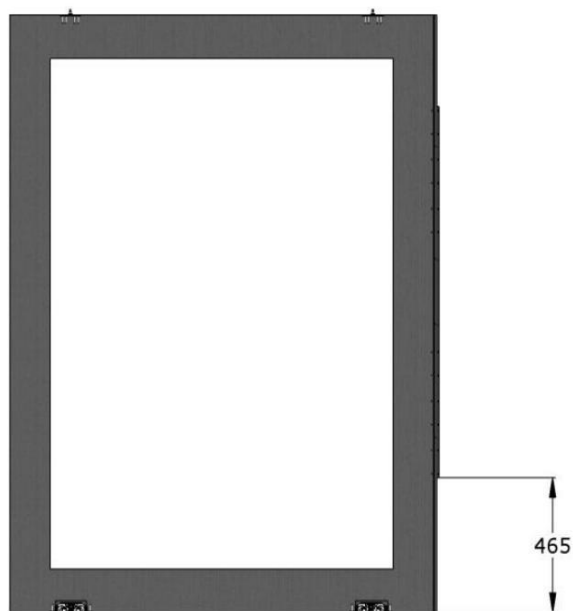

**Screws NOT PCH**

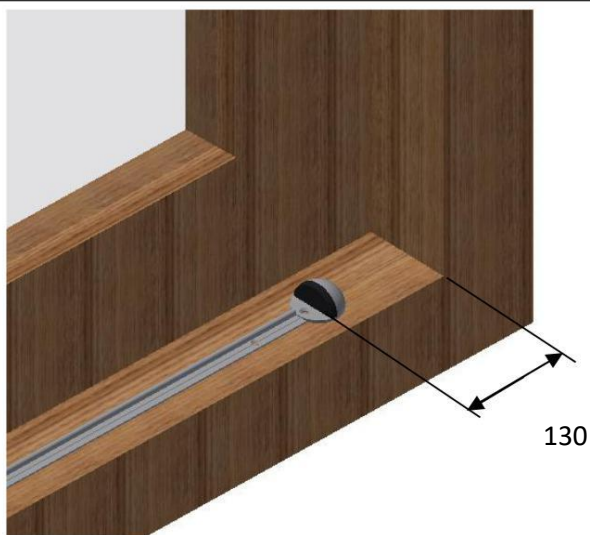
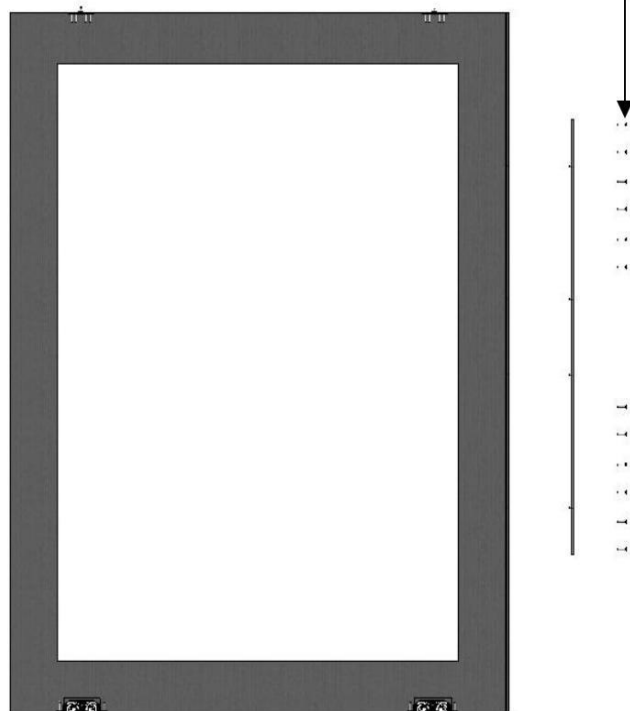

**10. For track and channel installation detail see Imperial 200SS Bottom Roller fitting instructions.**

**10a. Reduce rail and channel length by 130mm to locate door stops top and bottom (see overview)**

**11. Insert panels into frame**

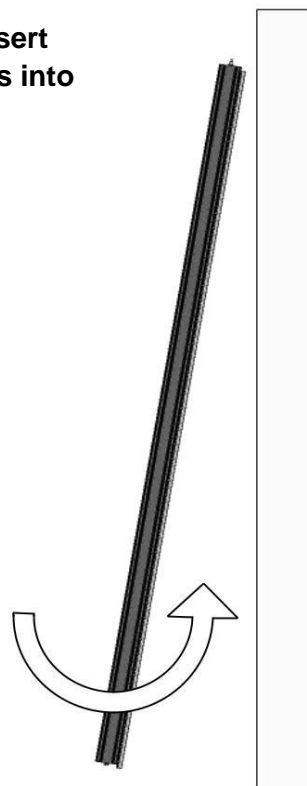



## 12. Plan view of interlocker position

overview between panels

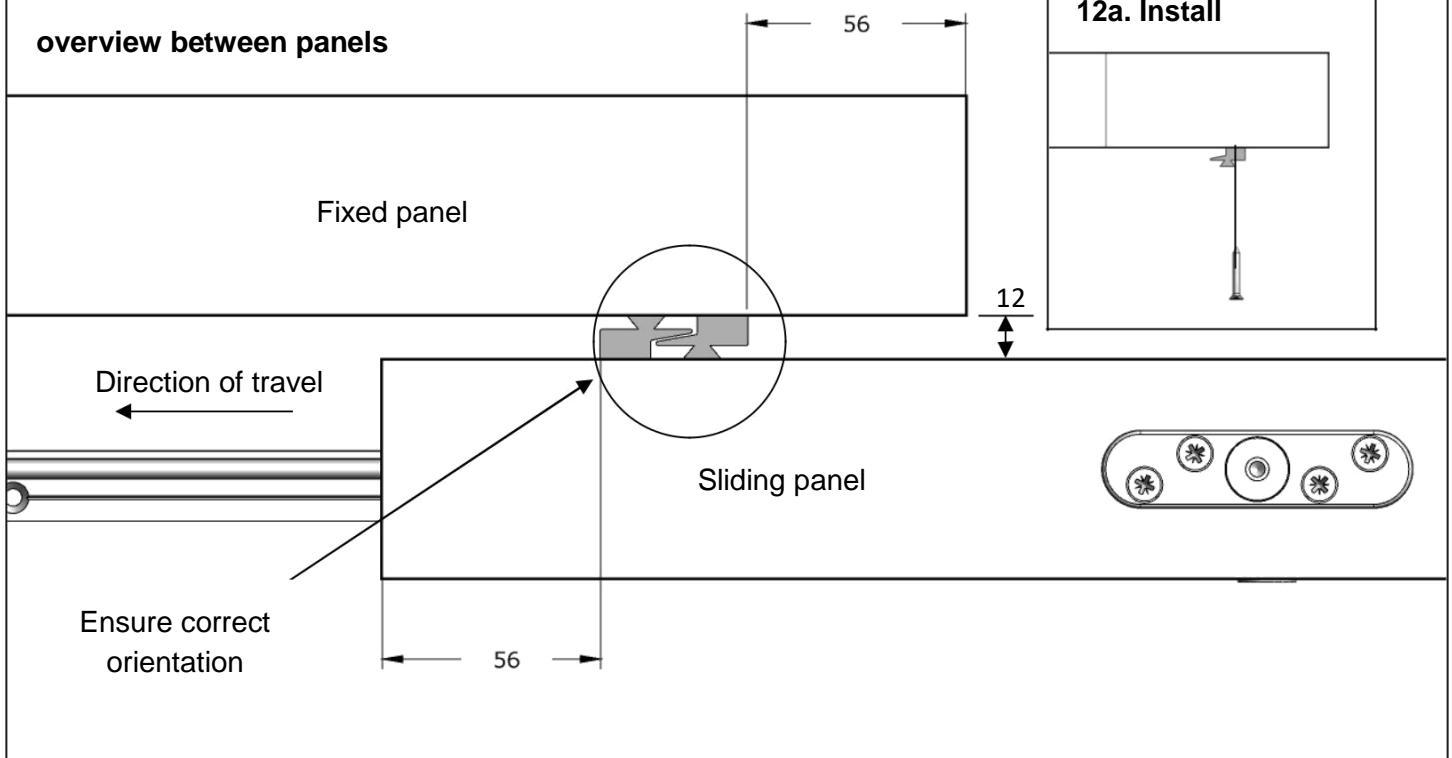

## 13. Door stop position overview

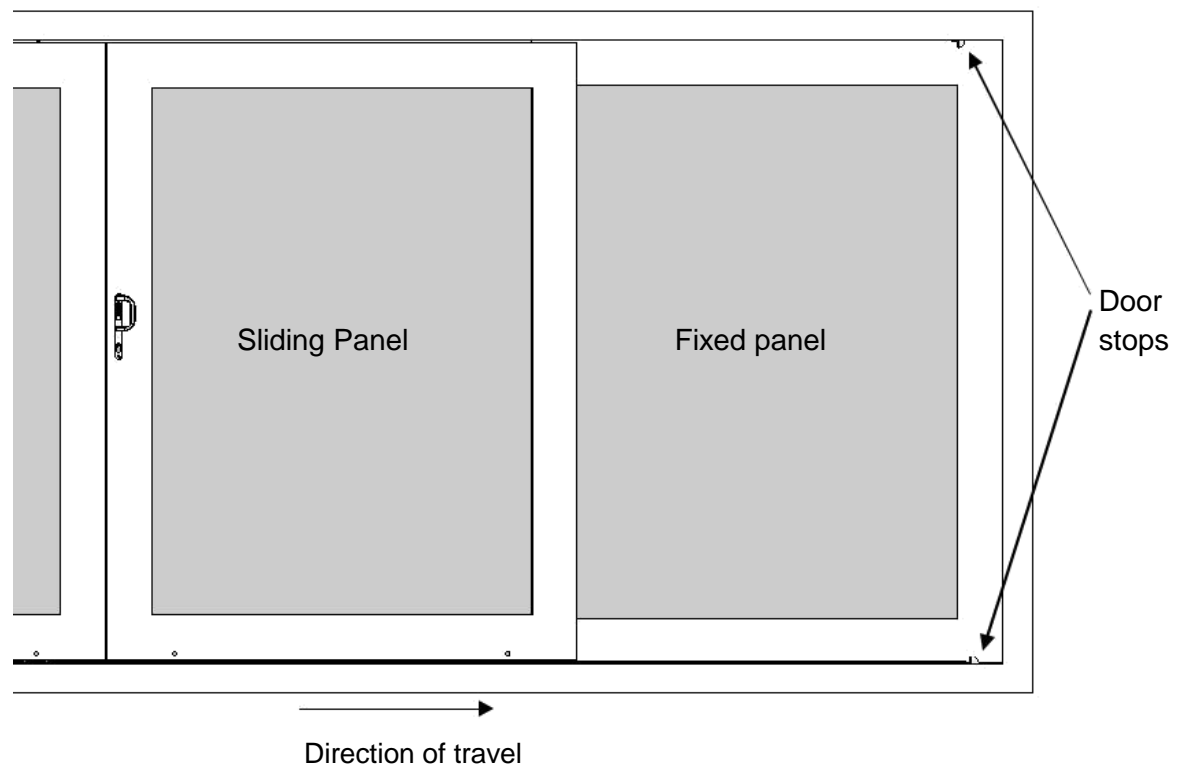

#### 14. Adjust door position to ensure correct running position

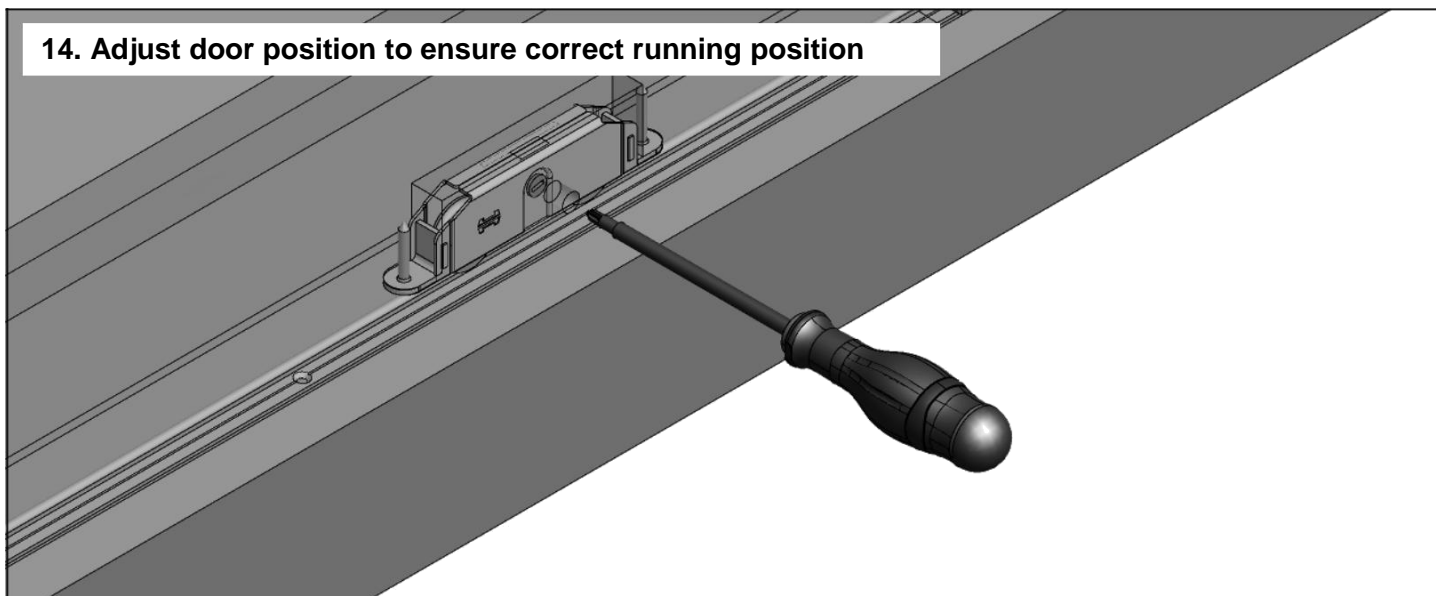

##### Bottom roller adjustment

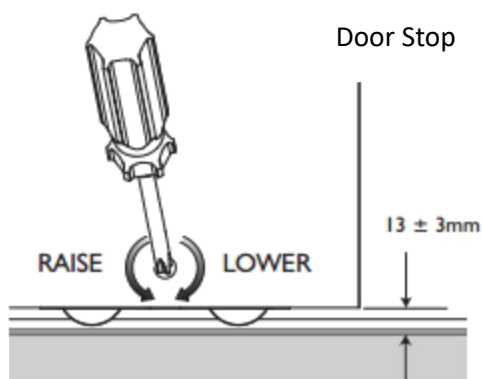

##### Locate plugs

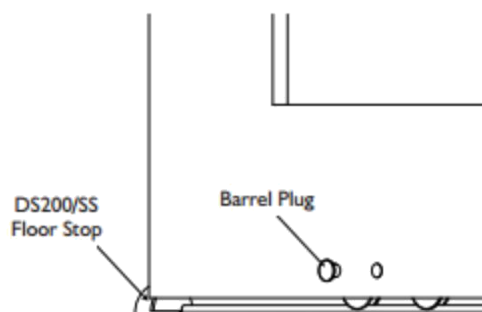

P C Henderson Ltd, Durham Road, Bowburn, Co. Durham, DH6 5NG, UK

##### UK Sales

t: +44 (0) 191 377 7345

e: [sales@pchenderson.com](mailto:sales@pchenderson.com)

w: [www.pchenderson.com](http://www.pchenderson.com)

##### Export Sales

t: +44 (0) 191 377 7346

e: [international@pchenderson.com](mailto:international@pchenderson.com)

w: [export.pchenderson.com](http://export.pchenderson.com)

UK Registered Address: P C Henderson Ltd, Durham Road, Bowburn, Co. Durham, DH6 5NG

Republic of Ireland Registered Address: P C Henderson Ltd, Westlink Industrial Estate, Kylemore Road, Dublin 10, Ireland

Holland Registered Address: Henderson Nederland BV, Rootven 14, 5531 MB, Bladel

600799  
LVL 11  
March 2020

