

POCKET DOOR PRO HENDERSON

FIRE RATED

120kg

Wood

Interior

Fire Rated

Fire rated pocket door hardware certified to FD30 and FD60 standards

Overview

Pocket Door Pro Fire Rated contains all the benefits of our regular Pocket Door kit as well as being a certified fire rated system to FD30 and FD60 standards. The kit contains intumescent seals and is made out of high quality FSC finger jointed Redwood.

The system is available in seven different kit sizes; 120mm or 125mm finished wall thickness; FD30 or FD60 standards and self closing or non self closing applications. Please consult your building inspector prior to purchase to determine if your application requires a self closer.

The kit should be specified in two parts (see below table) to combine the certified fire rated liner kit and the Pocket Door Pro hardware kit. The system has been tested by Warrington Fire as part of a 30 minute fire door assembly to BS476:Part 22:1987 and BSEN1634-1:2014+A1:2018 or a 60 minute fire door assembly to BS476:Part 22:1987. This system should be fitted with a solid core FD30 or FD60 timber based fire door.

Features and Benefits

- Fully certified to FD30 and FD60 standards
- Available as self closing or non self closing options
- Complete with intumescent seals
- Manufactured using FSC Finger Jointed Redwood
- Robust aluminium cavity frame
- Easy and rapid installation
- Seven different kit sizes (covering doors up to 2315mm x 930mm)
- Caters for 120mm or 125mm finished wall thickness (plus 12.5mm fireboard either side)



Fire Rated Liner Kit Specification

Kit Short Code	Fire Rating	Self Close	For Use With	Max. Door Thickness	Wall Thickness
LKFD30/**	FD30 (30 minutes)	Non Self Close	PDKPRO1-7	45mm	120mm* or 125mm*
LK10FD30/**			PDKPRO10		120mm* or 125mm*
SCLKFD30/**		Self Close (to be specified with PDKPROSOFT)	PROSOFT1-7		120mm* or 125mm*
SC10FD30/**			PROSOFT10		120mm* or 125mm*
LKFD60/125	FD60 (60 minutes)	Non Self Close	PDKPRO1-7	54mm	125mm*
LK10FD60/125			PDKPRO10		125mm*
SCLKFD60/125		Self Close (to be specified with PDKPROSOFT)	PROSOFT1-7		125mm*
SC10FD60/125			PROSOFT10		125mm*

*** For full short code please replace with required finished wall thickness - 120 or 125 (mm) * Plus 12.5mm additional fire rated board either side

*Note on Finished Wall Thickness

To ensure compliance with BS 476 Part 22 and BS EN 1634-1 - 12.5mm of additional fire rated board should be applied to either side when using a fire rated liner kit. This brings the final wall thickness to 145mm or 150mm. FD60 is only available for a 150mm finished wall thickness. See adjoining page for full calculation.

Product and Door Specification - must be specified in addition to Fire Rated Liner Kit

Kit Short Code		Max. Door Width	Max. Door Height	Max. Door Weight	Finished Wall Thickness
Standard	With Soft Close				
PDKPRO1/**	-	610mm	1981mm	120kg**	120mm* or 125mm*
PDKPRO2/**	PROSOFT2/**	686mm	1981mm	120kg**	120mm* or 125mm*
PDKPRO3/**	PROSOFT3/**	762mm	1981mm	120kg**	120mm* or 125mm*
PDKPRO4/**	PROSOFT4/**	838mm	1981mm	120kg**	120mm* or 125mm*
PDKPRO6/**	PROSOFT6/**	826mm	2040mm	120kg**	120mm* or 125mm*
PDKPRO7/**	PROSOFT7/**	726mm	2040mm	120kg**	120mm* or 125mm*
PDKPRO10/**	PROSOFT10/**	930mm	2315mm	120kg**	120mm* or 125mm*

*** For full short code please replace with required finished wall thickness - 120 or 125 (mm) * Plus 12.5mm additional fire rated board either side

** Maximum door weight when specifying as a soft close kit is 80kg

PLEASE NOTE: For non soft closing biparting doors, you will also need to purchase two HH4/AN track stops

Kit Contents (PDKPRO Kit)

Aluminium Track (x 1)	Fixing Plate (x4)	Floor Bracket (x2) (x4 for PDKPRO10)
Aluminium Upright (x4)	Header Fixing Bracket (x8)	Screws
Hangers (x2)	Door Stop (x1)	Tie Back c/w Fixing Block (x4) (PDKPRO10 only)
Floor Guide (x1)	Noggin c/w Fixing Block (x2) (x4 for PDKPRO10)	

Fire Rated Liner Kit



Handles & Flush Pulls*

Oval Flush Pull	Available in satin or black	144S and 144B	
Round Flush Pull Set	Available in satin, chrome, black and polished brass	385/S, 385/C, 385/B or 385/P	
Round Finger Pull	Available in satin, chrome, black and polished brass	380/S, 380/C, 380/B or 380/P	

*For more information please refer to the field of application report for specific fire rated installation guidelines.

Fire Rated Finished Wall Thickness Calculation

120mm Finished Wall Thickness

95mm cavity + 12.5mm fire rated board either side = 120mm
+ 12.5mm additional fire rated board either side = 145mm

125mm Finished Wall Thickness

100mm cavity + 12.5mm fire rated board either side = 125mm
+ 12.5mm additional fire rated board either side = 150mm

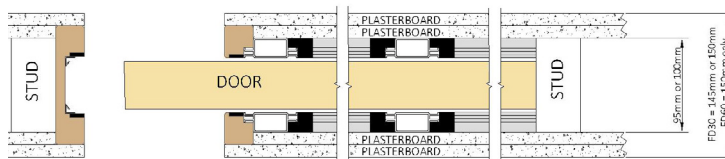

Note: To ensure compliance with BS 476 Part 22 and BS EN 1634-1 - 12.5mm - 12.5mm of extra fire rated board should be applied when using a fire rated liner kit. This brings the final wall thickness to 145mm or 150mm. FD60 is only available for a 150mm finished wall thickness. See fitting instructions for full details.

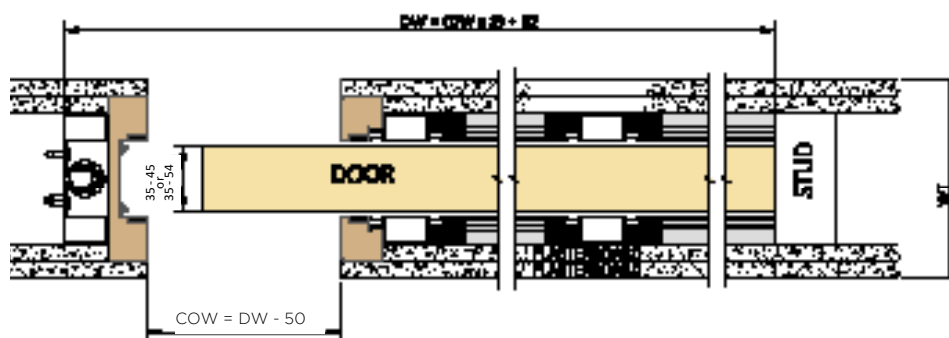
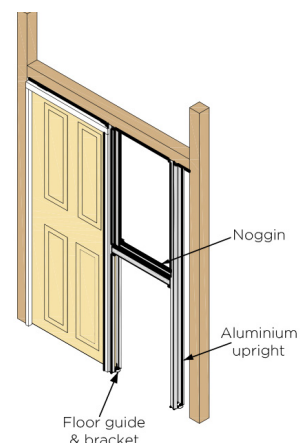
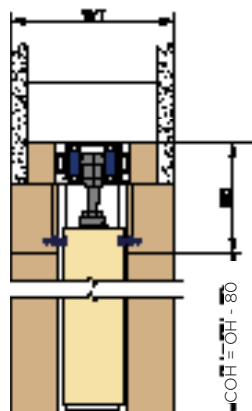
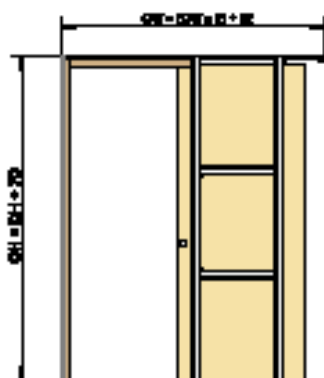
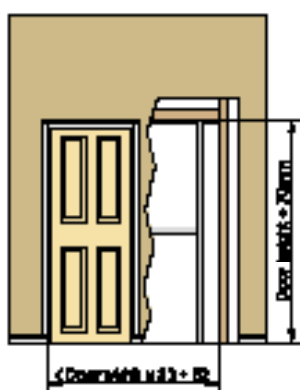

Key

OW	Overall width
OH	Overall height
DH	Door height
DW	Door width
COH	Clear opening height
COW	Clear opening width
FWT	Finished wall thickness

Opening Size Guide

Kit Short Code	Max. Passage Width (W x H)	Overall Dimensions (W x H)	Cavity Thickness	Finished Wall Thickness (WT)
PDKPRO1/**	560mm x 1971mm	1250mm x 2051mm	95mm or 100mm	120mm or 125mm
PDKPRO2/**	636mm x 1971mm	1402mm x 2051mm	95mm or 100mm	120mm or 125mm
PDKPRO3/**	712mm x 1971mm	1554mm x 2051mm	95mm or 100mm	120mm or 125mm
PDKPRO4/**	788mm x 1971mm	1706mm x 2051mm	95mm or 100mm	120mm or 125mm
PDKPRO6/**	776mm x 2030mm	1682mm x 2110mm	95mm or 100mm	120mm or 125mm
PDKPRO7/**	676mm x 2030mm	1482mm x 2110mm	95mm or 100mm	120mm or 125mm
PDKPRO10/**	880mm x 2305mm	1890mm x 2385mm	95mm or 100mm	120mm or 125mm

For further information, please contact us on:

UK Sales

T: +44 (0) 191 377 7345

E: sales@pchenderson.com

W: www.pchenderson.com

Export Sales

T: +44 (0) 191 377 7346

E: international@pchenderson.com

W: export.pchenderson.com